

6

5

4



3

2

1

F
E
D
C
B
A

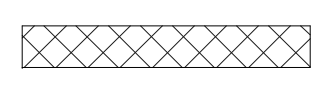
DETENTION SYMBOL LEGEND:

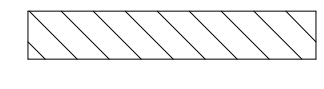
-  PRIMARY SECURITY: CONCRETE OR MASONRY WALL FULL HEIGHT TO STRUCTURE ABOVE. FULLY GROUTED CELLS WITH #4 REINFORCING BAR VERTICALLY EVERY 8", DOWELLED TO FLOOR SLAB. THIS SECURITY REINFORCING IS IN ADDITION TO ANY STRUCTURAL REQUIREMENTS.
-  SECONDARY SECURITY: CONCRETE OR MASONRY WALL TO STRUCTURE ABOVE. NOT FULLY GROUTED AND NO SECURITY REINFORCING NECESSARY.
-  CONCRETE OR MASONRY WALL. NOT FULLY GROUTED AND NO SECURITY REINFORCING NECESSARY.



Dewberry Architects Inc.
401 SW Water St.
Suite 701
Peoria, IL 61602
309.282.8000 Phone
309.282.8001 Fax



Pinellas County
**Upgrade Jail Campus Infrastructure
Phase I Design Criteria**
114400 North 49th Street
Clearwater, FL.

SEAL
**PRELIMINARY DOCUMENTS
NOT FOR CONSTRUCTION**

KEY PLAN
SCALE
As indicated

| No. | Description | Date |
|-----|-------------|------|
| | | |
| | | |
| | | |
| | | |
| | | |
| | | |
| | | |
| | | |
| | | |
| | | |

REVISIONS
DRAWN BY _____ CAC
APPROVED BY _____ JMP
CHECKED BY _____ CA
DATE 3/19/2014

TITLE
**SECOND FLOOR WALL TYPE -
DETENTION -
INFAS BLDG**
PROJECT NO. 50057109

QD-102
SHEET NO.



1 SECOND FLOOR - DETENTION
Scale: 1/8" = 1'-0"

6

5

4

3

2

1

F

E



D

C

B

A

DETENTION SYMBOL LEGEND:

-  PRIMARY SECURITY: CONCRETE OR MASONRY WALL FULL HEIGHT TO STRUCTURE ABOVE. FULLY GROUTED CELLS WITH #4 REINFORCING BAR VERTICALLY EVERY 8", DOWELLED TO FLOOR SLAB. THIS SECURITY REINFORCING IS IN ADDITION TO ANY STRUCTURAL REQUIREMENTS.
-  SECONDARY SECURITY: CONCRETE OR MASONRY WALL TO STRUCTURE ABOVE. NOT FULLY GROUTED AND NO SECURITY REINFORCING NECESSARY.
-  CONCRETE OR MASONRY WALL. NOT FULLY GROUTED AND NO SECURITY REINFORCING NECESSARY.



Dewberry Architects Inc.
401 SW Water St.
Suite 701
Peoria, IL 61602
309.282.8000 Phone
309.282.8001 Fax



Pinellas County
Upgrade Jail Campus Infrastructure
Phase I Design Criteria
114400 North 49th Street
Clearwater, FL.

SEAL

PRELIMINARY DOCUMENTS
NOT FOR CONSTRUCTION

KEY PLAN

SCALE

As indicated

| No. | Description | Date |
|-----|-------------|------|
| | | |
| | | |
| | | |
| | | |
| | | |
| | | |
| | | |
| | | |
| | | |
| | | |

REVISIONS

DRAWN BY _____ CAC
 APPROVED BY _____ JMP
 CHECKED BY _____ CA
 DATE _____ 3/19/2014

TITLE

THIRD FLOOR
WALL TYPE -
DETENTION -
INFAS BLDG

PROJECT NO. 50057109

QD-103

SHEET NO.

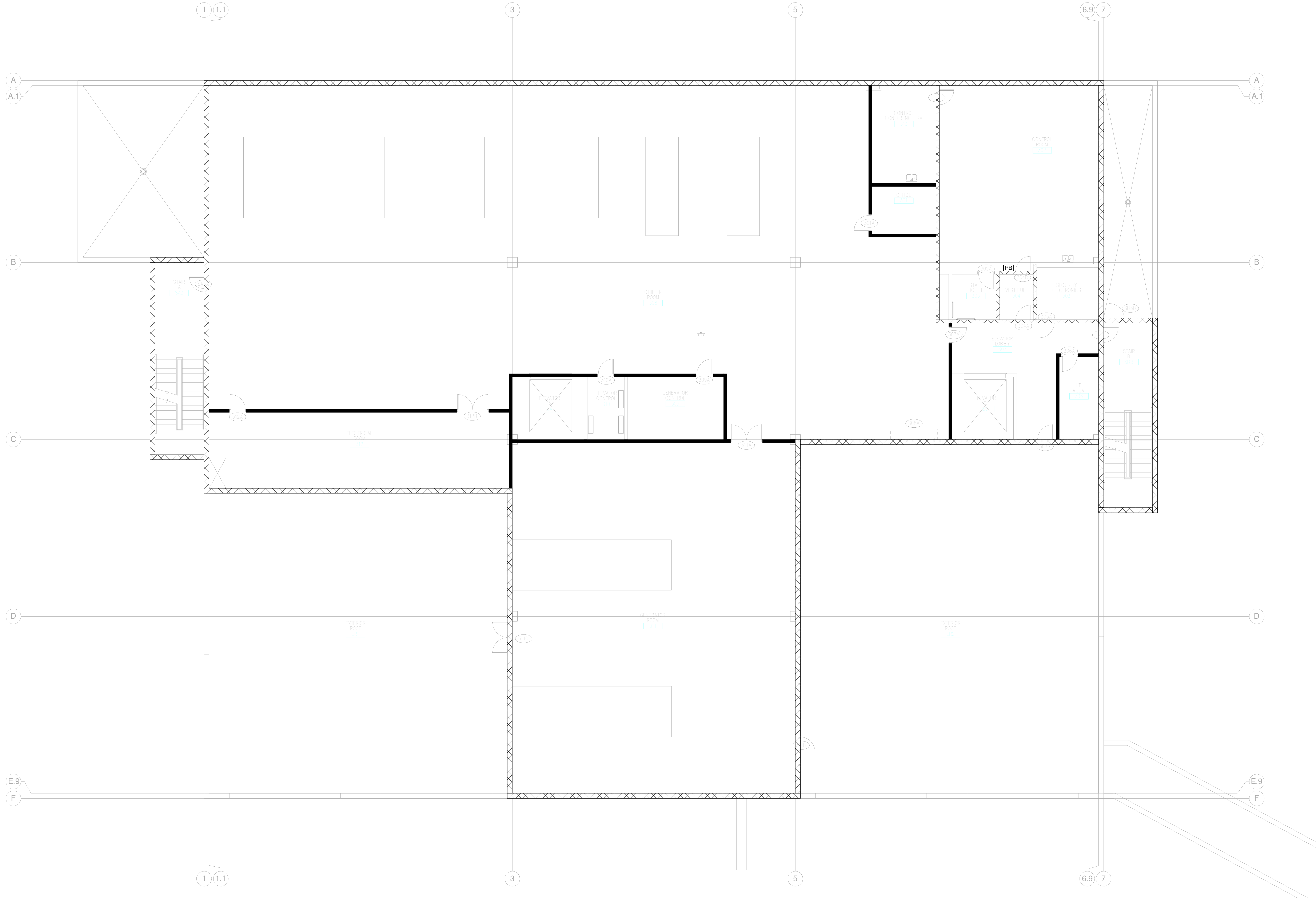

1 THIRD FLOOR - DETENTION
Scale: 1/8" = 1'-0"

6

5

4

3

2

1

F

E

D

C

B

A

DETENTION SYMBOL LEGEND:

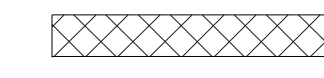

PRIMARY SECURITY: CONCRETE OR MASONRY WALL FULL HEIGHT TO STRUCTURE ABOVE. FULLY GROUTED CELLS WITH #4 REINFORCING BAR VERTICALLY EVERY 8". DOWELLED TO FLOOR SLAB. THIS SECURITY REINFORCING IS IN ADDITION TO ANY STRUCTURAL REQUIREMENTS.



SECONDARY SECURITY: CONCRETE OR MASONRY WALL TO STRUCTURE ABOVE. NOT FULLY GROUTED AND NO SECURITY REINFORCING NECESSARY.

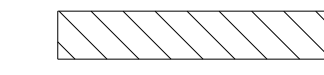

CONCRETE OR MASONRY WALL. NOT FULLY GROUTED AND NO SECURITY REINFORCING NECESSARY.

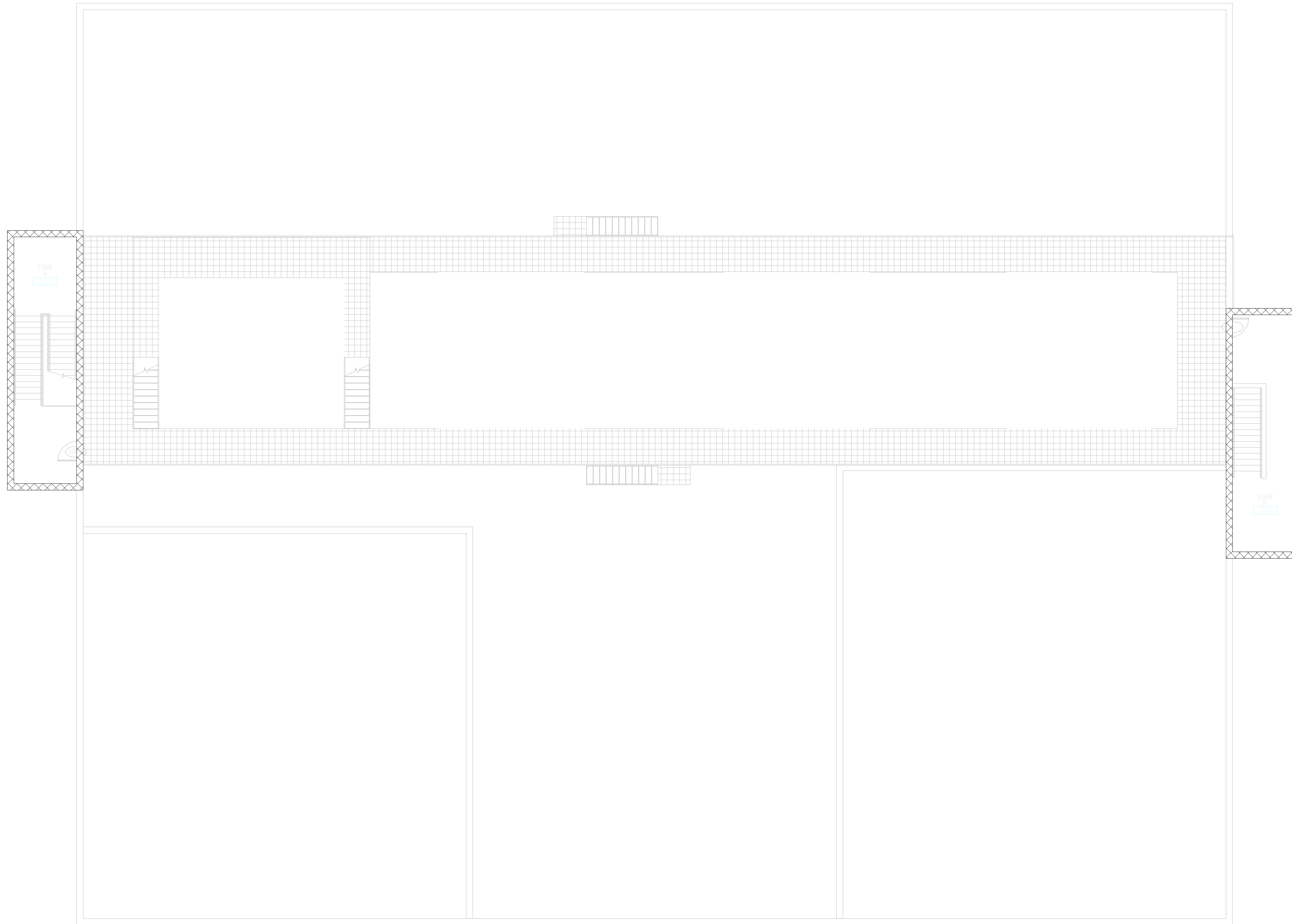

Dewberry Architects Inc.
401 SW Water St.
Suite 701
Peoria, IL 61602
309.282.8000 Phone
309.282.8001 Fax



Pinellas County
**Upgrade Jail Campus Infrastructure
Phase I Design Criteria**
114400 North 49th Street
Clearwater, FL.

SEAL

PRELIMINARY DOCUMENTS
NOT FOR CONSTRUCTION

KEY PLAN

SCALE

As indicated

| No. | Description | Date |
|-----|-------------|------|
| | | |
| | | |
| | | |
| | | |
| | | |
| | | |
| | | |
| | | |
| | | |
| | | |

REVISIONS

DRAWN BY _____ CAC
APPROVED BY _____ JMP
CHECKED BY _____ CA
DATE _____ 3/19/2014

TITLE

**CATWALK WALL
TYPE -
DETENTION -
INFAS BLDG**

PROJECT NO. 50057109

QD-104

SHEET NO.

1 CATWALK - DETENTION
Scale: 1/8" = 1'-0"

F

E

D

C

B

A

| DOOR SCHEDULE - CENTRAL ENERGY PLANT - FIRST FLOOR | | | | | | | | | | | |
|--|-----------|-----------|--------|-------|----------|------------|----------|-----------|-------------------|---------|----------------------------------|
| DOOR NUMBER | DOOR TYPE | DOOR SIZE | | | MATERIAL | FRAME | | LOCK TYPE | FIRE RATING LABEL | GLAZING | REMARKS |
| | | WIDTH | HEIGHT | THICK | | FRAME TYPE | MATERIAL | | | | |
| | | S41A | C | 3'-0" | | 7'-0" | 2" | | | | |
| S41B | C | 3'-0" | 7'-0" | 2" | DHM | 2 | DHM | 300-S | 45 MIN | SG-2F | |
| S81A | C | 3'-0" | 7'-0" | 2" | DHM | 2 | DHM | 300-S | 45 MIN | SG-2F | |
| S81B | C | 3'-0" | 7'-0" | 2" | DHM | 2 | DHM | 300-S | 45 MIN | SG-2F | |
| 101A | (2)A | (2) 3'-0" | 7'-0" | 2" | DHM | 2 | DHM | 380-A | | | |
| 105A | D | 5'-0" | 7'-0" | 2" | DHM | 3 | DHM | 316S | | | DOOR SIZE GIVEN IS CLEAR OPENING |
| 105B | D | 5'-0" | 7'-0" | 2" | DHM | 3 | DHM | 316A | | | DOOR SIZE GIVEN IS CLEAR OPENING |
| 106A | C | 4'-0" | 7'-0" | 2" | DHM | 1 | DHM | 120-S | 45 MIN | SG-2F | |
| 106B | C | 3'-0" | 7'-0" | 2" | DHM | 1 | DHM | 120-S | 45 MIN | SG-2F | |
| 110A | C | 3'-0" | 7'-0" | 2" | DHM | 1 | DHM | 120-S | | | |
| 116B | C | 3'-0" | 7'-0" | 2" | DHM | 1 | DHM | 120-S | | | |
| 122B | C | 3'-0" | 7'-0" | 2" | DHM | 1 | DHM | 120-S | | | |
| 134B | A | 4'-0" | 7'-0" | 2" | DSS | 1 | DSS | 120-S | | | |
| 137A | B | 3'-0" | 7'-0" | 2" | DHM | 1 | DHM | 120-S | | | |
| 137B | B | 3'-0" | 7'-0" | 2" | DHM | 1 | DHM | 120-S | 45 MIN | SG-2F | |
| 140A | A | 3'-0" | 7'-0" | 2" | DHM | 2 | DHM | 500 | 45 MIN | | |
| 141A | D | 5'-0" | 7'-0" | 2" | DHM | 3 | DHM | 316S | | | DOOR SIZE GIVEN IS CLEAR OPENING |

| DOOR SCHEDULE - CENTRAL ENERGY PLANT - SECOND FLOOR | | | | | | | | | | | |
|---|-----------|-----------|--------|-------|----------|------------|----------|-----------|-------------------|---------|----------------------------------|
| DOOR NUMBER | DOOR TYPE | DOOR SIZE | | | MATERIAL | FRAME | | LOCK TYPE | FIRE RATING LABEL | GLAZING | REMARKS |
| | | WIDTH | HEIGHT | THICK | | FRAME TYPE | MATERIAL | | | | |
| | | S42A | C | 3'-0" | | 7'-0" | 2" | | | | |
| S82A | C | 3'-0" | 7'-0" | 2" | DHM | 2 | DHM | 300-S | 45 MIN | SG-2F | |
| 214A | B | 3'-0" | 7'-0" | 2" | DHM | 1 | DHM | 120-M | | | |
| 217A | A | 3'-0" | 7'-0" | 2" | DHM | 2 | DHM | 70 | | | |
| 221A | D | 5'-0" | 7'-0" | 2" | DHM | 3 | DHM | 316S | | | DOOR SIZE GIVEN IS CLEAR OPENING |
| 222A | D | 5'-0" | 7'-0" | 2" | DHM | 3 | DHM | 316S | | | DOOR SIZE GIVEN IS CLEAR OPENING |
| 233A | A | 3'-0" | 7'-0" | 2" | DHM | 2 | DHM | 316S | | | |

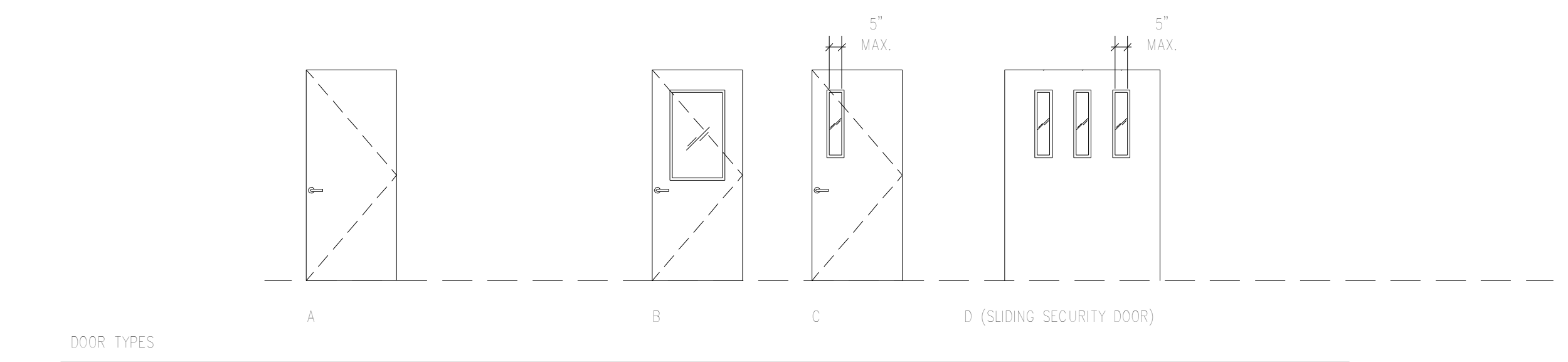

| DOOR SCHEDULE - CENTRAL ENERGY PLANT - THIRD FLOOR | | | | | | | | | | | |
|--|-----------|-----------|--------|-------|----------|------------|----------|-----------|-------------------|---------|---------|
| DOOR NUMBER | DOOR TYPE | DOOR SIZE | | | MATERIAL | FRAME | | LOCK TYPE | FIRE RATING LABEL | GLAZING | REMARKS |
| | | WIDTH | HEIGHT | THICK | | FRAME TYPE | MATERIAL | | | | |
| | | S43A | C | 3'-0" | | 7'-0" | 2" | | | | |
| S83A | C | 3'-0" | 7'-0" | 2" | DHM | 2 | DHM | 300-S | 45 MIN | SG-2F | |
| S83B | A | 3'-0" | 7'-0" | 2" | DHM | 2 | DHM | 70 | 45 MIN | | |
| 304A | C | 3'-0" | 7'-0" | 2" | DHM | 1 | DHM | 120-M | | | |
| 304B | B | 3'-0" | 7'-0" | 2" | DHM | 1 | DHM | 120-M | | | |
| 307A | B | 3'-0" | 7'-0" | 2" | DHM | 2 | DHM | 300-S | | | |
| 307B | C | 3'-0" | 7'-0" | 2" | DHM | 2 | DHM | 70 | | | |
| 311B | (2) A | 3'-0" | 7'-0" | 2" | DHM | 2 | DHM | 70 | | | |
| 311C | (2) A | 3'-0" | 7'-0" | 2" | DHM | 2 | DHM | 380-A | | | |

| DOOR SCHEDULE - CONNECTOR ADDITION/RENOVATION - SECOND FLOOR | | | | | | | | | | | |
|--|-----------|-----------|--------|-------|----------|------------|----------|-----------|-------------------|---------|-------------------------------------|
| DOOR NUMBER | DOOR TYPE | DOOR SIZE | | | MATERIAL | FRAME | | LOCK TYPE | FIRE RATING LABEL | GLAZING | REMARKS |
| | | WIDTH | HEIGHT | THICK | | FRAME TYPE | MATERIAL | | | | |
| | | 211A | B | 3'-0" | | 7'-0" | 2" | | | | |
| 211B | B | 3'-0" | 7'-0" | 2" | DHM | 1 | DHM | 120-M | | | |
| 211C | C | 3'-0" | 7'-0" | 2" | DHM | 1 | DHM | 120-M | | | |
| 211D | B | 3'-0" | 7'-0" | 2" | DHM | 1 | DHM | 120-M | | | |
| 211E | C | 3'-0" | 7'-0" | 2" | DHM | 1 | DHM | 120-M | | | NEW DOOR AND FRAME IN EXISTING WALL |
| 211F | (2)B | 3'-0" | 7'-0" | 2" | DHM | 6 | DHM | 300-S | | | |

| DOOR SCHEDULE - ELEVATOR ADDITION - FIRST & SECOND FLOORS | | | | | | | | | | | |
|---|-----------|-----------|--------|-------|----------|------------|----------|--------------|-------------------|---------|--|
| DOOR NUMBER | DOOR TYPE | DOOR SIZE | | | MATERIAL | FRAME | | HARDWARE SET | FIRE RATING LABEL | GLAZING | REMARKS |
| | | WIDTH | HEIGHT | THICK | | FRAME TYPE | MATERIAL | | | | |
| | | 140A | C | 3'-0" | | 7'-0" | 2" | | | | |
| 140B | C | 3'-0" | 7'-0" | 2" | DHM | 4 | DHM | 120-S | 45 MIN | SG-2F | |
| 140D | D | 5'-0" | 7'-0" | 2" | DHM | 5 | DHM | 316S | | | NEW DOOR AND FRAME IN EXISTING WALL. CLEAR DOOR OPENING GIVEN. |

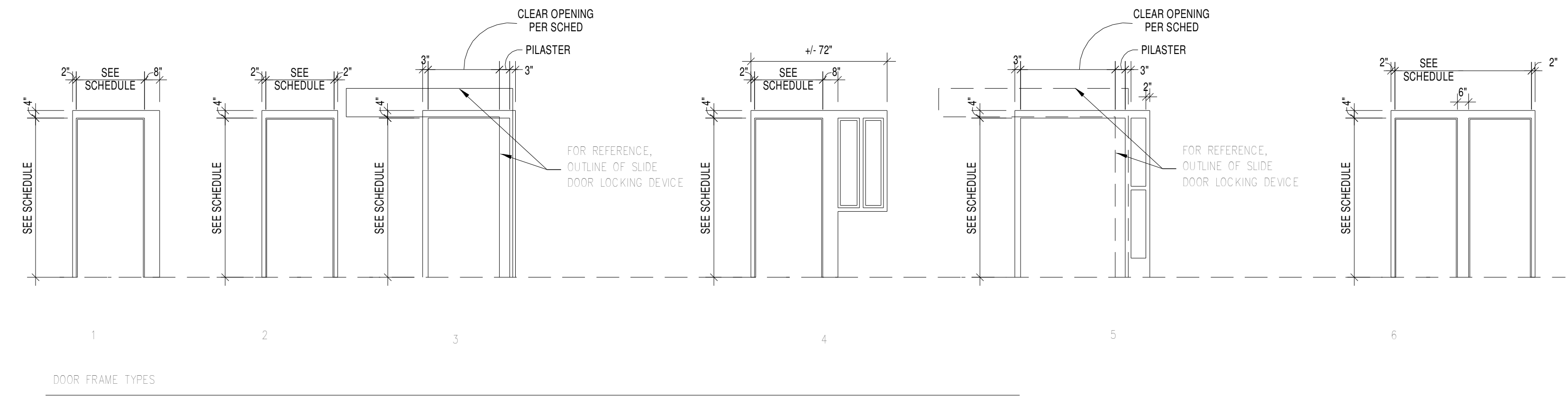

GENERAL DOOR/FRAE NOTES:

- REFER TO SECTION 11 19 53-DETENTION HARDWARE.
- LOCK TYPE IS DEFINED IN 11 19 53.
- ALTHOUGH HARDWARE SETS ARE NOT INDICATED FOR OPENINGS, ALL DOORS SHALL BE PROVIDED WITH ALL NECESSARY AND NORMAL HARDWARE AS SPECIFIED IN 11 19 53.
- ALL FRAMES SHALL BE CAULKED CONTINUOUSLY WITH SECURITY JOINT SEALANT TO THE WALL ON BOTH SIDES.
- DOOR SCHEDULED TO HAVE A FIRE RATING LABEL SHALL HAVE HARDWARE SETS THAT INCLUDE NECESSARY ITEMS FOR A LABEL.
- EXTERIOR DOORS SHALL HAVE FLORIDA PRODUCT APPROVAL TO MATCH WIND DESIGN CRITERIA ASSOCIATED WITH BUILDING.
- SEE SHEET QD-020 FOR DETAILS.

DOOR LEGEND:

DHM DETENTION HOLLOW METAL SECTION 11 19 13



Dewberry Architects Inc.
401 SW Water St.
Suite 701
Peoria, IL 61602
309.282.8000 Phone
309.282.8001 Fax



Pinellas County
Upgrade Jail Campus Infrastructure
Phase I Design Criteria
11440 North 49th Street
Clearwater, FL.

SEAL

PRELIMINARY DOCUMENTS
NOT FOR CONSTRUCTION

KEY PLAN

SCALE

1/4" = 1'-0"

| No. | Description | Date |
|-----|-------------|------|
| | | |
| | | |
| | | |
| | | |
| | | |
| | | |
| | | |
| | | |
| | | |
| | | |

REVISIONS

DRAWN BY _____ Author

APPROVED BY _____ Approver

CHECKED BY _____ Checker

DATE _____ 3/19/2014

TITLE

DOOR SCHEDULE
- DETENTION -
INFAS BLDG

PROJECT NO. _____ 50057109

QD-400

SHEET NO.

F

E

D

C

B

A

| INTERIOR WINDOW SCHEDULE - CENTRAL ENERGY PLANT | | | | | | | | |
|---|--------------------|--------|--------|-------------|-------|----------|--------------|-------|
| MARK | LOCATION | SIZE | | SILL HEIGHT | TYPE | MATERIAL | GLAZING TYPE | LABEL |
| | | WIDTH | HEIGHT | | | | | |
| S13 | FIRST FLOOR - 137 | 3'-6" | 4'-0" | 3'-4" | SW-05 | DHM | SG-2F | Y |
| S14 | FIRST FLOOR - 137 | 9'-6" | 4'-0" | 3'-4" | SW-06 | DHM | SG-2F | Y |
| S15 | FIRST FLOOR - 137 | 6'-4" | 4'-0" | 3'-4" | SW-07 | DHM | SG-2F | Y |
| S16 | FIRST FLOOR - 137 | 5'-4" | 4'-0" | 3'-4" | SW-08 | DHM | SG-2F | Y |
| S17 | FIRST FLOOR - 137 | 9'-0" | 4'-0" | 3'-4" | SW-09 | DHM | SG-2F | Y |
| S18 | FIRST FLOOR - 137 | 5'-4" | 4'-0" | 3'-4" | SW-06 | DHM | SG-2F | Y |
| S19 | FIRST FLOOR - 137 | 3'-4" | 4'-0" | 3'-4" | SW-10 | DHM | SG-2F | Y |
| S26 | SECOND FLOOR - 214 | 4'-8" | 4'-0" | 3'-4" | SW-04 | DHM | SG-2F | Y |
| S27 | SECOND FLOOR - 214 | 3'-4" | 4'-0" | 3'-4" | SW-14 | DHM | SG-2F | Y |
| S28 | SECOND FLOOR - 214 | 11'-0" | 4'-0" | 3'-4" | SW-15 | DHM | SG-2F | Y |
| S29 | SECOND FLOOR - 214 | 5'-0" | 4'-0" | 3'-4" | SW-16 | DHM | SG-2F | Y |
| S30 | SECOND FLOOR - 214 | 16'-0" | 4'-0" | 3'-4" | SW-17 | DHM | SG-2F | Y |
| S31 | SECOND FLOOR - 214 | 5'-0" | 4'-0" | 3'-4" | SW-18 | DHM | SG-2F | Y |
| S32 | SECOND FLOOR - 214 | 4'-0" | 4'-0" | 3'-4" | SW-18 | DHM | SG-2F | Y |

- GENERAL NOTES
1. ALL FRAMES SHALL BE CAULKED CONTINUOUSLY WITH SECURITY JOINT SEALANT TO THE WALL ON BOTH SIDES.
 2. EXTERIOR WINDOWS SHALL HAVE FLORIDA PRODUCT APPROVAL TO MATCH WIND DESIGN CRITERIA ASSOCIATED WITH BUILDING.
 3. SEE SECTION 11 19 43-DETENTION ENCLOSURES FOR WOVEN ROOF MESH SYSTEMS.
 4. SEE 00-20 FOR DETAILS.

DOOR LEGEND

DHM DETENTION HOLLOW METAL, SECTION 11 19 13

HSW HURRICANE-SECURITY WINDOW SYSTEM, SECTION 11 19 13. ALL WINDOWS ARE BARRED.

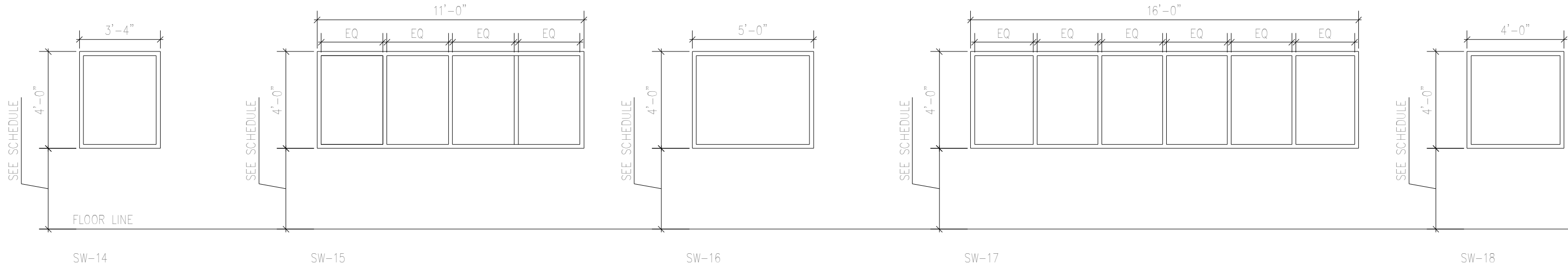
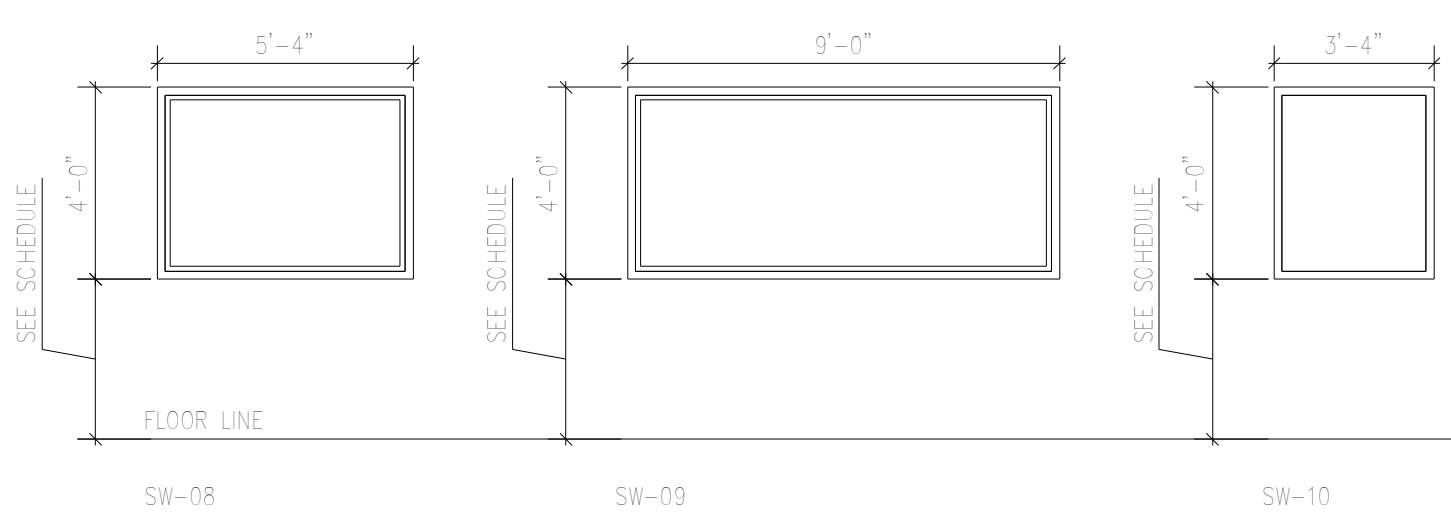
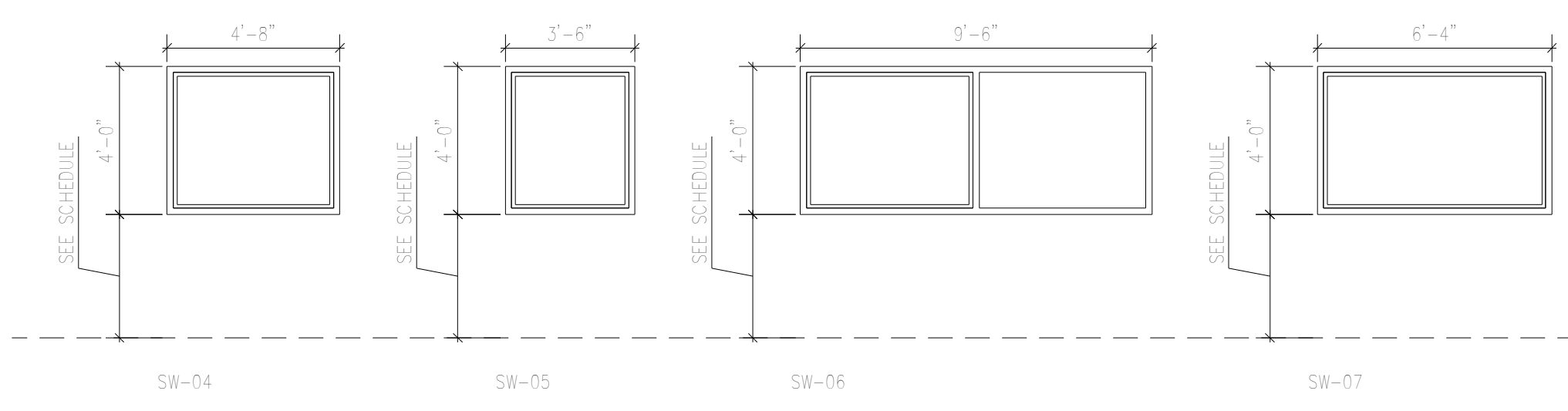

Dewberry Architects Inc.
 401 SW Water St.
 Suite 701
 Peoria, IL 61602
 309.282.8000 Phone
 309.282.8001 Fax



Pinellas County
 Upgrade Jail Campus Infrastructure
 Phase I Design Criteria
 114400 North 49th Street
 Clearwater, FL.

SEAL

PRELIMINARY DOCUMENTS
 NOT FOR CONSTRUCTION

KEY PLAN

SCALE

1/4" = 1'-0"

| No. | Description | Date |
|-----|-------------|------|
| | | |
| | | |
| | | |
| | | |
| | | |
| | | |
| | | |
| | | |
| | | |
| | | |

REVISIONS

DRAWN BY _____ Author

APPROVED BY _____ Approver

CHECKED BY _____ Checker

DATE _____ 3/19/2014

TITLE

WINDOW SCHEDULE CONT.
 - DETENTION -
 INFAS BLDG

PROJECT NO. 50057109

SHEET NO.

QD-601