

GENERAL NOTES (THIS SHEET ONLY):

134-0251-NC PSC C-Building & Tower Exhibit 2

1. PRIOR TO COMMENCING ANY EXCAVATION OR GRADING, THE CONTRACTOR SHALL ACHIEVE SATISFACTION AS TO THE ACCURACY OF ALL SURVEY DATA AS INDICATED IN THE PLANS AND SPECIFICATIONS AND/OR AS PROVIDED BY MOTOROLA.
2. THE CONTRACTOR SHALL BE RESPONSIBLE FOR PRESERVING ALL ESTABLISHED SURVEY CONTROL POINTS. IF THE CONTRACTOR OR ANY SUBCONTRACTORS MOVE OR DESTROY ANY SURVEY CONTROL POINTS, THE COST INCURRED BY THE OWNER OR MOTOROLA TO RE-ESTABLISH THEM WILL BE BORNE BY THE CONTRACTOR.
3. BEFORE CLEARING, THE CONTRACTOR SHALL ENSURE THAT THE AREA TO BE CLEARED HAS BEEN PROPERLY MARKED BY THE SURVEYORS AND ANY APPROVALS REQUIRED FROM THE LOCAL AUTHORITIES HAVE BEEN OBTAINED.
4. THE CONTRACTOR SHALL ENSURE THAT ALL THE TREES, SHRUBS, STUMPS AND OTHER SURFACE OBSTRUCTIONS ARE REMOVED AND DISPOSED OFF AT AN APPROVED DUMP SITE. ANY BURNING SHALL BE DONE ONLY WHERE PERMITTED, AND IN ACCORDANCE WITH ALL STATE AND LOCAL FIRE ORDINANCES.
5. THE CONTRACTOR SHALL GIVE ALL NOTICES AND COMPLY WITH ALL LAWS, ORDINANCES, RULES, REGULATIONS AND LAWFUL ORDERS OF ANY PUBLIC AUTHORITY, MUNICIPAL AND UTILITY COMPANY SPECIFICATIONS, AND LOCAL AND STATE JURISDICTIONAL CODES BEARING ON THE PERFORMANCE OF THE WORK. THE WORK PERFORMED ON THE PROJECT AND THE MATERIALS INSTALLED SHALL BE IN STRICT ACCORDANCE WITH ALL APPLICABLE CODES, REGULATIONS, AND ORDINANCES.
6. THE SCOPE OF WORK SHALL INCLUDE FURNISHING ALL MATERIALS AND EQUIPMENT NOT SHOWN IN THE BILL OF MATERIALS AS OWNER FURNISHED, AND ALL LABOR DEEMED NECESSARY TO COMPLETE THE WORK/PROJECT AS DESCRIBED HEREIN.
7. THE CONTRACTOR SHALL VISIT THE JOB SITE PRIOR TO PERFORMING WORK TO ACHIEVE FAMILIARITY WITH THE FIELD CONDITIONS AND TO VERIFY THAT THE PROJECT CAN BE CONSTRUCTED IN ACCORDANCE WITH THE CONTRACT DOCUMENTS. NOTIFY THE CONSTRUCTION MANAGER OF ANY DISCREPANCIES OR INTERFERENCES WHICH AFFECT THE WORK OF THIS CONTRACT.
8. THE CONTRACTOR SHALL INSTALL ALL EQUIPMENT AND MATERIALS ACCORDING TO THE MANUFACTURER'S/VENDOR'S SPECIFICATIONS UNLESS NOTED OTHERWISE OR WHERE LOCAL CODES OR ORDINANCES TAKE PRECEDENCE.
9. THE CONTRACTOR SHALL BE RESPONSIBLE FOR OBTAINING ALL PERMITS AND INSPECTIONS WHICH MAY BE REQUIRED FOR THE WORK BY THE STATE, COUNTY OR LOCAL GOVERNMENT AUTHORITY.
10. THE CONTRACTOR SHALL MAKE NECESSARY PROVISIONS TO PROTECT EXISTING IMPROVEMENTS, EASEMENTS, PAVING, CURBING, ETC. DURING CONSTRUCTION. UPON COMPLETION OF WORK, THE CONTRACTOR SHALL REPAIR ANY DAMAGE THAT MAY HAVE OCCURRED DUE TO CONSTRUCTION ON OR ABOUT THE PROPERTY.
11. THE CONTRACTOR SHALL KEEP THE GENERAL WORK AREA CLEAN AND HAZARD FREE DURING CONSTRUCTION AND DISPOSE OF ALL DIRT, DEBRIS, VEGETATION, AND RUBBISH, AND REMOVE EQUIPMENT NOT SPECIFIED AS REMAINING ON THE PROPERTY. PREMISES SHALL BE LEFT IN CLEAN CONDITION AND FREE FROM PAINT SPOTS, DUST, OR SMUDGES OF ANY NATURE.
12. SEED AND MULCH ALL DISTURBED AREAS NOT COVERED BY OTHER MATERIALS IN ACCORDANCE WITH THE SPECIFICATIONS.
13. ANY PROPERTY DAMAGE CAUSED BY THE CONTRACTOR OR THE CONTRACTOR'S OPERATIONS SHALL BE CORRECTED AND/OR RESTORED TO THE SATISFACTION OF THE PROPERTY OWNER(S) AND MOTOROLA AT NO ADDITIONAL COST TO THE PROPERTY OWNER OR MOTOROLA.

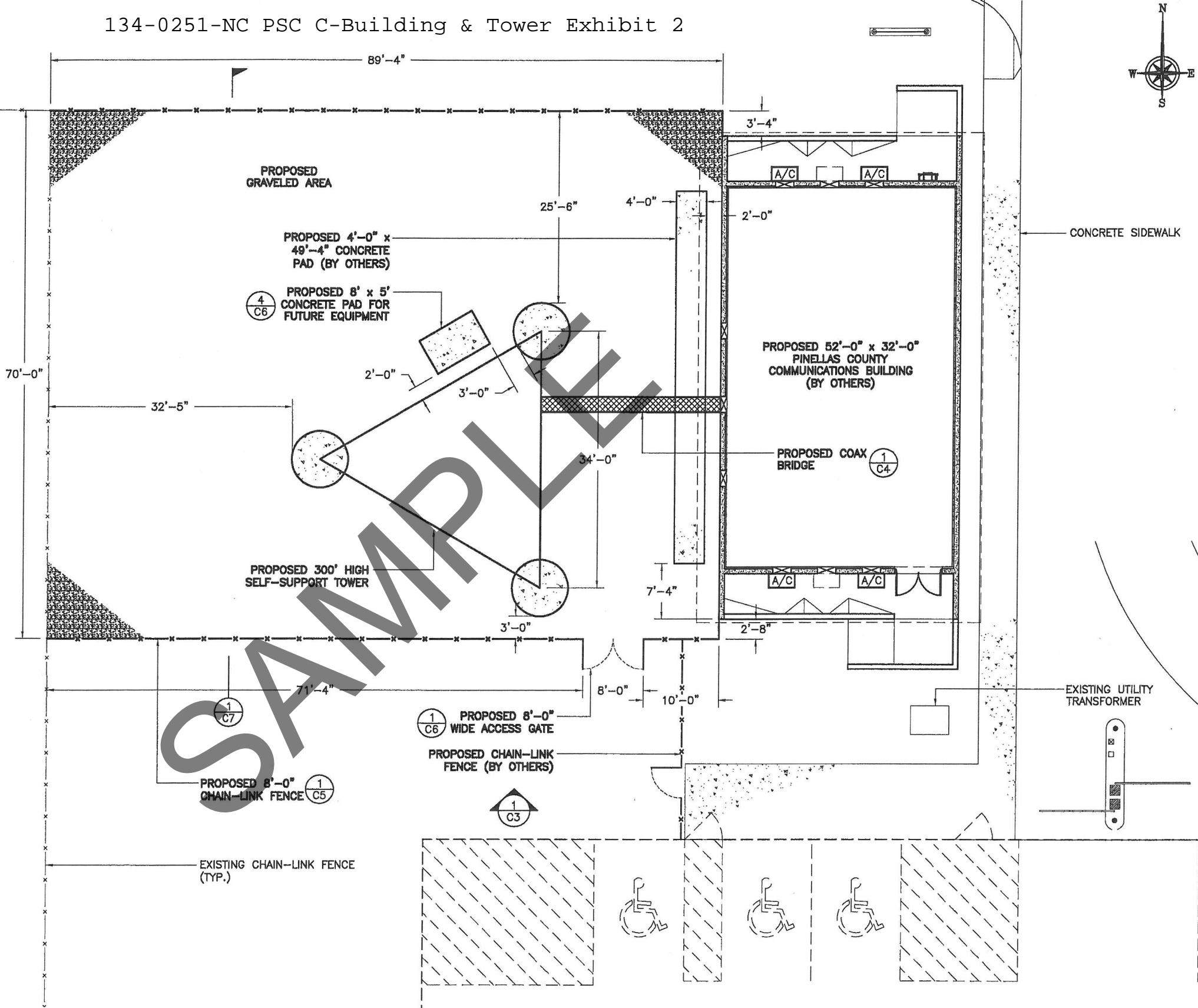

1 COMPOUND PLAN
0 5' 10' 15'
GRAPHIC SCALE