

Clerk of the Circuit Court and Comptroller
Regular Public Meeting
June 2, 2015

10. Miscellaneous items received for filing:

- a. City of Clearwater Notices of Public Hearings regarding proposed Ordinances Nos. 8705-15 through 8713-15 annexing certain properties and amending the Land Use Plan and the Zoning Atlas; public hearings to be held June 3, 2015.
- b. City of Pinellas Park Notice of Public Hearing held May 14, 2015, regarding proposed Ordinance No. 3942 voluntarily annexing certain property.
- c. City of St. Petersburg Notice of Public Hearings regarding two proposed ordinances approving a Community Redevelopment Plan for the Southside St. Petersburg Community Redevelopment Area (CRA) and establishing a Tax Increment Financing District and Redevelopment Trust Fund for the CRA. Public hearings held May 21 and to be held June 11, 2015, respectively.

If a copy of a report or CD is desired, please check the web page of the organization/municipality or contact Board Records at 464-3465.

City of
PINELLAS PARK

5141 78TH AVE. • P.O. BOX 1100
PINELLAS PARK, FL 33780-1100

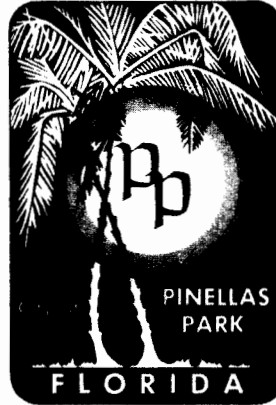

FLORIDA

PHONE • (727) 541-0700
FAX • (727) 544-7448
SUNCOM • 969-1011

April 30, 2015

Board of County Commissioners
Pinellas County
315 Court Street
Clearwater, FL 33756

RE: SUBMITTAL OF VOLUNTARY ANNEXATION PETITION TO PINELLAS COUNTY

Please be advised that the City of Pinellas Park is proceeding with the voluntarily annexation of the following property. The first reading of the annexation ordinance will be at the 4/23/2015, City Council Meeting:

Owner:	First Properties Holding Inc.
Address:	11620 54th Street North
Parcel:	16/30/16/57677/000/0010
Land Use Map Designation:	County = IL City = IL
Ordinance No. (to be assigned):	First Reading — 4/23/2015 Public Hearing — 5/14/2015

This annexation is in compliance with both the Interlocal Agreement, dated July 2000, between Largo, Pinellas County and Pinellas Park, and the Settlement Agreement between all the Cities of Pinellas County, Florida, for the Resolution of Issues related to the Charter Review Committee, dated May 2007.

Copies of the petition, annexation ordinance, legal description, and map are enclosed. Please feel free to contact me personally if further information is required.

Sincerely,

Amanda Conte
Community Business Coordinator
City of Pinellas Park, FL
(727) 541-0946

RECEIVED
BOARD OF
2015 MAY -4 PM 12:56
PINELLAS COUNTY
COMMISSIONERS
FLORIDA



PRINTED ON RECYCLED PAPER

PETITION FOR ANNEXATION TO THE CITY OF PINELLAS PARK, FLORIDA

The undersigned, being the sole OWNER (*"OWNER" is used herein for singular or plural, the singular shall include the plural, and any gender shall include all genders, as context requires*) of the following described real property located within Pinellas County, Florida, hereby consents and agrees to annexation of such property by the City of Pinellas Park, Florida, and further requests the City of Pinellas Park to forthwith undertake annexation proceedings to annex the said real property:

PARCEL: 16/30/16/57677/000/0010
(Located at 11620 54th Street North)

MID COUNTY INDUSTRIAL CENTER ADDITION LOTS 1 & 2.

Containing 1.25 acres MOL

The names and addresses of the undersigned representing all of the legal owners of the above-described property are as follows:

First Properties Holding Inc.
Care of: Mr. James Marsh
13909 Egret Lane
Clearwater, FL 33762

OWNER'S SIGNATURE:

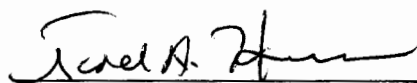
Witness *owner*

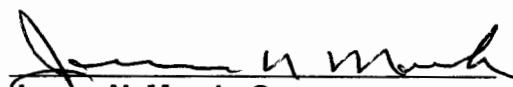
James N. Marsh, Owner

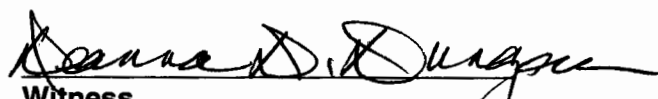
Witness

Phone number in case we need to reach you: 727-507-8500

3/3/15

ORDINANCE NO. _____

AN ORDINANCE ANNEXING INTO THE CITY OF PINELLAS PARK, FLORIDA, A CERTAIN PARCEL OF LAND GENERALLY LOCATED AT 11620 54TH STREET NORTH, LEGALLY DESCRIBED AS ATTACHED HERETO IN EXHIBIT "A" AND MADE A PART HEREOF, LYING WITHIN SECTION 16, TOWNSHIP 30 SOUTH, RANGE 16 EAST, PINELLAS COUNTY, FLORIDA; PROVIDING FOR AMENDMENT OF THE LEGAL DESCRIPTION OF THE CORPORATE BOUNDARIES OF THE CITY OF PINELLAS PARK, FLORIDA; PROVIDING FOR THE ASSIGNMENT OF CITY ZONING CLASSIFICATION; PROVIDING FOR REPEAL OF ORDINANCES OR PARTS OF ORDINANCES CONFLICTING HERewith; PROVIDING FOR AN EFFECTIVE DATE. (First Properties Holding Inc. AX15-11)

WHEREAS, the Owner of a certain parcel of land lying in an unincorporated area of Pinellas County, Florida, and contiguous to the City of Pinellas Park have petitioned City Council requesting that said land be annexed into the City of Pinellas Park, Florida; and

WHEREAS, all requirements of Florida Statutes, Chapter 171, pertaining to the voluntary annexation have been complied with.

NOW, THEREFORE, BE IT ORDAINED BY THE MAYOR AND CITY COUNCIL OF THE CITY OF PINELLAS PARK, PINELLAS COUNTY, FLORIDA, AS FOLLOWS:

SECTION ONE: That the land lying in an unincorporated area of Pinellas County, Florida, and contiguous to the City of Pinellas Park, generally located at 11620 54th Street North, and legally described as attached hereto in Exhibit "A" and made a part hereof, lying within Section 16, Township 30 South, Range 16 East, Pinellas County, Florida, is hereby annexed into the City of Pinellas Park.

SECTION TWO: That the legal description of the corporate boundaries of the City of Pinellas Park, Florida, is hereby amended to include the land herein annexed. The legal description of the City of Pinellas Park, Florida, contained in the City Charter, and all official City maps and other official documents shall be amended accordingly.

SECTION THREE: That the land herein annexed shall be assigned the City zoning classification of M-1 which is the closest compatible to the County M-1 Commercial zoning on the subject parcel at the time of annexation.

SECTION FOUR: That the City Zoning Map is hereby amended to conform to the provisions of this Ordinance.

SECTION FIVE: That all Ordinances or parts of Ordinances in conflict with the provisions of this Ordinance be, and they are hereby, repealed insofar as the same affects this Ordinance.

SECTION SIX: That this Ordinance shall become effective immediately upon its final passage and adoption.

FIRST READING	_____	DAY OF _____, 2015
PUBLISHED MAP & TITLE	_____	DAY OF _____, 2015
PUBLISHED MAP ONLY	_____	DAY OF _____, 2015
PUBLIC HEARING	_____	DAY OF _____, 2015
PASSED THIS	_____	DAY OF _____, 2015

AYES:
NAYS:
ABSENT:
ABSTAIN:

APPROVED THIS _____ DAY OF _____, 2015

ATTEST:

SANDRA L. BRADBURY, MAYOR

DIANE M. CORNA, MMC, CITY CLERK

ANNEXATION ORDINANCE LEGAL

First Properties Holding Inc.-AX15-11

PARCEL: 16/30/16/57677/000/0010

Located at: 11620 54th Street North

LOTS 1 & 2, MID COUNTY INDUSTRIAL CENTER ADDITION, ACCORDING TO THE PLAT THEREOF, AS RECORDED IN PLATBOOK 83, PAGES 89-90, OF THE PUBLIC RECORDS OF PINELLAS COUNTY, FLORIDA, BEING FURTHER DESCRIBED AS FOLLOWS:

FROM THE NORTHEAST CORNER OF LOT 2, MID COUNTY INDUSTRIAL CENTER ADDITION, FURTHER DESCRIBED ABOVE, SAID POINT BEING THE POINT OF BEGINNING, RUN NORTH 89°57'02" WEST 252.80'; THENCE SOUTH 00°11'21" WEST 200.00'; THENCE SOUTH 89°57'02" EAST 277.64' TO THE WEST RIGHT OF WAY LINE OF 54TH STREET NORTH; THENCE NORTH 00°14'09" EAST ALONG SAID RIGHT OF WAY LINE 130.28' TO A POINT OF CURVE; THENCE 37.82' ALONG THE ARC OF A CURVE TO THE LEFT WITH A RADIUS OF 55.00', A CHORD BEARING OF NORTH 19°27'52" WEST, A CHORD DISTANCE OF 37.08' TO A POINT OF REVERSE CURVE; THENCE 37.64' ALONG THE ARC OF A CURVE TO THE RIGHT WITH A RADIUS OF 55.00'; A CHORD BEARING OF NORTH 19°33'28" WEST, A CHORD DISTANCE OF 36.91' TO THE POINT OF BEGINNING.

A PARCEL CONTAINING 1.26 ACRES M.O.L.



16-30-16-57677-000-0010
11620 54th Street North

AX15-11

**CITY OF PINELLAS PARK
NOTICE OF PUBLIC HEARING**

Notice is hereby given that the City Council will hold **PUBLIC HEARING** upon **ORDINANCE 3942** on the **14TH** day of **MAY, 2015**, at 7:30 P.M., the title of said item being as follows:

ORDINANCE NO 3942

AN ORDINANCE ANNEXING INTO THE CITY OF PINELLAS PARK, FLORIDA, A CERTAIN PARCEL OF LAND GENERALLY LOCATED AT 11620 54TH STREET NORTH, LEGALLY DESCRIBED AS ATTACHED HERETO IN EXHIBIT 'A' AND MADE A PART HEREOF, LYING WITHIN SECTION 16, TOWNSHIP 30 SOUTH, RANGE 16 EAST, PINELLAS COUNTY, FLORIDA; PROVIDING FOR AMENDMENT OF THE LEGAL DESCRIPTION OF THE CORPORATE BOUNDARIES OF THE CITY OF PINELLAS PARK, FLORIDA; PROVIDING FOR THE ASSIGNMENT OF CITY ZONING CLASSIFICATION; PROVIDING FOR REPEAL OF ORDINANCES OR PARTS OF ORDINANCES CONFLICTING HERewith; PROVIDING FOR AN EFFECTIVE DATE.

(FIRST PROPERTIES HOLDING INC. AX15-11)

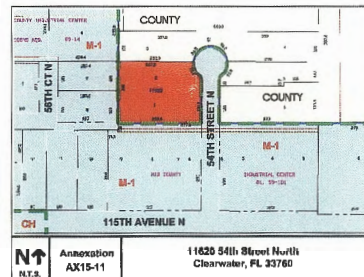

These documents are available for review in the City Clerk's Office. Interested parties are invited to attend this meeting and be heard. If a person decides to appeal any decision made by the board, agency or commission with respect to any matter considered at such meeting or hearing, he or she will need a record of the proceedings and that, for such purpose, he or she may need to ensure that a verbatim record of the proceedings is made, which record includes the testimony and evidence upon which the appeal is to be based. Physically handicapped person who require special assistance or accommodations to attend the hearing should contact the City in writing at least 48 hours in advance to ensure that such accommodations are made available.

**DIANE M. CORNA, MMC
CITY CLERK
CITY OF PINELLAS PARK**

To be published in the St. Petersburg Times – Local News Section

on the following date(s) Friday, April 24, 2015 and Friday, May 1, 2015