

6. MISCELLANEOUS ITEMS RECEIVED FOR FILING:

City of Safety Harbor Ordinance No. 2014-19 adopted December 15, 2014 annexing certain property.

Bachteler, James J

From: Karen Sammons [ksammons@cityofsafetyharbor.com]
Sent: Tuesday, December 16, 2014 9:44 AM
To: 'skcody@ufl.edu'; 'Cutillo, Matthew'; BoardRecords; Lescarbeau, Janine M; 'Jay Young'; Loy, Norman; Lindgren, Dawn; Sokolowski, Nicole; Shellhorn, Alan L; 'annexationrequests@duke-energy.com'; Whitby, Mark J; 'kristi.cheatham@clearwatergas.com'; Liz Cloud - Dept. of State; Beardslee, Gordon R
Cc: Ginny Stewart; Marcie Stenmark; Danny Sandlin; Kathy Bushman; Sherri Kennedy; Lori Hensel; Celeste Cummins; John Powell; Deborah Drees
Subject: Annexation Ordinance 2014-19 (Safety Harbor)
Attachments: 2014-19.pdf

Attached is Ordinance No. 2014-19, approved and adopted by the Safety Harbor City Commission on December 15, 2014. The Ordinance annexes the property located at 2922 Shore Drive into the City of Safety Harbor. At the time of annexation, one person resided on the property (a single family residence).

Sincerely,

Karen Sammons, CMC
City Clerk
City of Safety Harbor
750 Main St.
Safety Harbor, FL 34695
(727) 724-1555, ext. 1406

Florida has very broad public records laws. Most written communications to or from local officials regarding City business are public records and are available to the public and media upon request. Your email communication may, therefore, be subject to public disclosure. Under Florida Law, email addresses are public records. If you do not want your email address released to a public records request, do not send electronic mail to this entity. Instead, contact this office by phone or in writing.

RECEIVED
2014 DEC 16 AM 10:28
COMMISSIONER
HILL AS COUNTY CLERK

ORDINANCE NO. 2014-19

AN ORDINANCE OF THE CITY OF SAFETY HARBOR, FLORIDA, ANNEXING CERTAIN PROPERTY LOCATED AT 2922 SHORE DRIVE, SAFETY HARBOR, FLORIDA INTO THE CORPORATE LIMITS OF THE CITY OF SAFETY HARBOR, FLORIDA; PROVIDING FOR PUBLICATION IN ACCORDANCE WITH LAW; AND PROVIDING FOR AN EFFECTIVE DATE.

WHEREAS, the City of Safety Harbor, Florida, has been petitioned by the owner of the property described herein to annex such property, which is reasonably compact, lying contiguous to the territorial limits of said City; and

WHEREAS, said petition was accompanied by all proper documentation certifying the titleholder to and ownership of said property.

NOW, THEREFORE, BE IT ORDAINED BY THE CITY COMMISSION OF THE CITY OF SAFETY HARBOR, FLORIDA, that:

1. The City of Safety Harbor, Florida, hereby annexes into the corporate limits of the City of Safety Harbor, the following property legally described as:

LEGAL DESCRIPTION: Bayfront Manor, Block 3, Lot 28, recorded in Plat Book 31, Pages 65 and 66, Public Records of Pinellas County, Florida

PROPERTY ADDRESS: 2922 Shore Drive, Safety Harbor, Florida

PARCEL ID: 22-28-16-03456-003-0280 (the "Property")

2. The boundary lines of the City of Safety Harbor are hereby redefined to include the Property.
3. The Property shall be subject to all laws and ordinances of the City and shall enjoy all of the privileges and be subject to all of the liabilities as set forth in Chapter 171, Florida Statutes as are applicable to other property within the corporate limits of the City of Safety Harbor.
4. This Ordinance shall become effective immediately upon its passage and adoption.
5. This Ordinance shall be published in accordance with the requirements of law.

PASSED ON FIRST READING THIS 1st DAY OF DECEMBER, 2014.

PASSED AND ADOPTED ON SECOND READING THIS 15th DAY OF DECEMBER, 2014.

APPROVED AS TO FORM:

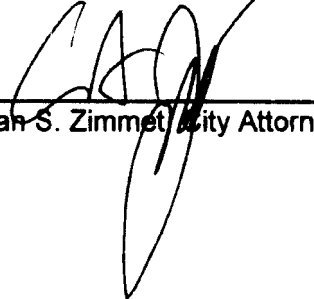

Alan S. Zimmet, City Attorney

ATTEST:

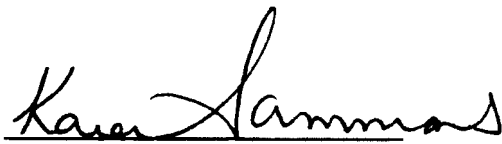

Karen Sammons, CMC, City Clerk

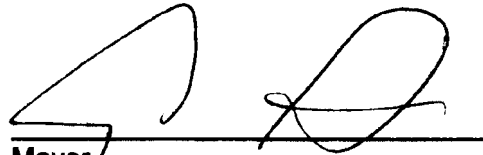

Mayor

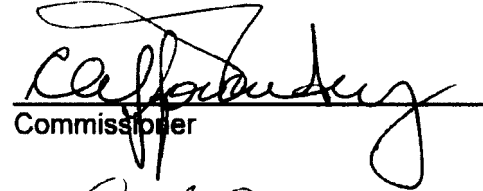

Commissioner

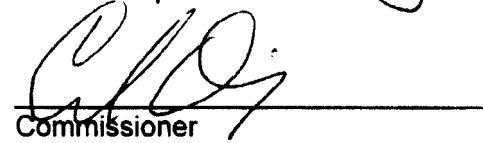

Commissioner

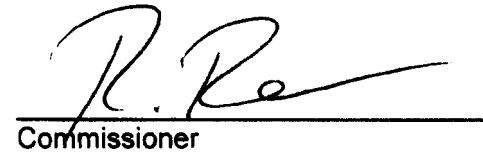

Commissioner

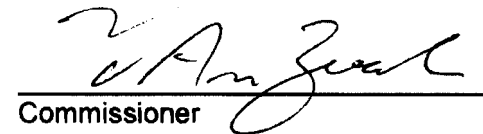

Commissioner

AN/ZO 2014-106 ROCCO PROPERTY

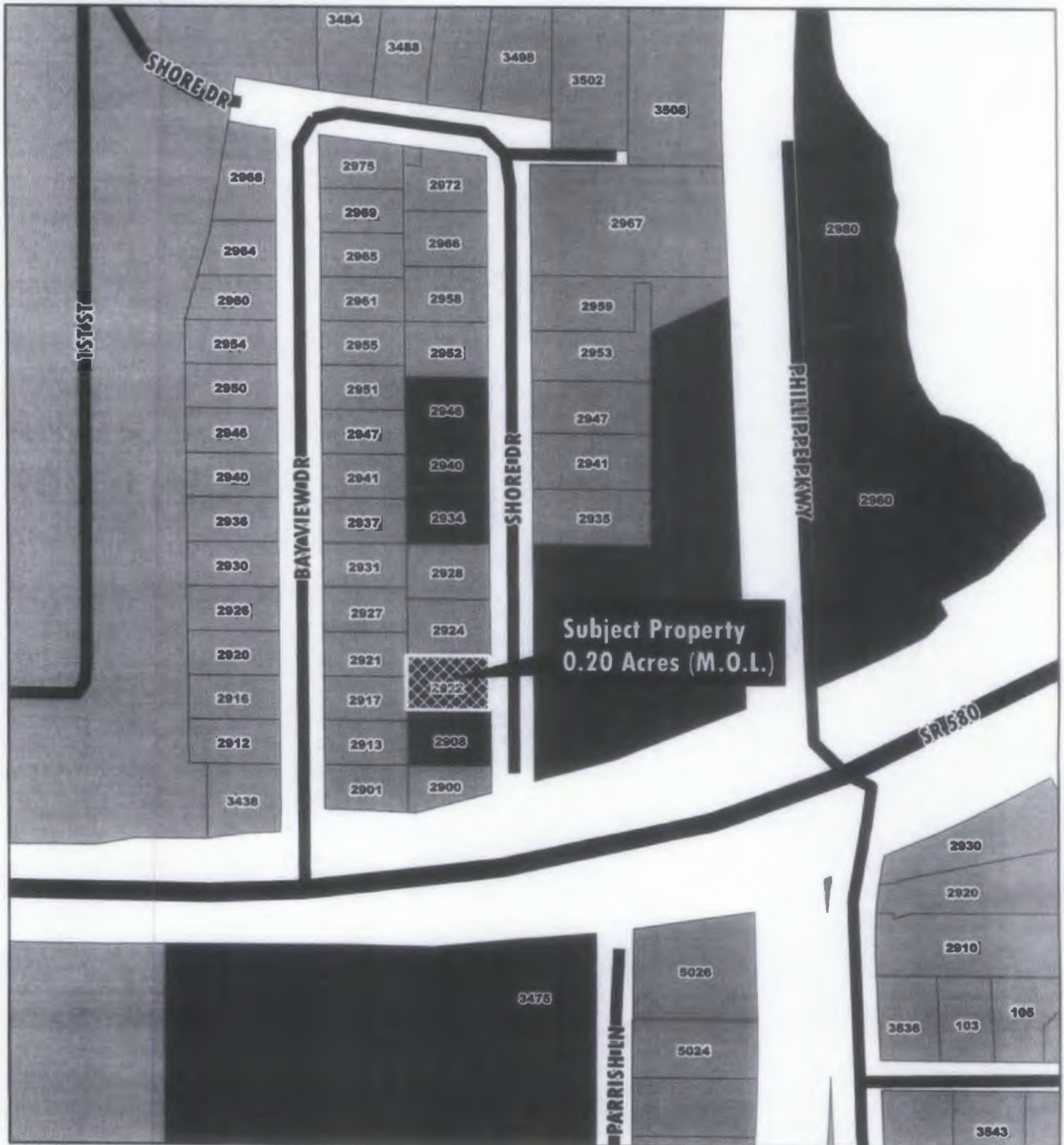

SITE ADDRESS: 2922 SHORE DRIVE
DESCRIPTION: BAYFRONT MANOR BLK 3, LOT 28
PARCEL ID#: 22-28-16-03456-003-0280

SAFETY HARBOR
UNINCORPORATED