

4. MISCELLANEOUS ITEMS TO BE RECEIVED FOR FILING:

- a. City of Clearwater Notice of Public Hearing regarding proposed Ordinances Nos. 8576-14 through 8578-14, amending the Annexation, Land Use Plan, and the Zoning Atlas; public hearings held September 4, 2014.
- b. City of Pinellas Park Notice of Public Hearing held July 10, 2014, regarding proposed Ordinance No. 3887 voluntarily annexing certain property.
- c. City of Safety Harbor Ordinance No. 2014-12 adopted August 4, 2014, annexing certain property.
- d. Eastlake Oaks Community Development District minutes of the meeting held April 10, 2014.

If a copy of a report or CD is desired, please check the web page of the organization/municipality or contact Board Records at 464-3465.

**MINUTES OF MEETING
EASTLAKE OAKS
COMMUNITY DEVELOPMENT DISTRICT**

The regular meeting of the Board of Supervisors of the Eastlake Oaks Community Development District was held Thursday, April 10, 2014 at 6:00 p.m. at the Holiday Inn Express; 3990 Tampa Road; Oldsmar, Florida.

Present and constituting a quorum were:

Joseph Dinelli
Cheryl Asoian
Dan Saracki
Don Nowacki
Nick Yagnik

Chairman
Vice Chairperson
Assistant Secretary
Assistant Secretary
Assistant Secretary

Also present was:

Andrew Mendenhall

District Manager

RECEIVED
BOARD OF
SUPERVISORS
EASTLAKE OAKS
COMMUNITY DEVELOPMENT DISTRICT
2014 AUG - 7 AM 8:44
HILLAS COUNTY FLORIDA

The following is a summary of the discussions and actions taken.

FIRST ORDER OF BUSINESS

Roll Call

Mr. Mendenhall called the meeting to order; Supervisors and staff introduced themselves.

SECOND ORDER OF BUSINESS

**Approval of the Minutes of the
February 13, 2014 Meeting**

On MOTION by Mr. Saracki seconded by Mr. Yagnik, with all in favor, the Minutes of the February 13, 2014 Meeting were approved.

THIRD ORDER OF BUSINESS

Audience Comments

The record shall reflect there is no public in attendance.

FOURTH ORDER OF BUSINESS

Manager's Report

- A. Discussion of General Election Qualifying Period and Consideration of Resolution 2014-1 Confirming the District's Use of the Pinellas County Supervisor of Elections to Continue Conducting the District's Election of Supervisors in Conjunction with the General Election**

On MOTION by Mr. Saracki seconded by Mr. Yagnik, with all in favor, Resolution 2014-1 Confirming the District's Use of the Pinellas County Supervisor of Elections to Continue Conducting the Election of Supervisors in Conjunction with the General Election was adopted.

- B. Discussion of Preliminary Fiscal Year 2015 Budget**

Mr. Dinelli MOVED to change *Deposits* to *Pool Access Key Fee*; and Mr. Saracki seconded the motion.

On VOICE vote, with all in favor, the prior motion was approved.

- C. Discussion of Pool Fences**

- D. Discussion of Security System**

- The Board is most satisfied with McConnie Fence Co.
- Mr. Dinelli recommended replacing keys with cards.
- Mr. Dinelli recommended calling Countryside Locksmith to find out what they can offer.
- A process needs to be set up for the key transfer change, as well as a door hanger indicating keys need to be turned in.

Mr. Saracki MOVED to approve the proposal for a six foot pool fence from McConnie Fence Co.; and Ms. Asoian seconded the motion.

- Mr. Saracki will be the project manager for the implementation.

On VOICE vote, with all in favor, the prior motion was approved subject to confirmation of the final price.

- The proposal from Envera Systems was discussed.

- They need to be able to work with the fence contractor for wiring or whatever is necessary to install their system.
- The breakdown of cost is as follows:
 - \$8,336.75 for the surveillance system.
 - \$3,521 for the access control system.
 - The monthly fee for the surveillance system is \$233.
 - The monthly fee for the access control system cards is \$185.

On MOTION by Mr. Dinelli seconded by Mr. Saracki, with all in favor, the proposal from Envera Systems for security was accepted in an amount not to exceed \$15,000 subject to review by the District Attorney, with said contract to come back before the Board if it exceeds \$15,000.

- Mr. Dinelli will serve as the Project Manager for implementation of this contract. Mr. Mendenhall discussed items separate from the agenda.
- A resident's Oak Tree is hanging over the yard.
 - This is not a CDD-owned tree. The resident is responsible for contacting the city to get the tree removed.
- The Oak Trees by the pool were cut back by the resident. These are not CDD-owned trees and the person will be fined by the city if the tree dies.

FIFTH ORDER OF BUSINESS

Supervisors' Requests

- The wall has been primed and is being painted.
- Power washing also needs to be done.

On MOTION by Ms. Asoian seconded by Mr. Dinelli, with all in favor, the proposal from classic Construction Ltd. to power wash as discussed in the amount of \$4,500; and the proposal to paint the pool wall in the amount of \$2,500 was approved.

SIXTH ORDER OF BUSINESS

**Approval of February 2014 Financial
Statements, Check Register and Invoices**

On MOTION by Mr. Dinelli seconded by Mr. Saracki, with all in favor, acceptance of the February 2014 Financial Statements, Check Register and Invoices was approved.

SEVENTH ORDER OF BUSINESS

Adjournment

On MOTION by Mr. Dinelli seconded by Mr. Saracki, with all in favor, the meeting was adjourned.



Joseph Dinelli
Chairman

**AGENDA
EASTLAKE OAKS
COMMUNITY DEVELOPMENT DISTRICT**

**Thursday
April 10, 2014
6:00 p.m.**

**Holiday Inn Express
3990 Tampa Road
Oldsmar, Florida**

- 1. Roll Call**
- 2. Approval of the Minutes of the February 13 2014 Meeting**
- 3. Audience Comments**
- 4. Manager's Report**
 - A. Discussion of General Election Qualifying Period and Consideration of Resolution 2014-1 Confirming the District's Use of the Pinellas County Supervisor of Elections to Continue Conducting the District's Election of Supervisors in Conjunction with the General Election**
 - B. Discussion of Preliminary Fiscal Year 2015 Budget**
 - C. Discussion of Pool Fences**
 - D. Discussion of Security System**
- 5. Supervisors' Requests**
- 6. Approval of February 2014 Financial Statements, Check Register and Invoices**
- 7. Adjournment**

**THE NEXT REGULAR MEETING
IS SCHEDULED FOR
JUNE 12, 2014 AT 6:00 P.M.**

Tampa Bay Times

Published Daily

St. Petersburg, Pinellas County, Florida

STATE OF FLORIDA
COUNTY OF Pinellas

} S.S.

Before the undersigned authority personally appeared **D. Almeida** who on oath says that he/she is **Legal Clerk** of the **Tampa Bay Times** a daily newspaper published at St. Petersburg, in Pinellas County, Florida; that the attached copy of advertisement, being a **Legal Notice** in the matter **RE: Notice of FY 2014 Meeting Schedule** was published in said newspaper in the issues of **Classified N Pinellas**, **9/25/2013**.

Affiant further says the said **Tampa Bay Times** is a newspaper published at St. Petersburg, in said Pinellas County, Florida and that the said newspaper has heretofore been continuously published in said Pinellas County, Florida, each day and has been entered as second class mail matter at the post office in St. Petersburg, in said Pinellas County, Florida, for a period of one year next preceding the first publication of the attached copy of advertisement, and affiant further says that he /she has neither paid nor promised any person, firm or corporation any discount, rebate, commission or refund for the purpose of securing this advertisement for publication in the said newspaper.



Signature of Affiant

Sworn to and subscribed before me
this **25th** day of **September** A.D.2013

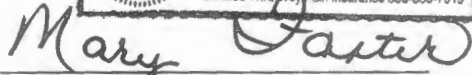
Signature of Notary Public

Personally known X or produced identification

Type of identification produced _____

Notice of Meetings Eastlake Oaks Community Development District

The Board of Supervisors of the Eastlake Oaks Community Development District will hold their meetings for Fiscal Year 2014 on the second Thursday of every other month, except as noted, at 6:00 p.m. in the Board Room of the Holiday Inn Express, 3990 Tampa Road, Oldsmar, Florida.

October 10, 2013
December 12, 2013
February 13, 2014
April 10, 2014
June 12, 2014
August 14, 2014

The meeting may be continued to a date, time, and place to be specified on the record at the meeting.

In accordance with the provisions of the Americans with Disabilities Act, any person requiring special accommodations at this meeting because of a disability or physical impairment should contact the District Management Company, Severn Trent Services at (954) 753-5841. If you are hearing or speech impaired, please contact the Florida Relay Service at (800) 955-8770 for aid in contacting the District Office at least two (2) days prior to the date of the hearing and meeting. Each person who decides to appeal any decision made by the Board with respect to any matter considered at the meeting is advised that person may need to ensure that a verbatim record of the proceedings is made, including the testimony and evidence upon which such appeal is to be based.

Andrew Mendenhall, PMP
District Manager

Published in the Tampa Bay Times, September 25, 2013

(1004028699)

RESOLUTION 2014 – 1

A RESOLUTION OF THE BOARD OF SUPERVISORS OF THE EASTLAKE OAKS COMMUNITY DEVELOPMENT DISTRICT CONFIRMING THE DISTRICT'S USE OF THE PINELLAS COUNTY SUPERVISOR OF ELECTIONS TO CONTINUE CONDUCTING THE DISTRICT'S ELECTION OF SUPERVISORS IN CONJUNCTION WITH THE GENERAL ELECTION.

WHEREAS, the Eastlake Oaks Community Development District (hereinafter the "District") is a local unit of special-purpose government created and existing pursuant to Chapter 190, Florida Statutes, being situated entirely within Pinellas County, Florida; and

WHEREAS, the Board of Supervisors of Eastlake Oaks Community Development District (hereinafter the "Board") seeks to implement Section 190.006(3)(A)(2)(c), Florida Statutes and to instruct the Pinellas County Supervisor of Elections (the "Supervisor") to conduct the District's General Elections; and

WHEREAS, the Supervisor has requested the District adopt a Resolution confirming the District's use of the Supervisor for the purpose of conducting the District's future supervisor elections in conjunction with the General Election; and

WHEREAS, the District desires to continue to use the Supervisor for the purpose of conducting the District's supervisor elections in conjunction with the General Election.

NOW, THEREFORE, BE IT RESOLVED BY THE BOARD OF SUPERVISORS OF THE EASTLAKE OAKS COMMUNITY DEVELOPMENT DISTRICT:

Section 1. The Board is currently made up of the following individuals Dan Saracki, Cheryl Asoian, Bogdan (Don) Nowacki, J.R. (Nick) Yagnik and Joseph Dinelli.

Section 2. The term of office for each member of the Board is as follows:

Dan Saracki	Seat 1	11/2014
Cheryl Asoian	Seat 2	11/2014
Bogdan (Don) Nowacki	Seat 3	11/2014
J.R. (Nick) Yagnik	Seat 4	11/2016
Joseph Dinelli	Seat 5	11/2016

Section 3. Seat 1, currently held by Dan Saracki, Seat currently held by Cheryl Asoian and Seat 3, currently held by Bogdan (Don) Nowacki, are scheduled for the General Election in November 2014.

Section 4. Pursuant to Section 190.006(8), Florida Statutes, members of the Board shall be entitled to receive for his or her services an amount not to exceed \$200 per meeting of the

Board, not to exceed \$4,800 per year per member.

Section 5. The term of office for the individuals to be elected to the Board in the November 2014 General Election is four years.

Section 6. The new Board members shall assume office on the second Tuesday following their election.

Section 7. The District hereby instructs the Supervisor to continue conducting the District's elections in conjunction with the General Election. The District understands it will be responsible to pay for its proportionate share of the General Election cost and agrees to pay same within a reasonable time after receipt of an invoice from the Supervisor.

PASSED AND ADOPTED THIS 10th DAY OF APRIL, 2014.

ATTEST:



Andrew Mendenhall, PMP
Secretary

**EASTLAKE OAKS COMMUNITY
DEVELOPMENT DISTRICT**

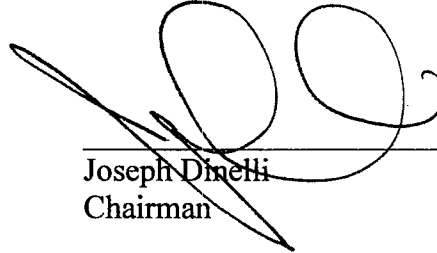

Joseph Dinelli
Chairman

EASTLAKE OAKS
Community Development District

Annual Operating and Debt Service Budget
Fiscal Year 2015

Version 1 - Proposed Budget:
(Printed on 4/1/2014)

RECEIVED
BOARD OF

2014 AUG - 7 AM 8:45

BOARD OF LOCAL
COMMISSIONERS
HAMILTON COUNTY FLORIDA

Prepared by:

SEVERN
TRENT
SERVICES

Table of Contents

	<u>Page #</u>
<u>OPERATING BUDGET</u>	
General Fund	
Summary of Revenues, Expenditures and Changes in Fund Balances	1 - 2
Budget Narrative	3 - 5
Exhibit A - Allocation of Fund Balances	6
 <u>DEBT SERVICE BUDGETS</u>	
Series 2008	
Summary of Revenues, Expenditures and Changes in Fund Balances	7
Amortization Schedules.....	8 - 9
Budget Narrative	10
 <u>SUPPORTING BUDGET SCHEDULES</u>	
2014-2015 Non-Ad Valorem Assessment Summary	11

Eastlake Oaks
Community Development District

Operating Budget
Fiscal Year 2015

EASTLAKE OAKS

Community Development District

General Fund

Summary of Revenues, Expenditures and Changes in Fund Balances
Fiscal Year 2015 Proposed Budget

ACCOUNT DESCRIPTION	ACTUAL FY 2013	ADOPTED BUDGET FY 2014	ACTUAL THRU FEB-2014	PROJECTED MAR - SEP-2014	TOTAL PROJECTED FY 2014	ANNUAL BUDGET FY 2015
REVENUES						
Interest - Investments	\$ 378	\$ 250	\$ 253	\$ 354	\$ 607	\$ 250
Net Incr (Decr) In FMV-Invest	191	-	-	-	-	-
Special Assmnts- Tax Collector	219,960	219,960	206,765	12,435	219,200	219,960
Special Assmnts- CDD Collected	733	733	731	-	731	733
Special Assmnts- Discounts	(8,121)	(8,798)	(8,366)	(432)	(8,798)	(8,798)
Other Miscellaneous Revenues	109	-	-	-	-	-
TOTAL REVENUES	213,250	212,145	199,383	12,357	211,740	212,145

EXPENDITURES**Administrative**

P/R-Board of Supervisors	5,800	7,000	2,800	3,000	5,800	7,000
FICA Taxes	444	536	214	230	444	536
ProfServ-Dissemination Agent	-	1,000	-	1,000	1,000	1,000
ProfServ-Engineering	827	1,500	-	1,000	1,000	1,500
ProfServ-Legal Services	1,829	1,500	2,885	2,000	4,885	2,000
ProfServ-Mgmt Consulting Serv	48,008	48,008	20,003	28,005	48,008	48,008
ProfServ-Special Assessment	3,881	3,881	3,881	-	3,881	3,881
ProfServ-Trustee	4,489	3,800	2,200	1,600	3,800	3,800
Auditing Services	4,350	4,350	4,350	-	4,350	4,350
Postage and Freight	405	600	181	253	434	500
Rental - Meeting Room	100	450	-	-	-	450
Insurance - General Liability	4,944	5,686	4,833	-	4,833	5,686
Printing and Binding	1,123	1,000	521	729	1,250	1,000
Legal Advertising	1,761	1,000	-	1,000	1,000	1,000
Miscellaneous Services	1,235	1,540	548	767	1,315	1,540
Misc-Assessmnt Collection Cost	2,926	4,399	4,008	391	4,399	4,399
Office Supplies	66	200	-	100	100	200
Annual District Filing Fee	175	175	175	-	175	175
Total Administrative	82,363	86,625	46,599	40,075	86,674	87,025

Field

Contracts-Lake and Wetland	7,800	7,200	3,000	4,200	7,200	7,200
Contracts-Landscape	35,958	33,300	13,875	19,425	33,300	33,300
Contracts-Pools	8,142	7,140	2,975	4,165	7,140	7,140
Contracts-Cleaning Services	2,263	2,100	875	1,225	2,100	2,100
Electricity - Streetlighting	16,183	19,000	7,910	11,074	18,984	18,000
Utility - Water	4,421	6,800	1,076	1,506	2,582	5,000
R&M-Renewal and Replacement	699	1,500	-	500	500	1,500
R&M-Irrigation	2,686	6,400	1,114	1,560	2,674	5,000
R&M-Ponds	-	1,800	-	500	500	1,800
R&M-Pools	2,152	1,500	-	500	500	1,500
Misc-Contingency	20,451	38,780	15,541	21,757	37,298	42,580
Total Field	100,755	125,520	46,366	66,412	112,778	125,120

EASTLAKE OAKS

Community Development District

General Fund

Summary of Revenues, Expenditures and Changes in Fund Balances
Fiscal Year 2015 Proposed Budget

ACCOUNT DESCRIPTION	ACTUAL FY 2013	ADOPTED BUDGET FY 2014	ACTUAL THRU FEB-2014	PROJECTED MAR - SEP-2014	TOTAL PROJECTED FY 2014	ANNUAL BUDGET FY 2015
TOTAL EXPENDITURES	183,118	212,145	92,965	106,488	199,453	212,145
Excess (deficiency) of revenues						
Over (under) expenditures	30,132	-	106,418	(94,131)	12,287	-
OTHER FINANCING SOURCES (USES)						
Operating Transfers-Out	(1,420)	(12,155)	-	-	-	(12,155)
Contribution to (Use of) Fund Balance	-	(12,155)	-	-	-	(12,155)
TOTAL OTHER SOURCES (USES)	(1,420)	(24,310)	-	-	-	(24,310)
Net change in fund balance	28,712	(12,155)	106,418	(94,131)	12,287	(12,155)
FUND BALANCE, BEGINNING	172,168	200,880	200,880	-	200,880	213,167
FUND BALANCE, ENDING	\$ 200,880	\$ 188,725	\$ 307,298	\$ (94,131)	\$ 213,167	\$ 201,012

**Budget Narrative
Fiscal Year 2015****REVENUES****Interest-Investments**

The District earns interest on its operating and investment accounts.

Special Assessments-Tax Collector

The District will levy a Non-Ad Valorem assessment on all the assessable property within the District in order to pay for the operating expenditures during the Fiscal Year.

Special Assessment – District Collected

The District will collect a Non-Ad Valorem assessment on all the un-platted parcels within the District in support of the overall fiscal year budget.

Special Assessments-Discounts

Per Section 197.162, Florida Statutes, discounts are allowed for early payment of assessments. The budgeted amount for the fiscal year is calculated at 4% of the anticipated Non-Ad Valorem assessments.

EXPENDITURES**Administrative****P/R-Board of Supervisors**

Chapter 190 of the Florida Statutes allows for members of the Board of Supervisors to be compensated \$200 per meeting at which they are in attendance. The amount for the Fiscal Year is based upon all supervisors attending all six of the meetings.

FICA Taxes

Payroll taxes on Board of Supervisors compensation. The budgeted amount for the fiscal year is calculated at 7.65% of the total Board of Supervisor's payroll expenditures.

Professional Services – Dissemination Agent

The District is required by the Securities and Exchange Commission to comply with rule 15c2-12(b)-(5), which relates additional reporting requirements for unrelated bond issues and is performed by Prager and Sealy. The budgeted amount for the fiscal year is based on standard fees charged for this service.

Professional Services-Engineering

The District's engineer provides general engineering services to the District, i.e. attendance and preparation for monthly board meetings when requested, review of invoices, and other specifically requested assignments.

Professional Services-Legal Services

The District's Attorney, Hopping, Green & Sams, provides general legal services to the District, i.e., attendance and preparation for monthly Board meetings, review of contracts, review of agreements and resolutions, and other research as directed or requested by the Board of Supervisors and the District Manager.

Professional Services-Management Consulting Services

The District receives Management, Accounting and Administrative services as part of a Management Agreement with Severn Trent Environmental Services, Inc. Also included are costs for Information Technology charges to process all of the District's financial activities, i.e. accounts payable, financial statements, budgets, etc., on a main frame computer owned by Severn Trent in accordance with the management contract and the charge for rentals. The budgeted amount for the fiscal year is based on the contracted fees outlined in Exhibit "A" of the Management Agreement.

**Budget Narrative
Fiscal Year 2015****EXPENDITURES****Administrative** (continued)**Professional Services - Special Assessment**

The District will be billed annually for calculating and levying the annual operating and maintenance, and debt service assessments, as provided by Severn Trent Management Services.

Professional Services- Trustee

The District pays US Bank an annual fee for trustee services on the Series 2008 Bond. The budgeted amount for the fiscal year is \$3,500 plus any out-of-pocket expenses.

Auditing Services

The District is required to conduct an annual audit of its financial records by an Independent Certified Public Accounting Firm. The budgeted amount for the fiscal year is based on contracted fees from an existing engagement letter from Berger, Toombs and Elam.

Postage and Freight

Actual postage and/or freight used for District mailings including agenda packages, vendor checks and other correspondence.

Insurance-General Liability

The District's General Liability & Public Officials Liability Insurance policy is with Florida Municipal Insurance Trust. The budgeted amount allows for a projected increase in the premium due to market uncertainty.

Rental-Meeting Room

The District pays a fee for meeting facilities at Holiday Inn Express where District Board meetings and workshops are held.

Printing and Binding

Copies used in the preparation of agenda packages, required mailings, and other special projects.

Legal Advertising

The District is required to advertise various notices for monthly Board meetings and other public hearings in a newspaper of general circulation.

Miscellaneous Services

This includes monthly bank charges and any other miscellaneous expenses that may be incurred during the year.

Miscellaneous-Assessment Collection Costs

The District reimburses the Pinellas County Tax Collector for her or his necessary administrative costs. Per the Florida Statutes, administrative costs shall include, but not be limited to, those costs associated with personnel, forms, supplies, data processing, computer equipment, postage, and programming. The District also compensates the Tax Collector for the actual cost of collection or 2% on the amount of special assessments collected and remitted, whichever is greater. The fiscal year budget for collection costs was based on a maximum of 2% of the anticipated assessment collections.

Office Supplies

Supplies used in the preparation and binding of agenda packages, required mailings, and other special projects.

Annual District Filing Fee

The District is required to pay an annual fee of \$175 to the Department of Economic Opportunity.

Budget Narrative
Fiscal Year 2015**EXPENDITURES****Field****Contracts-Lake and Wetland**

Scheduled maintenance consists of monthly inspections and treatment of aquatic weeds and algae within CDD water ponds. The District has currently a contract with American Ecosystems for a monthly fee of \$600.

Contracts-Landscape

The District currently has a contract with Landscape Maintenance Professional, Inc. to maintain the landscaping, edging, pruning, fertilization and irrigation system of the common areas within the District. The amount is based on proposed contract amounts and prior year's costs.

Contracts-Pools

Scheduled maintenance consists of monthly inspections and treatment of pool within CDD. The District change the contract with Pip's Pool Service for a monthly fee of \$595.

Contracts-Cleaning Services

Scheduled maintenance consists of 12 times per year. Cleaning services provided for the District's common areas. The District has currently a contract Prestige Janitorial Service for a monthly fee of \$175.

Electricity – Street lighting

The District will incur electrical usage of streetlights within the District.

Utility - Water

The District currently has utility accounts with the City of Oldsmar. Usage consists of water, sewer and reclaimed water services.

R&M-Irrigation System

Unscheduled maintenance to irrigation system which includes; inspections, adjustments to controller and irrigation heads, minor system repairs and replacement of system components and purchase of irrigation supplies.

R&M- Renewal and Replacement

This represents the cost to replace any landscape materials within the District.

R&M-Ponds

Unscheduled maintenance consists of inspections and treatment of ponds and lakes.

R&M-Pools

This includes any repairs and maintenance that may be incurred during the year by the District.

Miscellaneous - Contingency

This contingency represents the potential excess of unscheduled maintenance expenses not included in budget categories or not anticipated in specific line items.

OTHER FINANCING SOURCES (USES)**Operating Transfers-Out**

Transfer from the General Fund to Debt Service Fund to cover the annual payment on the Lennar Notes Payable.

EASTLAKE OAKS

Community Development District

General Fund

Exhibit "A"
Allocation of Fund Balances**AVAILABLE FUNDS**

	<u>Amount</u>
Beginning Fund Balance - Fiscal Year 2015	\$ 213,167
Net Change in Fund Balance - Fiscal Year 2015	(12,155)
Total Funds Available (Estimated) - 9/30/2015	201,012

ALLOCATION OF AVAILABLE FUNDS***Nonspendable Fund Balance***

Prepaid Items	3,480
Subtotal	3,480

Assigned Fund Balance

Operating Reserve - One Quarter Operating Capital	53,036	(1)
Reserves - Recreational Facilities	28,330	(2)
Reserves - Ponds	28,830	(2)
Subtotal	110,196	

Total Allocation of Available Funds	113,676
--	----------------

Total Unassigned (undesignated) Cash	\$ 87,336
---	------------------

Notes

(1) Represents approximately 3 months of operating expenditures

(2) Represents reserve from previous years

Eastlake Oaks
Community Development District

Debt Service Budget
Fiscal Year 2015

EASTLAKE OAKS

Community Development District

Series 2008 Debt Service Fund

Summary of Revenues, Expenditures and Changes in Fund Balances
Fiscal Year 2015 Proposed Budget

ACCOUNT DESCRIPTION	ACTUAL FY 2013	ADOPTED BUDGET FY 2014	ACTUAL THRU FEB-2014	PROJECTED MAR - SEP-2014	TOTAL PROJECTED FY 2014	ANNUAL BUDGET FY 2015
REVENUES						
Interest - Investments	\$ 22	\$ 1	\$ 3	\$ 4	\$ 7	\$ 1
Special Assmnts- Tax Collector	135,828	135,828	127,680	8,148	135,828	135,828
Special Assmnts- Discounts	(5,015)	(5,433)	(5,166)	(267)	(5,433)	(5,433)
TOTAL REVENUES	130,835	130,396	122,517	7,885	130,402	130,396
EXPENDITURES						
<i>Administrative</i>						
Misc-Assessmnt Collection Cost	1,776	2,717	2,450	163	2,613	2,717
Total Administrative	1,776	2,717	2,450	163	2,613	2,717
<i>Debt Service</i>						
Principal Debt Retirement	105,000	110,000	-	110,000	110,000	115,000
Principal Line of Credit/Note	-	11,500	-	11,500	11,500	12,500
Interest Expense	23,655	19,298	9,649	9,649	19,298	14,733
Total Debt Service	128,655	140,798	9,649	131,149	140,798	142,233
TOTAL EXPENDITURES	130,431	143,515	12,099	131,312	143,411	144,950
Excess (deficiency) of revenues						
Over (under) expenditures	404	(13,119)	110,418	(123,426)	(13,008)	(14,554)
OTHER FINANCING SOURCES (USES)						
Interfund Transfer - In	1,420	12,155	-	-	-	12,155
Contribution to (Use of) Fund Balance	-	(964)	-	-	-	(2,399)
TOTAL OTHER SOURCES (USES)	1,420	11,191	-	-	-	9,757
Net change in fund balance	1,824	(964)	110,418	(123,426)	(13,008)	(2,399)
FUND BALANCE, BEGINNING	11,791	13,615	13,615	-	13,615	607
FUND BALANCE, ENDING	\$ 13,615	\$ 12,651	\$ 124,033	\$ (123,426)	\$ 607	\$ (1,792)

EASTLAKE OAKS

Community Development District

Series 2008 Debt Service Fund

AMORTIZATION SCHEDULE

Period Ending	Principal		Coupon	Interest	Debt Service	Annual Debt Service
11/1/2014	355,000		4.15%	7,366.25	7,366.25	
5/1/2015	355,000	115,000	4.15%	7,366.25	122,366.25	129,732.50
11/1/2015	240,000		4.15%	4,980.00	4,980.00	
5/1/2016	240,000	120,000	4.15%	4,980.00	124,980.00	129,960.00
11/1/2016	120,000		4.15%	2,490.00	2,490.00	
5/1/2017	120,000	120,000	4.15%	2,490.00	122,490.00	124,980.00
	\$ 355,000			\$ 29,673	\$ 384,673	\$ 384,673

EASTLAKE OAKSCommunity Development District

AMORTIZATION SCHEDULE
NOTES PAYABLE

DATE	PAYMENT	BALANCE
		\$156,500.00
4/1/1999	\$7,500.27	\$148,999.73
4/1/2000	\$4,068.85	\$144,930.88
5/1/2001	\$4,770.57	\$140,160.31
5/1/2002	\$6,793.31	\$133,367.00
5/1/2003	\$15,479.00	\$117,888.00
5/1/2004	\$6,000.00	\$111,888.00
5/1/2005	\$6,000.00	\$105,888.00
5/1/2006	\$6,500.00	\$99,388.00
5/1/2007	\$7,000.00	\$92,388.00
5/1/2013	\$10,500.00	\$38,388.00
5/1/2014	\$11,500.00	\$26,888.00
5/1/2015	\$12,500.00	\$14,388.00
5/1/2016	\$9,671.00	\$4,717.00
\$54,171.00		

**Budget Narrative
Fiscal Year 2015****OTHER FINANCING SOURCES (USES)****Operating Transfers-Out**

Transfer from the General Fund to Debt Service Fund to cover the annual payment on the Lennar Notes Payable.

REVENUES**Interest-Investments**

The District earns interest income on their trust accounts with US Bank.

Special Assessments-Tax Collector

The District will levy a Non-Ad Valorem assessment on all the assessable property within the District in order to pay for the debt service expenditures during the Fiscal Year.

Special Assessments-Discounts

Per Section 197.162, Florida Statutes, discounts are allowed for early payment of assessments. The budgeted amount for the fiscal year is calculated at 4% of the anticipated Non-Ad Valorem assessments.

EXPENDITURES**Administrative****Miscellaneous-Assessment Collection Cost**

The District reimburses the Pinellas County Tax Collector for her or his necessary administrative costs. Per the Florida Statutes, administrative costs shall include, but not be limited to, those costs associated with personnel, forms, supplies, data processing, computer equipment, postage, and programming. The District also compensates the Tax Collector for the actual cost of collection or 2% on the amount of special assessments collected and remitted, whichever is greater. The FY2015 budget for collection costs was based on a maximum of 2% of the anticipated assessment collections.

Principal Debt Retirement

The District pays regular principal payments annually in order to pay down/retire the debt service.

Principal Line of Credit/Note

The District pays an annual note payment in order to pay down/retire Line of Credit.

Interest Expense

The District pays interest expense on the debt service bonds twice a year.

OTHER FINANCING SOURCES (USES)**Interfund Transfer-In**

Transfer from the General Fund to Debt Service Fund to cover the annual payment on the Lennar Notes Payable.

Eastlake Oaks

Community Development District

Supporting Budget Schedule

Fiscal Year 2015

EASTLAKE OAKS

Community Development District

*All Funds***Comparison of Assessment Rates
Fiscal Year 2015 vs. Fiscal Year 2014**

General Fund			Debt Service			Total Assessments per Unit			Units
FY 2015	FY 2014	Percent Change	FY 2015	FY 2014	Percent Change	FY 2015	FY 2014	Percent Change	
\$761.11	\$761.11	0.0%	\$481.66	\$481.66	0%	\$1,242.77	\$1,242.77	0.0%	289
									289

Swade, Janice

From: Slaughter, Mona
Sent: Thursday, February 13, 2014 8:43 AM
To: Swade, Janice
Subject: FW: Eastlake Oaks - Fence

Mona Slaughter
District Recording Secretary
Severn Trent Services

T: +1 954 753 5841

E: Mona.Slaughter@STServices.com

www.severntrentms.com

From: Mendenhall, Andy
Sent: Tuesday, February 11, 2014 1:42 PM
Subject: Eastlake Oaks - Fence

Here is a brief summary.

Danielle	\$9,711.	184lf
Superior	\$5,966.	171lf
McConnie	\$8,475	181lf
Allegiance	\$45,582	97lf

Notes:

- One more bid update coming from Big Dog Fence
- Allegiance is significantly higher as it include the Card Reading system, I had reached out them to discuss segmenting out their bid but have not heard back yet. I've also reached out to them on measurements as they are missing something (we discussed this at the last meeting).

Contract



McConnie Fence Co.

4707 South 30th Ave. • Tampa, Florida 33619

(813) 247-3827 - Fax (813) 247-2546

PRESSURE TREATED CARIBBEAN PINE FENCE
P.V.C. • ALUMINUM • CHAIN LINK • WROUGHT IRON



FAMILY
OWNED & OPERATED
SINCE 1973

PROPOSAL SUBMITTED TO <i>East Lake Oaks HOA</i>		BUYER IS: <input type="checkbox"/> Property Owner <input type="checkbox"/> Not Property Owner	DATE <i>4/23/14</i>
STREET		JOB NAME <i>Pool & Playground Fence Replacement</i>	
CITY, STATE AND ZIP CODE			
PHONE <i>941-1116-7102</i>	PHONE	PHONE	CONTACT <i>Andy</i>

We hereby submit specifications and estimates for

WOOD/P.V.C./ALUM./CHAIN LINK FENCE

NO. OF FEET *226*
HEIGHT *6'*
STYLE *3 RAIL STEEL MONTAGE PLUS*
W. GATE *1-48" x 1-48"*
DRIVE GATE *4' x 14'*
PICKET *3/4" x 3/4"*
RAIL *1 1/2" x 1 1/2"*
POST *2 1/2" x 2 1/2" x 3" x 3"*

ONE YEAR WARRANTY ON LABOR PROVIDING
McCONNIE FENCE SIGN REMAINS ON FENCE.

FIFTEEN (15) YEAR LIMITED WARRANTY AGAINST
TERMITE & ROTTING FOR PRESSURE TREATED
WOOD ONLY. AS LONG AS FENCE IS NOT BURIED.
SEE MANUFACTURER'S WARRANTY FOR PVC
AND ALUMINUM. WARRANTY MUST BE FILED
WITH MANUFACTURER.

ADD'L SPEC.

POST SPACED _____
TOP RAIL _____
TERMINAL POST _____
LINE POST _____
WALK GATE POST _____
DRIVE GATE POST _____
GATE FRAME _____
BARB WIRE _____
TENSION WIRE _____
GAUGE ☐ 9 ☐ 11 1/2
KNUCKLED UP ☐ BARB UP ☐

TOP OF FENCE TO
FOLLOW GROUND ☐
TO BE LEVEL WITH
LOWEST GRADE ☐
TO BE LEVEL WITH
HIGHEST GRADE ☐
ALL SIDES TO FACE OUT ☐
ALL SIDES TO FACE IN
EXCEPT SIDES THAT
FACE STREET ☐
FENCE TO FACE AS
NOTED BELOW ☐

NOTE: NOT Responsible for cut or breakage to sprinkler lines, heads, wiring, electrical,
cable, telephone or anything else not marked by Sunshine One or Customer. Owner is
responsible for ensuring that fence meets deed or historical restrictions. _____ INIT.*

QUANTITY	
<i>226</i>	<i>6' HIGH BLACK</i>
	<i>3 RAIL STEEL</i>
	<i>MONTAGE PLUS w/</i>
	<i>PRESSED SPEAR</i>
<i>1</i>	<i>6' x 48" GATE w/</i>
	<i>DOUBLE LOCK BOX</i>
<i>1</i>	<i>6' x 48" GATE w/</i>
	<i>DOUBLE LOCK BOX</i>
<i>226</i>	<i>TAKE DOWN &</i>
	<i>HAVE OLD CHAIN</i>
	<i>LINK FENCE</i>

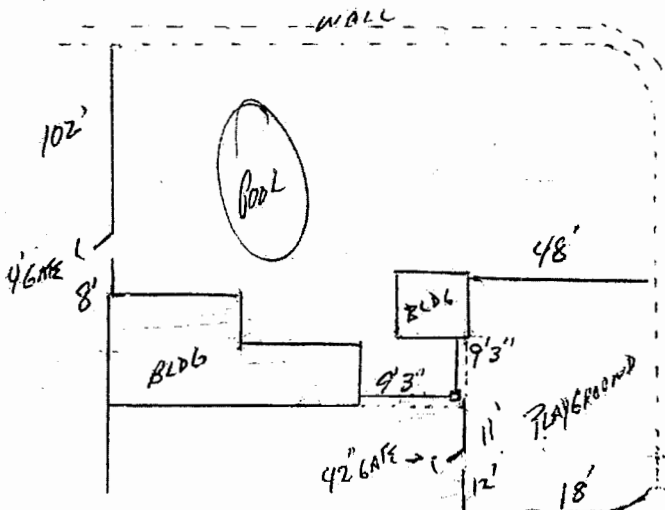

FENCE LINE CLEAR OF OBSTRUCTION ☐

We Propose hereby to furnish material and labor complete in accordance with above specifications, for the sum of:

Thirteen Thousand Eight Hundred Twenty Dollars (\$ *13,820.00*)
Payment to be made as follows: *30* % Down, and Balance Due on Completion

All material is guaranteed to be as specified. All work is to be completed in a workmanlike manner according to standard practices. Any alteration or deviation from the above or attached specifications involving extra costs will be executed only upon written orders, and will become an extra charge over and above the estimate. All agreements contingent upon strikes, accidents or delays beyond our control. Owner to carry fire, tornado and other necessary insurance. Our workers are fully covered by Workmen's Compensation Insurance. Not responsible for underground sprinklers, or water, electrical and cable lines. Owner responsible for locating property markers.

Authorized Signature *Ray Maitner*
This Proposal may be withdrawn by us within *30* days.

All sales are not final and all material remains the property of McConnie Fence Company, until paid in full. In default of any payment by the purchaser, the seller may take possession of goods without legal process. If seller requires an attorney's services in order to institute legal action of any kind, in the event of default, then buyer agrees to pay attorney's fees of seller, including all costs of collection. Unpaid invoices more than 2 weeks past due will be assessed a \$25.00 late fee plus interest (1 1/2% monthly). Warranty work can not be performed until fence is paid in full.

Acceptance of Proposal - The above prices, specifications and conditions are satisfactory and are hereby accepted. You are authorized to do the work as Specified. If McConnie Fence comes out to perform the work and the job is not ready, there will be a \$150.00 trip charge added to the contract amount. Payment will be made as outlined above. If paid by Mastercard or Visa, the signature below will also act as the authorized signature for credit card payment. Please specify which direction the fence is to face. If not indicated on drawing, the fence will be installed with the good side out on all sides. **Before signing, Please Initial the (2) Asterisks.**

Signature *Ray Maitner* Date *4/23/14*

McCONNIE FENCE CO.
4707 SOUTH 30TH AVE.
TAMPA, FLORIDA 33619
(813) 247-3827

4/8/14
DATE

C/O SEVERAL TRENT
CHANGE ORDER

EAST LAKE DAKS
(OWNER/CONTRACTOR)

4/18/14
DATE

POOL FENCE REPLACEMENT
(PROJECT)

(JOB NUMBER)

WE HEREBY AUTHORIZE McCONNIE FENCE TO MAKE THE
FOLLOWING ADDITIONS/DELETIONS TO THE ABOVE REFERENCED JOB.

ADD 45'-6' HIGH 3 RAIL BLACK STEEL MONTAGE PLUS
FENCE W/ PRESSED SPEARS

ADD 1-6' X 42" GATE W/ DOUBLE LOCK BOX

ADD 45' TAKE DOWN & HAUL OLD CHAIN LINK FENCE

CONTRACT ADDITIONS \$ 3225⁰⁰

CONTRACT DELETIONS Ø

APPROVED: X
(OWNER/CONTRACTOR)

4
DATE

b
(NAME & POSITION)

P.V.C. • ALUMINUM • CHAIN LINK • WROUGHT IRON

OWNED & OPERATED
SINCE 1973

PROPOSAL SUBMITTED TO

BUYER IS:

DATE

STREET

JOB NAME

CITY, STATE AND ZIP CODE

PHONE

PHONE

PHONE

CONTACT

We hereby submit specifications and estimates for

WOOD/P.V.C./ALUM./CHAIN LINK FENCE.

NO. OF FEET

HEIGHT

STYLE

W. GATE

DRIVE GATE

PICKET

RAIL

POST

ONE YEAR WARRANTY ON LABOR PROVIDING
McCONNIE FENCE SIGN REMAINS ON FENCE.

FIFTEEN (15) YEAR LIMITED WARRANTY AGAINST
TERMITE & ROTTING FOR PRESSURE TREATED
WOOD ONLY. AS LONG AS FENCE IS NOT BURIED.
SEE MANUFACTURER'S WARRANTY FOR PVC
AND ALUMINUM. WARRANTY MUST BE FILED
WITH MANUFACTURER.

ADD'L SPEC.

POST SPACED

TOP RAIL

TERMINAL POST

LINE POST

WALK GATE POST

DRIVE GATE POST

GATE FRAME

BARB WIRE

TENSION WIRE

GAUGE

KNUCKLED UP

TOP OF FENCE TO
FOLLOW GROUND

TO BE LEVEL WITH
LOWEST GRADE

TO BE LEVEL WITH
HIGHEST GRADE

ALL SIDES TO FACE OUT

ALL SIDES TO FACE IN
EXCEPT SIDES THAT
FACE STREET

FENCE TO FACE AS
NOTED BELOW

NOTE: NOT Responsible for cut or breakage to sprinkler lines, heads, wiring, electrical, cable, telephone or anything else not marked by Sunshine One or Customer. Owner is responsible for ensuring that fence meets deed or historical restrictions. _____ INIT.*

QUANTITY

181	6' BLACK 3
	RAIL FENCE
	W/ PRESSED
	SPEAR
1	6'x48' GATE
	W/ DOUBLE
	LOCK BOX
181	TAKE DOWN
	& NAUL OLD
	CHAIN LINK
	FENCE
(A)	ALUMINUM
	#75959
(B)	STEEL
	#84959

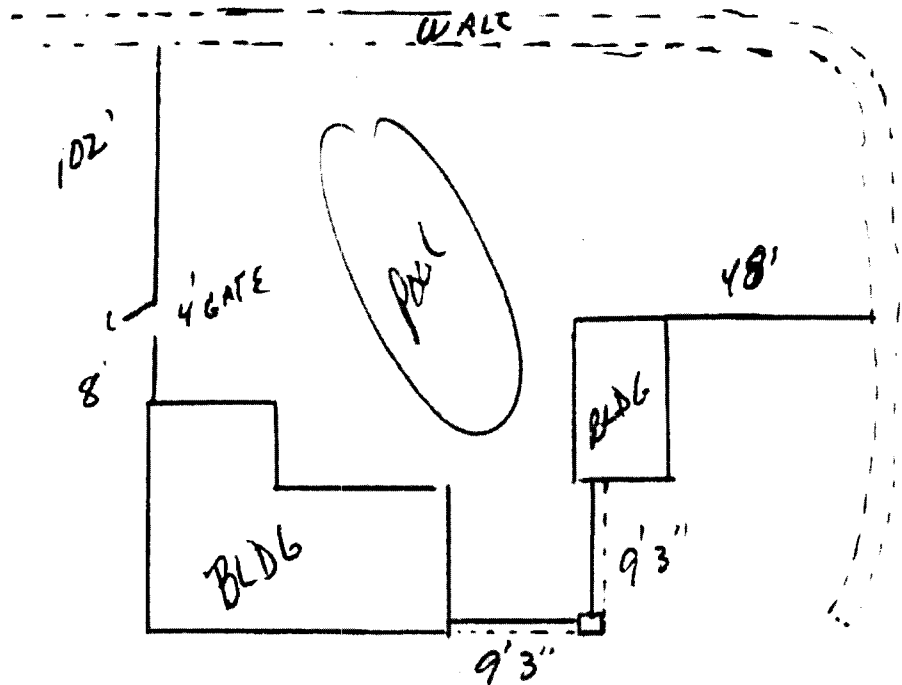

FENCE LINE CLEAR OF OBSTRUCTION

We Propose hereby to furnish material and labor - complete in accordance with above specifications, for the sum of:

Dollars (\$)

Payment to be made as follows: 30 % Down, and Balance Due on Completion

All material is guaranteed to be as specified. All work is to be completed in a workmanlike manner according to standard practices. Any alteration or deviation from the above or attached specifications involving extra costs will be executed only upon written orders, and will become an extra charge over and above the estimate. All agreements contingent upon strikes, accidents or delays beyond our control. Owner to carry fire, tornado and other necessary insurance. Our workers are fully covered by Workmen's Compensation Insurance. Not responsible for underground sprinklers, or water, electrical and cable lines. Owner responsible for locating property markers.

Authorized
Signature

This Proposal may be withdrawn by us within 30 days.

Acceptance of Proposal - The above prices, specifications and conditions are satisfactory and are hereby accepted. You are authorized to do the work as Specified. If McConnie Fence comes out to perform the

PROPOSAL SUBMITTED TO

BUYER IS:

DATE

STREET

JOB NAME

CITY, STATE AND ZIP CODE

PHONE

PHONE

PHONE

CONTACT

We hereby submit specifications and estimates for

WOOD/P.V.C./ALUM./CHAIN LINK FENCE

NO. OF FEET

HEIGHT

STYLE

W. GATE

DRIVE GATE

PICKET

RAIL

POST

ONE YEAR WARRANTY ON LABOR PROVIDING McCONNIE FENCE SIGN REMAINS ON FENCE.

FIFTEEN (15) YEAR LIMITED WARRANTY AGAINST TERMITE & ROTTING FOR PRESSURE TREATED WOOD ONLY. AS LONG AS FENCE IS NOT BURIED. SEE MANUFACTURER'S WARRANTY FOR PVC AND ALUMINUM. WARRANTY MUST BE FILED WITH MANUFACTURER.

ADD'L SPEC.

POST SPACED

TOP RAIL

TERMINAL POST

LINE POST

WALK GATE POST

DRIVE GATE POST

GATE FRAME

BARB WIRE

TENSION WIRE

GAUGE

KNUCKLED UP

☐ 9☐ 11 1/2☐BARB UP ☐TOP OF FENCE TO FOLLOW GROUND ☐TO BE LEVEL WITH LOWEST GRADE ☐TO BE LEVEL WITH HIGHEST GRADE ☐ALL SIDES TO FACE OUT ☐

ALL SIDES TO FACE IN EXCEPT SIDES THAT FACE STREET

FENCE TO FACE AS NOTED BELOW ☐

NOTE: NOT Responsible for cut or breakage to sprinkler lines, heads, wiring, electrical, cable, telephone or anything else not marked by Sunshine One or Customer. Owner is responsible for ensuring that fence meets deed or historical restrictions. INIT *

QUANTITY	
181	7' HIGH BLACK
	3 RAIL STEEL
	MONTAGE PLUS
	FENCE W/
	PRESSED SPEAR
1	7'x4' GATE W/
	DOUBLE LOCK BOX
181	TAKE DOWN &
	HAUL OUT FENCE

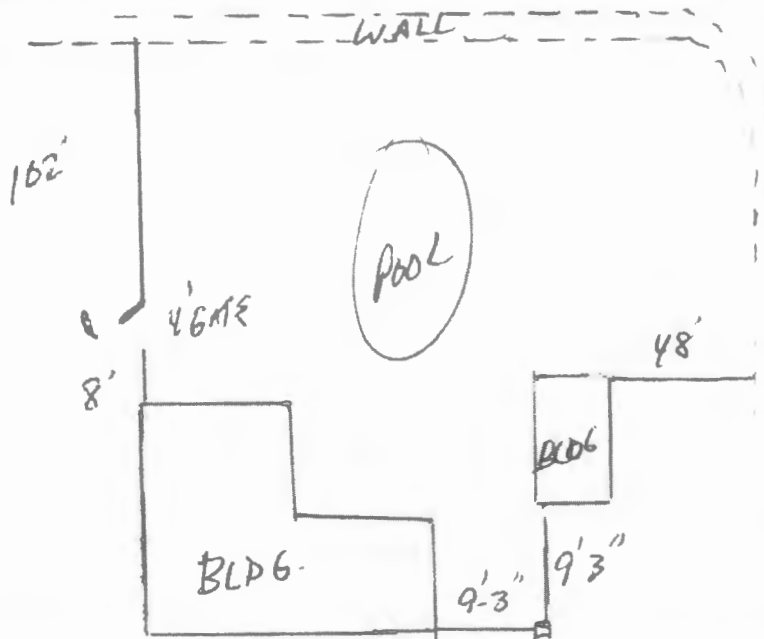
FENCE LINE CLEAR OF OBSTRUCTION ☐

We Propose

hereby to furnish material and labor - complete in accordance with above specifications, for the sum of:

Eleven Thousand Seven Hundred Seventy Dollars (\$ 11,770.00)

Payment to be made as follows: 30 % Down and Balance Due on Completion

All material is guaranteed to be as specified. All work is to be completed in a workmanlike manner according to standard practices. Any alteration or deviation from the above or attached specifications involving extra costs will be executed only upon written orders, and will become an extra charge over and above the estimate. All agreements contingent upon strikes, accidents or delays beyond our control. Owner to carry fire, tornado and other necessary insurance. Our workers are fully covered by Workmen's Compensation Insurance. Not responsible for underground sprinklers, or water, electrical and cable lines. Owner responsible for locating property markers.

Authorized

Signature

This Proposal may be withdrawn by us within 30 days.

Acceptance of Proposal

The above prices, specifications and conditions are satisfactory and are hereby accepted. You are authorized to do the work as Specified. If McConnie Fence comes out to perform the work and the job is not made, there will be a \$150.00 fee charge added.

McCONNIE FENCE CO.
4707 SOUTH 30TH AVE.
TAMPA, FLORIDA 33619
(813) 247-3827

4/8/14
DATE

CHANGE ORDER
NO SEVERN TRENT

EAST LAKE DAKS
(OWNER/CONTRACTOR)

4/18/14
DATE

POOL FENCE REPLACEMENT
(PROJECT)

(JOB NUMBER)

WE HEREBY AUTHORIZE McCONNIE FENCE TO MAKE THE
FOLLOWING ADDITIONS/DELETIONS TO THE ABOVE REFERENCED JOB.

ADD 45- 4' HIGH 3 RAIL BLACK STEEL MONTAGE, PLUS
FENCE W/ FLAT RAIL AT TOP

ADD 1- 4' X 42" GATE W/ DOUBLE LOCK BOX

ADD 45' TAKE DOWN & HAUL OLD CHAIN LINK FENCE

CONTRACT ADDITIONS 2795⁰⁰

CONTRACT DELETIONS Ø

APPROVED: X
(OWNER/CONTRACTOR)

6
DATE

D
(NAME & POSITION)

February 10, 2014



Eastlake Oaks CDD
Andy Mendenhall
210 N University Dr
Coral Springs, FL 33071

Job Site: Eastlake Oaks
1619 Graybark Dr
Oldsmar, FL 34677
Revised

Dear Andy,

Thank you for the opportunity to offer you an estimate for your outdoor project needs located at the job site listed above. Please accept this letter as our Proposal for your review.

Total Install:

\$9,711.00

- Install 184' of 72" Tall Black 3 Rail Avalon Style Industrial Commercial Grade Aluminum Fence with 2.5" x 2.5" x 8' x .075 posts
- 1, 72" x 48" Walk gate on 4" x 4" posts with lock box
- Take down and removal of 188' of green chain link fence
- 1 permit fee



- ❖ Customer to install own locking system
- ❖ Danielle fence is not responsible for any paver damage

Price includes tax, materials, and installation. Prior to finalizing contract a 50% deposit is required.

Danielle Fence Mfg. Co., Inc. will provide a Certificate of Liability Insurance and Workers' Compensation Certificate, and will maintain it fully in effect until completion of this contract.

Signature: _____

Date: _____

Cathy/PM

Headquarters, Showroom and Facility
4855 State Road 60 West
Mulberry, Florida 33860
Hillsborough County: 813.681.6181 / Fax 813.676.1109
Polk County: 863.425.3182 / Fax 863.425.5676
Toll Free: 800.255.6794

www.daniellefence.com

SUPERIOR FENCE & RAIL, INC.
Where Quality Matters!
1400 Starkey Rd., Largo, FL 33771
Phone: 727-536-1905
Fax: 727-585-8500
C10418

Superior Fence installers are not responsible for underground sprinklers, telephone, electrical, sewer or water lines.

CONTRACT

Phone Num: ERT	Date: 1-24-14	Contract #: 2231
Phone-Jobite: 102		
Cell: 813-411-1116	Sales Rep: MARK CALDWELL	
Contact Name: ANDY	Fax Number:	

Proposal To: **EAST LAKE DR. OF OLDEMAR**
Job Address: **1619 GRAY BARK DRIVE** City: **OLDEMAR** State: **FLA.** Zip: **33411**
Billing Address: _____ City: _____ State: _____ Zip: _____

<input type="checkbox"/> Level <input type="checkbox"/> Straight Top <input type="checkbox"/> Contour <input type="checkbox"/> Stepped
PVC Caps <input type="checkbox"/> Pyramid <input type="checkbox"/> New England <input type="checkbox"/> Federation <input type="checkbox"/> Gothic <input type="checkbox"/> Ball <input type="checkbox"/> Other <input type="checkbox"/> Alum Inserts in Gate Posts
<input type="checkbox"/> Lifetime non pro rated warranty on PVC
<input type="checkbox"/> 100% Virgin Vinyl material

Customers are responsible for removal of vegetation and debris from fence line.

FRAMEWORK <input type="checkbox"/> Galv <input type="checkbox"/> Color				CHAIN LINK FENCE				<input type="checkbox"/> K/K <input type="checkbox"/> K/T <input type="checkbox"/> T/K <input type="checkbox"/> T/T				SLATS		OTHERS	
FABRIC <input type="checkbox"/> Galv <input type="checkbox"/> Color				Line Posts: Size _____ Space _____ Gauge _____				Rails: Size _____ Gauge _____ T/M/B _____				Color _____		<input type="checkbox"/> 9GA Tension Wire <input type="checkbox"/> 7GA Tension Wire <input type="checkbox"/> Box Brace/Truss	
Footage	Ht.	Gauge	Mesh	Size	Space	Gauge	Size	Gauge	T/M/B	Size	Gauge	<input type="checkbox"/> Galv <input type="checkbox"/> Alum	Color	Type	Pattern
												<input type="checkbox"/> 3 Strands <input type="checkbox"/> 6 Strands			
												<input type="checkbox"/> 3 Strands <input type="checkbox"/> 6 Strands			
ORNAMENTAL / PVC FENCE (circle one)															
Footage	Style	HL	Size	Space	Gauge	Size	Space	Size	# of Rails	Color	GATES TYPE (circle one): SNG DBL SLIDE CANT O/H Quantity: _____ Posts: _____ x _____ Hinges: _____ Latch: _____ Frame Size: _____ ga				
171'	203	6'	2 1/2"	6'		4"	1 1/2"	11/16"	3	BLK	TYPE (circle one): SNG DBL SLIDE CANT O/H Quantity: _____ Posts: _____ x _____ Hinges: _____ Latch: _____ Frame Size: _____ ga				
WOOD FENCE															
Footage	Style	Ht.	Good Side	Type Wood	Size	Space	Size	# of	Size	Set In Concrete	MISC				
										<input checked="" type="checkbox"/> Yes <input type="checkbox"/> No	Electrical	SFR	Cust		
										<input type="checkbox"/> Yes <input type="checkbox"/> No	Water				
											Remove Fence				
											Haul Fence				
											Trench				

6' HIGH ALUM. DESIGN!

By execution of this document, Buyer acknowledges that he/she has read and understands the terms and conditions set forth on the reverse and front side hereof and within any attachments. Seller shall not be responsible for and Buyer shall hold harmless Superior Fence & Rail, Inc. from any and all damages or liabilities resulting from any cut or damaged lines including, but not limited to, gas, (water, sprinkler), electric, telephone, fiber optic, cable. Buyer shall comply with all applicable statutes and codes relating to the location of utility lines.

Accepted by Property Owner: _____
Date: _____
Sales Person: **MARK CALDWELL**
Cell: **813-411-1116**

Terms: Balance due upon completion.

FOR THE SUM OF: **\$5966.00**

☒ IF SFR Tax: **\$110.00**

Bldg. Permit: **\$110.00**

TOTAL: **\$5966.00**

Fee: **\$0.00**

Grand Total: **\$5966.00**

Down Payment: **\$2983.00**

BALANCE: **\$2983.00**

Exp. Date: _____

Add 3% To Total Sum For Credit Card Fee.



Allegiance Development, Inc.

***P.O Box 1055
Dunedin, Florida 34697***

***Phone 727-584-1370
Fax 727-449-1690***

Florida State Certified General Contractors License# CGC1518539

***Date:** December 1, 2013*

***Proposal #** 120113-11-MG*

***Submitted To:** Eastlake Oaks CDD
Oldsmar, Florida 34677*

***Attention:** Dan Saracki & Andy Mendenhall*

***Phone:** 813-928-7077*

***Job Location:** Eastlake Oaks Pool House Fencing and Access Control Project*

- *****
- FABRICATE AND INSTALL ALL STEEL CONSTRUCTED FENCE AND GATES
 - HOT DIP GALVANIZE AFTER FABRICATION
 - MAIN GATE DETAIL E-2
 - GATE POSTS
 - FENCE PANELS
 - AREAS DETAIL E-3
 - 97 Ft. - FENCE AREA - 6 Ft. TALL - 3 HORIZONTALS PER
 - DETAIL E-1 LINE POST
 - PLAYGROUND AREA [TO POOL CODE - 5 Ft. HEIGHT]
 - WALK GATE
 - GATE POST
 - FENCE LINE POST
 - HOT DIP GALVANIZE
 - PAINT BLACK
 - INSTALLATION OF ABOVE
 - FOR AN ADDITIONAL AREA THAT WOULD
 - ALLOW A NEW ACCESS TO THE PLAYGROUND FROM THE POOL AREA
 - 44 Ft. OF FENCE
 - [6] LINE POST
 - [1] WALK GATE
 - [2] GATE POST
 - [1] CLOSURE
 - GALVANIZE
 - PAINT BLACK
 - INSTALLATION
-

Card Access for Main Pool Pedestrian Gate.

- DSX 1020NV single door controller: Up to 65,000 users
- M62 1200LB Securitron magnetic lock for pedestrian gate: (face drilled)
- Z-bracket Adjustable:
- 1- EEB2 Exit buttons with 30sec timer:
- 1- UL Listed weather box for exit button:
- 1- WCC weather cover for exit button:
- Proximity Readers:
- BPS 12-1 output UL power supply for mag locks with battery backup for club house:
- Batteries for Cat controller and Power supply:
- DSX power supply:
- DSX dial up modem for remote programming:
- DSXWIN Software:
- Labor, Cable and mounting hardware to install electronics:

TO BE PROVIDED BY OWNER:

Dedicated phone line for Club house Access Control panel.

Cards sold separately at \$4.50 each + TAX & FREIGHT: min order 100 (Special pricing for initial order)

QTY: _____ AUTHORIZED SIGNATURE: _____

Key Fobs sold separately at: \$6.50 each + tax (minimum order 100) Special price for initial order only.

QTY: _____ AUTHORIZED SIGNATURE: _____

The cost of permits are included in the price quoted below

All material and workmanship is guaranteed for (18) months.

The sum quoted is based on having access to the areas to complete the work in not more than (6) move-ins/sections. There will be an additional charge for additional move-ins.

Payment Terms: 50% upon commencement of work then 50% upon completion of the project

We propose to hereby furnish material and labor in accordance with the above specifications for the sum of:
Forty Five Thousand Five Hundred and Eighty Two Dollars and 00/100-----(\$ 45,582.00)

Authorized Signature: _____

Michael P. Godfrey

MICHAEL GODFREY, PRESIDENT

Date of Acceptance: _____

Signature: _____

- NOTES:
1. MATERIAL IS HOT DIPPED GALVANIZED STEEL
 2. PRIMED AND PAINTED

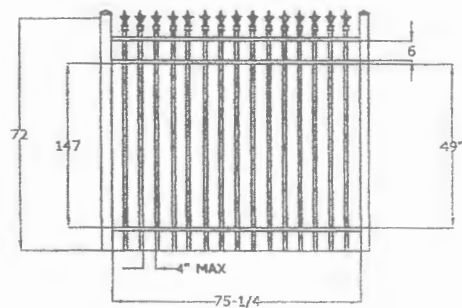

ENLARGED PANEL

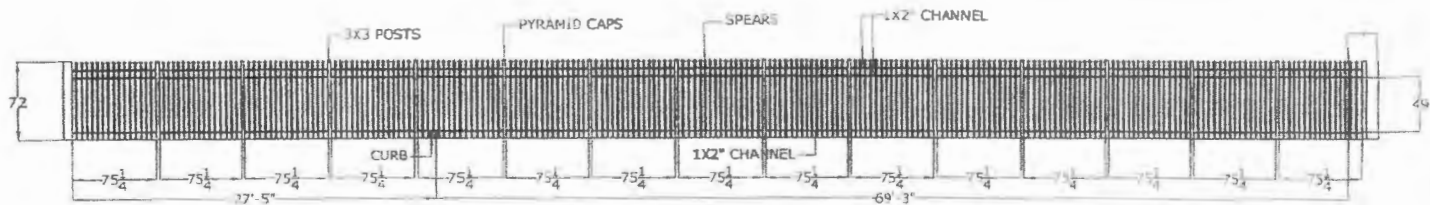

ORNAMENTAL
DESIGN IRONWORKS, INC.
ONE FOURTH AVENUE
SUITE 100
COLUMBIA, SC 29204

Phone: (803) 528-5448 Fax: (803) 528-4881

TITLE: POOL CODE FENCE
CUSTOMER: EAST LAKE OAKS

JOB NO.: EAST LAKE OAKS

DRAWN BY: CES CRE'D BY:

SCALE: 1/8"=1'-0" DATE: 11-6-13

DWG. NO.: E-1 SHEET: OF

CAD FILE: REV:

- NOTES:
- 1. MATERIAL IS HOT DIPPED GALVANIZED STEEL
 - 2. PRIMED AND PAINTED

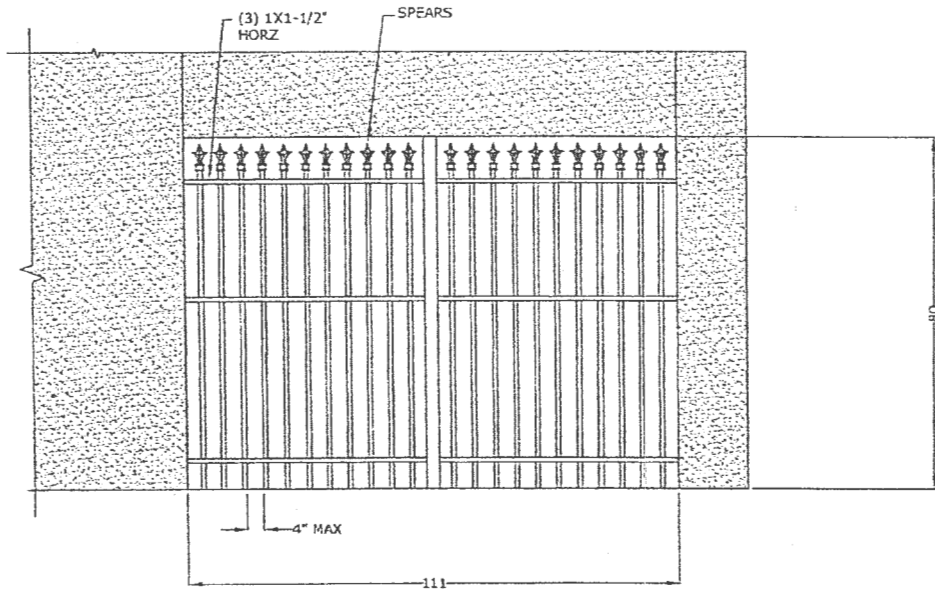

ORNAMENTAL FENCE & RAILWORK 1000 S. 10TH AVE. SUITE 100 DENVER, CO 80202 PHONE: 733-1234 FAX: 733-5678	DESCRIPTION:	FENCE PANELS	JOB NAME:	EAST LAKE OAKS	
	CUSTOMER:	EAST LAKE OAKS	DRAWN BY:	CES	CHK'D BY:
			SCALE:	1/2" = 1'0"	DATE: 11-5-13
			DWG. NO.:	E-3	SHT. OF

NOTES:

1. MATERIAL IS HOT DIPPED GALVANIZED STEEL
2. PRIMED AND PAINTED

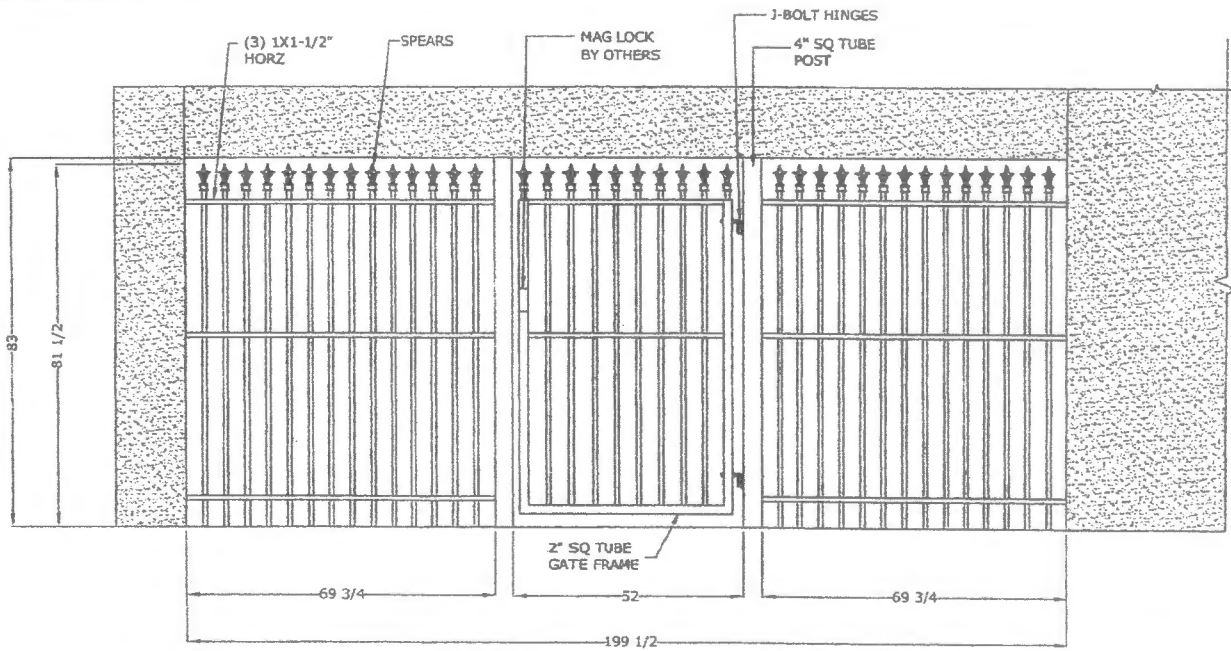

ORNAMENTAL
FENCE & RAILROAD SUPPLY

DESCRIPTION:

FENCE PANELS AND WALK GATE

CUSTOMER:

EAST LAKE OAKS

JOB NAME: EAST LAKE OAKS

DRAWN BY: CES

CHECK BY:

SCALE: 1/2" = 1'0" DATE: 11-6-13

SHEET NO: E-2

SHEET OF: 02

CAD FILE:

DATE:



Imagery Date: 3/14/2013 28°02'43.51" N 82°41'07.04" W elev 10 ft

ALLEGIANCE DEVELOPMENT, INC.

STATE CERTIFIED GENERAL CONTRACTOR CGC1518539

1507 Lemon Street Clearwater, Florida 33756

Phone 727-584-1370 Fax 727-449-1690

Professional References

Ameritech Property Management, Inc.

24701 U.S Highway 19 North Suite #102

Clearwater, FL 33763

Phone: 727-726-8000

Fax: 727-723-1101

Contact: Scott Vignery, Michelle Lawrence, Tom Preister

Scope of work preformed: Milling and paving of roadways, Storm water and concrete repairs

Lake Seminole Resort

10245 110th Ave North

Largo, FL 33773

Phone: 727-391-1840

Fax: 727-393-5702

Contact: Bob Baxter

Scope of work preformed: Milling and paving of roadways, Concrete slab and storm water repair

Honeymoon MHP

1100 Curlew Road

Dunedin, FL 34698

Phone: 727-733-6040

Contact: Marta

Scope of work preformed: Milling and paving of roadways and storm water repairs

Pappas Retail Leasing

P.O Box 48547

Saint Petersburg, FL 33743

Phone: 727-347-5796

Contact: Pauline Pappas or Ray

Scope of work preformed: Milling and paving of roadways, Sealcoating, ADA compliance, Storm water and concrete repairs



CERTIFICATE OF LIABILITY INSURANCE

ALLEG-1

OP ID: KE

DATE (MM/DD/YYYY)

10/01/2013

THIS CERTIFICATE IS ISSUED AS A MATTER OF INFORMATION ONLY AND CONFERS NO RIGHTS UPON THE CERTIFICATE HOLDER. THIS CERTIFICATE DOES NOT AFFIRMATIVELY OR NEGATIVELY AMEND, EXTEND OR ALTER THE COVERAGE AFFORDED BY THE POLICIES BELOW. THIS CERTIFICATE OF INSURANCE DOES NOT CONSTITUTE A CONTRACT BETWEEN THE ISSUING INSURER(S), AUTHORIZED REPRESENTATIVE OR PRODUCER, AND THE CERTIFICATE HOLDER.

IMPORTANT: If the certificate holder is an **ADDITIONAL INSURED**, the policy(ies) must be endorsed. If **SUBROGATION IS WAIVED**, subject to the terms and conditions of the policy, certain policies may require an endorsement. A statement on this certificate does not confer rights to the certificate holder in lieu of such endorsement(s).

PRODUCER West Coast Insurance, Inc. 8377 Gunn Highway Tampa, FL 33626 GEORGE LACKEY		Phone: 813-935-4440 Fax: 813-935-4450	CONTACT NAME: KATHY ELLSWORTH PHONE (A/C, No, Ext): 813-935-4440 FAX (A/C, No): 813-935-4450 E-MAIL ADDRESS: KELLSWORTH@WCIFLA.COM																					
INSURED ALLEGIANCE DEVELOPMENT INC AMERISEAL PAVING & SEALCOATING MICHAEL GODFREY P O BOX 1055 DUNEDIN, FL 34698		<table border="1"><thead><tr><th colspan="2">INSURER(S) AFFORDING COVERAGE</th><th>NAIC #</th></tr></thead><tbody><tr><td colspan="2">INSURER A : AUTO-OWNERS INSURANCE CO</td><td>18988</td></tr><tr><td colspan="2">INSURER B : SOUTHERN OWNERS INSURANCE</td><td>10190</td></tr><tr><td colspan="2">INSURER C : F C B & I FUND</td><td>31259</td></tr><tr><td colspan="2">INSURER D :</td><td></td></tr><tr><td colspan="2">INSURER E :</td><td></td></tr><tr><td colspan="2">INSURER F :</td><td></td></tr></tbody></table>		INSURER(S) AFFORDING COVERAGE		NAIC #	INSURER A : AUTO-OWNERS INSURANCE CO		18988	INSURER B : SOUTHERN OWNERS INSURANCE		10190	INSURER C : F C B & I FUND		31259	INSURER D :			INSURER E :			INSURER F :		
INSURER(S) AFFORDING COVERAGE		NAIC #																						
INSURER A : AUTO-OWNERS INSURANCE CO		18988																						
INSURER B : SOUTHERN OWNERS INSURANCE		10190																						
INSURER C : F C B & I FUND		31259																						
INSURER D :																								
INSURER E :																								
INSURER F :																								

COVERAGES**CERTIFICATE NUMBER:****REVISION NUMBER:**

THIS IS TO CERTIFY THAT THE POLICIES OF INSURANCE LISTED BELOW HAVE BEEN ISSUED TO THE INSURED NAMED ABOVE FOR THE POLICY PERIOD INDICATED. NOTWITHSTANDING ANY REQUIREMENT, TERM OR CONDITION OF ANY CONTRACT OR OTHER DOCUMENT WITH RESPECT TO WHICH THIS CERTIFICATE MAY BE ISSUED OR MAY PERTAIN, THE INSURANCE AFFORDED BY THE POLICIES DESCRIBED HEREIN IS SUBJECT TO ALL THE TERMS, EXCLUSIONS AND CONDITIONS OF SUCH POLICIES. LIMITS SHOWN MAY HAVE BEEN REDUCED BY PAID CLAIMS.

INSR LTR	TYPE OF INSURANCE	ADDL INSR	SUBR WVD	POLICY NUMBER	POLICY EFF (MM/DD/YYYY)	POLICY EXP (MM/DD/YYYY)	LIMITS
B	GENERAL LIABILITY			20045647	09/09/2013	09/09/2014	EACH OCCURRENCE \$ 1,000,000
	<input checked="" type="checkbox"/> COMMERCIAL GENERAL LIABILITY						DAMAGE TO RENTED PREMISES (Ea occurrence) \$ 300,000
	<input type="checkbox"/> CLAIMS-MADE <input checked="" type="checkbox"/> OCCUR						MED EXP (Any one person) \$ 10,000
	GEN'L AGGREGATE LIMIT APPLIES PER:						PERSONAL & ADV INJURY \$ 1,000,000
	<input type="checkbox"/> POLICY <input checked="" type="checkbox"/> PROJECT <input type="checkbox"/> LOC						GENERAL AGGREGATE \$ 2,000,000
							PRODUCTS - COMP/OP AGG \$ 2,000,000
A	AUTOMOBILE LIABILITY			48-941467-00	09/09/2013	09/09/2014	COMBINED SINGLE LIMIT (Ea accident) \$ 1,000,000
	<input checked="" type="checkbox"/> ANY AUTO						BODILY INJURY (Per person) \$
	<input type="checkbox"/> ALL OWNED AUTOS	<input type="checkbox"/> SCHEDULED AUTOS					BODILY INJURY (Per accident) \$
	<input type="checkbox"/> HIRED AUTOS	<input type="checkbox"/> NON-OWNED AUTOS					PROPERTY DAMAGE (Per accident) \$
							\$
	UMBRELLA LIAB						EACH OCCURRENCE \$
	EXCESS LIAB						AGGREGATE \$
	<input type="checkbox"/> DED <input type="checkbox"/> RETENTION \$						\$
C	WORKERS COMPENSATION AND EMPLOYERS' LIABILITY			104525	10/01/2013	10/01/2014	<input checked="" type="checkbox"/> WC STATUTORY LIMITS <input type="checkbox"/> OTHER
	ANY PROPRIETOR/PARTNER/EXECUTIVE OFFICER/MEMBER EXCLUDED? (Mandatory in NH)	<input type="checkbox"/> Y <input checked="" type="checkbox"/> N	N/A				E.L. EACH ACCIDENT \$ 100,000
	If yes, describe under DESCRIPTION OF OPERATIONS below						E.L. DISEASE - EA EMPLOYEE \$ 100,000
							E.L. DISEASE - POLICY LIMIT \$ 500,000
B	INLAND MARINE			20045647	09/09/2013	09/09/2014	

DESCRIPTION OF OPERATIONS / LOCATIONS / VEHICLES (Attach ACORD 101, Additional Remarks Schedule, if more space is required)

CERTIFICATE HOLDER**CANCELLATION**

PINNELC PINELLAS COUNTY CONSTRUCTION LICENSING BOARD 12600 BELCHER RD, SUITE 102 LARGO, FL 33773	<p>SHOULD ANY OF THE ABOVE DESCRIBED POLICIES BE CANCELLED BEFORE THE EXPIRATION DATE THEREOF, NOTICE WILL BE DELIVERED IN ACCORDANCE WITH THE POLICY PROVISIONS.</p> <p>AUTHORIZED REPRESENTATIVE</p> 
---	---

© 1988-2010 ACORD CORPORATION. All rights reserved.



BIG DOG FENCE INC.
31116 Eloian Drive
Wesley Chapel, FL.33544
Off. 813-907-9877 Fax. 813-994-7827
service@bigdogfence.com

QUOTE - Keyed Lock

Date: 2-12-14
Quote# 777956

To: E. Lakes Oaks CDD
C/O: Severn Trent Management Services
Add: 5608 W. Cypress Street, Suite A
Tampa, FL. 33607
Attn: Andy Mendenhall
Proj: Pool Cabana Fence
Off: (813) 991-1116 x104
Fax: (813) 991-1117
Email: amendenhall@severntrentms.com
Rep: Alan Lanier
Quote Good For 30 Days

Material, Tax & Labor included in quote.

<u>Units</u>	<u>Description</u>
210 lf	Remove/Dispose existing 6'h Chain Link Fence
210 lf	6'h Commercial Galvanized Steel Fence- Crushed Spear Top, Pool Code Post - 2.5"x 8.5'x 3/16" wall
18.5 lf	6.5'h x 6'h Commercial Galvanized Steel Fence- Crushed Spear Top, Pool Code
1	Gate, 4'w x 6'h Galvanize with expanded metal welded to frame
1	Gate, 3.5'w x 6'h Galvanize Post: 4"x10' x 1/4" wall. With header, ties post together at top, welded.
1	expanded metal welded to left side panel next lock
1	Hydraulic closer overhead mount
4	Coredrill, post into concrete/pavers
1	Fire Knox Box -must keep (1) Key inside for Fire Dept. emergency entry
1	Use Customers Existing Keyed Lock

Note: All Material Color- white powder coated.
Fence Design:



Amount:	17,900.00
Deposit:	8,950.00
Balance Due on Completion:	8,950.00

AC# 6271935

STATE OF FLORIDA

DEPARTMENT OF BUSINESS AND PROFESSIONAL REGULATION
CONSTRUCTION INDUSTRY LICENSING BOARD

SEQ# L12081502252

DATE	BATCH NUMBER	LICENSE NBR
08/15/2012	128041739	CGC1518539

The GENERAL CONTRACTOR
Named below IS CERTIFIED
Under the provisions of Chapter 489 FS.
Expiration date: AUG 31, 2014

GODFREY, MICHAEL P
ALLEGIANCE DEVELOPMENT, INC
1755 MAPLELEAF BLVD
OLDSMAR FL 34677

RICK SCOTT
GOVERNOR

KEN LAWSON
SECRETARY

DISPLAY AS REQUIRED BY LAW

THIS DOCUMENT HAS A COLORED BACKGROUND • MICROPRINTING • LINEMARK™ PATENTED PAPER

AC# 6173107

STATE OF FLORIDA

DEPARTMENT OF BUSINESS AND PROFESSIONAL REGULATION
HOME INSPECTORS LICENSING PROGRAM

SEQ# L12062500183

DATE	BATCH NUMBER	LICENSE NBR
06/25/2012	110440875	HI6675

The HOME INSPECTOR
Named below IS CERTIFIED
Under the provisions of Chapter 468 FS.
Expiration date: JUL 31, 2014

GODFREY, MICHAEL P
PO BOX 1055
DUNEDIN FL 34697

RICK SCOTT
GOVERNOR

KEN LAWSON
SECRETARY

DISPLAY AS REQUIRED BY LAW

PINELLAS COUNTY CONSTRUCTION
LICENSING BOARD

THIS CERTIFIES THAT Michael P Godfrey
DBA Allegiance Development Inc

STATE CERT # I-CGC1518539
HAS FILED HIS/HER LICENSE AND PROOF OF REQUIRED
LIABILITY AND WORKERS' COMPENSATION
INSURANCE WITH THIS BOARD.

IN GOOD STANDING UNTIL September 30, 2014
DATE OF ISSUANCE 10/01/2013

I-CGC1518539

Godfrey, Michael P
Post Office Box 2368
Tarpon Springs, FL 34688

* Please cut out license along lines



BIG DOG FENCE INC.
31116 Eloian Drive
Wesley Chapel, FL. 33544
Off. 813-907-9877 Fax. 813-994-7827
service@bigdogfence.com

QUOTE - Maglock

Date: 2-12-14
Quote# 777957

To: E. Lakes Oaks CDD
C/O: Severn Trent Management Services
Add: 5608 W. Cypress Street, Suite A
Tampa, Fl. 33607
Attn: Andy Mendenhall
Proj: Pool Cabana Fence
Off: (813) 991-1116 x104
Fax: (813) 991-1117
Email: amendenhall@severntrentms.com
Rep: Alan Lanier
Quote Good For 30 Days

Material, Tax & Labor included in quote.

<u>Units</u>	<u>Description</u>
210 lf	Remove/Dispose existing 6'h Chain Link Fence
210 lf	6'h Commercial Galvanized Steel Fence- Crushed Spear Top, Pool Code Post - 2.5"x 8.5'x 3/16" wall
18.5 lf	6.5'h x 6'h Commercial Galvanized Steel Fence- Crushed Spear Top, Pool Code
1	Gate, 4'w x 6'h Galvanize with expanded metal welded to frame
1	use existing door latch
1	Gate, 3.5'w x 6'h Galvanize Post: 4"x10' x 1/4" wall. With header, ties post together at top, welded.
1	expanded metal welded to left side panel next lock
1	Hydraulic closer overhead mount
4	Coredrill, post into concrete/pavers
1	MagLock 1200#
1	Card reader w/1000 code memory
1	Post, for card reader mount
1	Power supply and enclosure
1	Green Exit Push button
1	Battery Backup, lock will function if power outage
1	Conduit & Wiring to Main Power
1	Fire Knox Box - must keep (1) Card inside for Fire Dept. emergency entry

Note: All Material Color- white powder coated.

Fence Design:



Amount:	22,108.00
Deposit:	11,504.00
Balance Due on Completion:	11,504.00

BIG DOG FENCE, INC.

This is a fence we installed 4 years ago. Only difference between this design and proposed E. Lake Oaks design is added spear top, anti-climb. Mesh will only be on main entry gate and left side panel.





Proposal for
Eastlake Oaks

Pricing valid through 8/31/2013

EnveraSystems.com
7280 W Palmetto Park Rd, Ste 306 Boca Raton, FL 33433 P (561) 910-5826
8132 Blaikie Court Sarasota, FL 34240 P (941) 556-0731

About Envera

Envera protects communities better than anyone else because Envera focuses strictly on the unique security needs of gated communities, homeowners' associations, condominium associations, and community development districts. Our patented monitoring system and proprietary software utilize the latest technology combined with State Licensed Virtual Guards to offer an enhanced level of security, in a more efficient manner and at a lower cost.

Envera currently secures many gate points, access control entry points, and amenities such as clubhouses, pools, and parks. Envera's state-of-the-art central station operates 24 hours a day / 365 days a year, protecting our customers' assets, and efficiently screening visitors at our communities. Our "Virtual Gate Guard" product is leading edge, and provides gated communities with an alternative to traditional guards. Our licensed virtual guards greet and screen HOA visitors, and can also see multiple points in a community at one time, deterring trespassers and voicing down to intruders or vandals. Envera combines all of today's technologies into a single solution that will meet your security needs and budget.

www.enverasystems.com

Security Consultant: Bill Ford ~407.280.1021~ bford@enverasystems.com



Virtual Gate Guard

Visitor Verification

- Record of Each Visitor Permitted / Denied*
- License Plate Recognition*
- Archived Visitor Transactions*
- Web-Based Visitor Management*
- Driver's License Scanning (Upgrade Option)*



Virtual Doorman

- Archived Video with 24/7 Recording*
- Helps Recoup Property Damage Costs*
- Video Pulled After an Event Occurs*
- Make / Model of Vehicles*
- License Plate Capture*



Active Video Surveillance

- Event Based using Advanced Video Analytics*
- Live Two-Way Audio as Event Occurs*
- Live Video Before, During & After an Event*
- Deters Vandalism & Trespassing*
- Automatic Email Notification of Events*



Passive Video Surveillance

- Archived Video with 24/7 Recording*
- Helps Recoup Property Damage Costs*
- Video Pulled After Event Occurs*
- Make / Model Vehicles*
- License Plate Capture*



Access Control

- Reliable Web-Based Database Technology*
- Regulate Times / Grant or Deny Access*
- Record of Each Entry or Denied Entry*
- Fully Manageable by Envera*
- Deny Entry to Delinquent Residents*
- Helps Manage Authorized Tenants*
- Credential Options Including Biometrics*



Burglar Alarm

- Verified Two-Way Audio*
- Class D Licensed Guards*
- Low Number of False Alarms*
- Assistance at the Push of a Button*
- Email Notifications*

Eastlake Oaks Active Video Pool Monitoring Solution

1619 Graybark Drive Oldsmar, FL
360 condos

Equipment Room

116ft Trenching

Envera will need Static IP Address and AC Power at Equipment Room

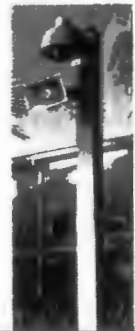

Install Smart Camera with
Voice down Technology.
Camera Final placement
of camera is based on
best view of entire pool

ENVERA
NEXT GENERATION SECURITY

Scope of Work

Service: Active Video Surveillance

Install smart camera to record video activity 24-hours a day and at night to automatically convert to Virtual Guard to prevent individuals from gaining access to pool. See drawing for details.

Recurring Monthly Investment

Monitoring of 1 Active Video Camera when area is closed: **\$233**

Includes Service & Maintenance Plan

Quote Totals

Grand Total: \$8,336.75

3rd Party Financing Option (60 Months with \$1.00 Buy-Out) ~ Monthly Payment: **\$193**

Line Items

Product Name	Quantity
Battery Backup 1500VA	1.00
Router	1.00
iBoot Bar G2 Expansion	1.00
iBoot Bar G2	1.00
Outdoor Speaker / Microphone Combination	1.00
Outdoor Camera with Built-In Analytics - 750GB, 2MP	1.00
Infrared Illuminator	1.00
12' Post	1.00
Power Supply 3.5 Amp with Cord	1.00
Equipment Rack	1.00
Camera Wall Mount	1.00
PoE Surge Protection	1.00
Audio Interface Amplifier	1.00
PoE Injector	1.00
Trenching & Backfilling	105.00
Conduit	110.00
Wire	375.00
Labor	

Eastlake Oaks

Access Control to Pool



Access Control for
Pool Entry Gates



Envera will need Static IP Address and AC Power at Equipment Room

Scope of Work

Service: Access Control

Install access control on pool gate.

Recurring Monthly Investment

Managed Access Control for Community Size Medium 300-599 Homes plus Service & Maintenance Plan: **\$185**

Quote Totals

Grand Total: \$3,520.70

3rd Party Financing Option (60 Months with \$1.00 Buy-Out) ~ Monthly Payment: **\$82**

Line Items

Product Name	Quantity
eMerge50 Network Controller	1.00
Battery Backup 900VA	1.00
Card Reader (2" Read Range)	1.00
Exit Push Button	1.00
Electromechanical Gate Lock	1.00
6' Post	1.00
Power Supply 8 Channel for Access	1.00
Magnalatch for Pool Gate	1.00
Trenching & Backfilling	10.00
Conduit	20.00
Wire	80.00
Labor	



Credential Prices	
Fobs or Cards	\$ 7 each

Total Investment

	INSTALLATION PURCHASE INVESTMENT	RECURRING MONTHLY INVESTMENT
Active Video Surveillance System at Pool Active Video Surveillance at Night, Service & Maintenance Plan Included	\$ 8,336.75	\$ 233.00
Access Control System at Pool Managed Access Control, Service & Maintenance Plan Included	\$ 3,520.70	\$ 185.00
TOTAL	\$ 11,857.45	\$ 418.00
FINANCE OPTION		
Monthly Amount if Leased 60 Months with \$1.00 Buy-Out	\$ 271.00	

Terms & Conditions

The community will be responsible for:

- Providing adequate power where the head end equipment will be located prior to Envera beginning work
- Providing a static IP modem using Verizon FiOS or a T1 or a static IP connection with a minimum 1MB per second upload speed prior to Envera beginning work
- Providing a database of all residents including names, addresses & phone number
- All permitting fees incurred by Envera in order to complete installation including potential city or county required ETL certification costs and any required EMS access devices not currently in place
- Deposit equal to 50% of installation costs and two months of the recurring monthly costs prior to Envera scheduling work.

The minimum requirements to view video footage from client's PC:

- Windows 32-bit Operating System (Dual-Core CPU, 4Gb Memory) or Windows 64-Bit Operating System (Dual-Core CPU, 4Gb Memory)

Service & Maintenance Plan

- Should any equipment need to be serviced or replaced, Envera will not charge for labor or system parts and materials.
- Service & Maintenance Plan excludes accident, vandalism, flood, water, lightning, fire intrusion, abuse, misuse, an act of God, any casualty, including electricity, unauthorized repair service, modification or improper installation or any other cause beyond the control of Envera, including interruption of electrical power or telephone service.

System implementation:

- 36 month agreement required with any monthly service
- Sales tax will be added to all monthly charges
- Will begin within approximately 60 days from the date a contract is signed
- Envera will not begin work until all permits have been issued
- Installation of the equipment will take approximately six weeks to complete and fully test.
- Envera's Implementation Team will provide 2 days of workshops in the clubhouse for resident orientation
- Once the system is activated and on-line, Envera will conduct a "soft opening" giving residents 30 days to get acclimated (Guests will be asked where they are going but no guest will be denied.)
- After the soft opening period expires, all guests will be verified before being granted entry into the community.
- Envera will attempt to integrate existing equipment as necessary. If existing equipment is not compatible, it will be replaced at Client's expense.

Third Party Financing

- Subject to Credit Approval
- \$1.00 Buy Out Purchase Option
- Sales Tax Will Be Added to Final Rate
- \$250 Documentation Fee and First 2 Months Required at Signing

Classic Construction Ltd.

DBA | 100 Hampton Road #123 Clearwater, FL 33759 | Lic# CCC1327856 / CRC058037

www.ClassicRFG.com - www.Nutechpaints.com

Brian Lodermeier 727-421-2845

DATE: November 19, 2013
Contract #
Client Name: East Lake Pool house
Site Address: Shady Oaks Dr
City, ST ZIP:
Phone:
Email:

Description	Qty.	Ea.	Price
Prep, powerwash roof, repair tile, seal cracks in tuckpointing, approx 1000sf			\$1,850.00
Install 1 coat Nutech nuprime tile sealer			
Install 2 coats NXT Cool Zone roof coating			
Prep, powerwash, prime and paint 2 coats all walls and ceiling on pool house. Paint 2 doors			\$2,650.00
Paint soffit and fascia - NXT Cool Zone			
Does not include bathroom interiors			
Approx 2100sf			
		Subtotal	\$4,500.00
		Deposit	
		Total due	\$4,500.00

X _____
Authorized Signature DATE:

Printed Name

*WILL INCLUDE INSIDE
OF BATHROOMS*

Terms and Conditions: Classic Construction/Nutech Florida is not responsible for unseen damages. Additional damages will be addressed per addendum to be approved by the authorizing party before work will be performed. The undersigned agrees to pay in full the approved work order to Nutech Florida. Progress payments to be paid, when applicable, per submitted draw requests.

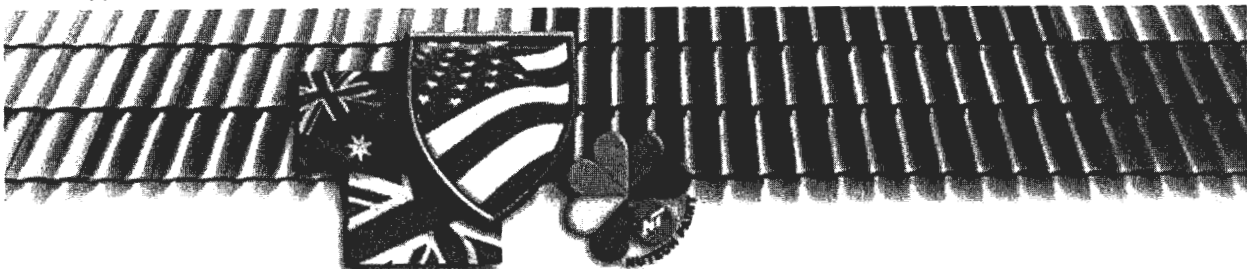

EASTLAKE OAKS
Community Development District

Financial Statements
(Unaudited)

February 28, 2014

RECEIVED
30 APR 09

2014 AUG - 7 AM 8:45

BOARD OF COUNTY
COMMISSIONERS
HALL COUNTY FLORIDA

EASTLAKE OAKS
Community Development District

Table of Contents

FINANCIAL STATEMENTS

Balance Sheet - All Funds	Page 1
Statement of Revenues, Expenditures and Changes in Fund Balances	
General Fund	Page 2 - 3
Debt Service Fund	Page 4

SUPPORTING SCHEDULES

Non-Ad Valorem Special Assessments	Page 5 - 6
Cash and Investment Report	Page 7
Bank Reconciliation	Page 8

Balance Sheet
February 28, 2014

ACCOUNT DESCRIPTION	GENERAL FUND	SERIES 2008 DEBT SERVICE FUND	TOTAL
<u>ASSETS</u>			
Cash - Checking Account	\$ 134,256	\$ -	\$ 134,256
Due From Other Funds	-	2,725	2,725
Investments:			
Money Market Account	183,318	-	183,318
SBA Account	1,737	-	1,737
SBA Account - Restricted	204	-	204
SBA Account Reserves	3,126	-	3,126
SBA Account Reserves - Restricted	366	-	366
Reserve Fund	-	12,774	12,774
Revenue Fund	-	108,534	108,534
FMV Adjustment	104	-	104
Prepaid Items	3,480	-	3,480
TOTAL ASSETS	\$ 326,591	\$ 124,033	\$ 450,624
<u>LIABILITIES</u>			
Accounts Payable	\$ 10,848	\$ -	\$ 10,848
Accrued Expenses	595	-	595
Deposits	5,125	-	5,125
Due To Other Funds	2,725	-	2,725
TOTAL LIABILITIES	19,293	-	19,293
<u>FUND BALANCES</u>			
Nonspendable:			
Prepaid Items	3,480	-	3,480
Restricted for:			
Debt Service	-	124,033	124,033
Assigned to:			
Operating Reserves	53,116	-	53,116
Reserves - Ponds	28,830	-	28,830
Reserves-Recreation Facilities	28,330	-	28,330
Unassigned:	193,542	-	193,542
TOTAL FUND BALANCES	\$ 307,298	\$ 124,033	\$ 431,331
TOTAL LIABILITIES & FUND BALANCES	\$ 326,591	\$ 124,033	\$ 450,624

Statement of Revenues, Expenditures and Changes in Fund Balances
For the Period Ending February 28, 2014

ACCOUNT DESCRIPTION	ANNUAL ADOPTED BUDGET	YEAR TO DATE ACTUAL	YTD ACTUAL AS A % OF ADOPTED BUD
REVENUES			
Interest - Investments	\$ 250	\$ 253	101.20%
Special Assmnts- Tax Collector	219,960	206,765	94.00%
Special Assmnts- CDD Collected	733	731	99.73%
Special Assmnts- Discounts	(8,798)	(8,366)	95.09%
TOTAL REVENUES	212,145	199,383	93.98%
EXPENDITURES			
Administration			
P/R-Board of Supervisors	7,000	2,800	40.00%
FICA Taxes	536	214	39.93%
ProfServ-Dissemination Agent	1,000	-	0.00%
ProfServ-Engineering	1,500	-	0.00%
ProfServ-Legal Services	1,500	2,885	192.33%
ProfServ-Mgmt Consulting Serv	48,008	20,003	41.67%
ProfServ-Special Assessment	3,881	3,881	100.00%
ProfServ-Trustee	3,800	2,200	57.89%
Auditing Services	4,350	4,350	100.00%
Postage and Freight	600	181	30.17%
Rental - Meeting Room	450	-	0.00%
Insurance - General Liability	5,686	4,833	85.00%
Printing and Binding	1,000	521	52.10%
Legal Advertising	1,000	-	0.00%
Miscellaneous Services	1,540	548	35.58%
Misc-Assessmnt Collection Cost	4,399	4,008	91.11%
Office Supplies	200	-	0.00%
Annual District Filing Fee	175	175	100.00%
Total Administration	86,625	46,599	53.79%

Statement of Revenues, Expenditures and Changes in Fund Balances
For the Period Ending February 28, 2014

ACCOUNT DESCRIPTION	ANNUAL ADOPTED BUDGET	YEAR TO DATE ACTUAL	YTD ACTUAL AS A % OF ADOPTED BUD
Field			
Contracts-Lake and Wetland	7,200	3,000	41.67%
Contracts-Landscape	33,300	13,875	41.67%
Contracts-Pools	7,140	2,975	41.67%
Contracts-Cleaning Services	2,100	875	41.67%
Electricity - Streetlighting	19,000	7,910	41.63%
Utility - Water	6,800	1,076	15.82%
R&M-Renewal and Replacement	1,500	-	0.00%
R&M-Irrigation	6,400	1,114	17.41%
R&M-Ponds	1,800	-	0.00%
R&M-Pools	1,500	-	0.00%
Misc-Contingency	38,780	15,541	40.07%
Total Field	125,520	46,366	36.94%
TOTAL EXPENDITURES	212,145	92,965	43.82%
Excess (deficiency) of revenues			
Over (under) expenditures	-	106,418	0.00%
OTHER FINANCING SOURCES (USES)			
Operating Transfers-Out	(12,155)	-	0.00%
Contribution to (Use of) Fund Balance	(12,155)	-	0.00%
TOTAL FINANCING SOURCES (USES)	(24,310)	-	0.00%
Net change in fund balance	\$ (12,155)	\$ 106,418	0.00%
FUND BALANCE, BEGINNING (OCT 1, 2013)	200,880	200,880	
FUND BALANCE, ENDING	\$ 188,725	\$ 307,298	

Statement of Revenues, Expenditures and Changes in Fund Balances
For the Period Ending February 28, 2014

ACCOUNT DESCRIPTION	ANNUAL ADOPTED BUDGET	YEAR TO DATE ACTUAL	YTD ACTUAL AS A % OF ADOPTED BUD
REVENUES			
Interest - Investments	\$ 1	\$ 3	300.00%
Special Assmnts- Tax Collector	135,828	127,680	94.00%
Special Assmnts- Discounts	(5,433)	(5,166)	95.09%
TOTAL REVENUES	130,396	122,517	93.96%
EXPENDITURES			
Administration			
Misc-Assessmnt Collection Cost	2,717	2,450	90.17%
Total Administration	2,717	2,450	90.17%
Debt Service			
Principal Debt Retirement	110,000	-	0.00%
Principal Line of Credit/Note	11,500	-	0.00%
Interest Expense	19,298	9,649	50.00%
Total Debt Service	140,798	9,649	6.85%
TOTAL EXPENDITURES	143,515	12,099	8.43%
Excess (deficiency) of revenues			
Over (under) expenditures	(13,119)	110,418	-841.66%
OTHER FINANCING SOURCES (USES)			
Interfund Transfer - In	12,155	-	0.00%
Contribution to (Use of) Fund Balance	(964)	-	0.00%
TOTAL FINANCING SOURCES (USES)	11,191	-	0.00%
Net change in fund balance	\$ (964)	\$ 110,418	0.00%
FUND BALANCE, BEGINNING (OCT 1, 2013)	13,615	13,615	
FUND BALANCE, ENDING	\$ 12,651	\$ 124,033	

EASTLAKE OAKS
Community Development District

Supporting Schedules

February 28, 2014

EASTLAKE OAKS
Community Development District

Non-Ad Valorem Special Assessments - Pinellas County Tax Collector
(Monthly Collection Distributions)
For the Fiscal Year Ending September 30, 2014

						Allocation by Fund	
Date Received	Net Amount Received	Discount/ (Penalties) Amount	Collection Cost	Gross Amount Received	General Fund Gross Assessments	Series 2008 Debt Service Gross Assessments	
ASSESSMENTS LEVIED FY 2014				\$ 355,789	\$ 219,961	\$ 135,828	
Allocation %				100%	62%	38%	
11/14/13	\$ 569	\$ 24	\$ 12	\$ 605	\$ 374	\$ 231	
11/22/13	10,070	428	206	10,703	6,617	4,086	
11/27/13	39,300	1,671	802	41,773	25,825	15,947	
12/09/13	155,766	6,623	3,179	165,568	102,360	63,208	
12/20/13	16,369	696	334	17,399	10,757	6,642	
01/16/14	85,283	3,626	1,740	90,649	56,043	34,607	
02/21/14	7,137	465	146	7,747	4,790	2,958	
TOTAL	\$ 314,494	\$ 13,533	\$ 6,418	\$ 334,445	\$ 206,765	\$ 127,680	
% COLLECTED				94%	94%	94%	
TOTAL OUTSTANDING				\$ 21,344	\$ 13,196	\$ 8,149	

Eastlake Oaks

Community Development District

Non-Ad Valorem Special Assessments - District Collected
Monthly Collection Report
For the Fiscal Year Ending September 30, 2014

							Allocation by Fund		
Date Received	Net Amount Received	Discount/ (Penalties) Amount	Collection Cost	Gross Amount Received	General Fund Gross Assessments	Series 2008 Debt Service Gross Assessments			
DISTRICT COLLECTED ASSESSMENTS LEVIED FY 2014 (1)					\$ 761	761	\$ -		
Allocation %					100%	100%	0%		
11/21/13	\$ 730.67	\$ 30.33	\$ -	\$ 761.00	\$ 761.00	\$ -			
TOTAL	\$ 730.67	\$ 30.33	\$ -	\$ 761.00	\$ 761.00	\$ -			
% COLLECTED					100.00%	100.00%	0.00%		
TOTAL OUTSTANDING					\$ -	\$ -	\$ -		

Note (1) - One Resident is billed direct - net amount

Cash and Investment Report

February 28, 2014

General Fund

<u>Account Name</u>	<u>Bank Name</u>	<u>Investment Type</u>	<u>Yield</u>	<u>Maturity</u>	<u>Balance</u>
Checking Account - Operating	Wells Fargo Bank	Interest Bearing Account	0.25%	n/a	\$ 134,256
Money Market	Florida Shores Bank	Public Funds Money Market	0.40%	n/a	\$ 183,318
SBA Account	Operating Account	State Board of Administration	0.22%	n/a	\$ 1,737
SBA Account (Restricted)	Operating Account	State Board of Administration	0.00%	n/a	\$ 204
SBA Reserves	Reserve Account	State Board of Administration	0.22%	n/a	\$ 3,126
SBA Reserves (Restricted)	Reserve Account	State Board of Administration	0.00%	n/a	\$ 366
Subtotal					\$ 323,008

Debt Service Fund

<u>Account Name</u>	<u>Bank Name</u>	<u>Investment Type</u>	<u>Yield</u>	<u>Maturity</u>	<u>Balance</u>
Series 2008 Reserve Account	US Bank	Open-ended Commercial Paper	0.15%	n/a	\$ 12,774
Series 2008 Revenue Account	US Bank	Open-ended Commercial Paper	0.15%	n/a	\$ 108,534
Subtotal					\$ 121,308
Total					\$ 444,315

**Eastlake Oaks CDD
Bank Reconciliation**

Bank Account No. [REDACTED]
Statement No. 02-14
Statement Date 02/28/14

G/L Balance (\$)	134,255.70	Statement Balance	143,521.48
G/L Balance	134,255.70	Outstanding Deposits	0.00
Positive Adjustments	0.00		
<hr/>		Subtotal	143,521.48
Subtotal	134,255.70	Outstanding Checks	9,265.78
Negative Adjustments	0.00	Total Differences	0.00
<hr/>			
Ending G/L Balance	134,255.70	Ending Balance	134,255.70
Difference	0.00		

<u>Posting Date</u>	<u>Document Type</u>	<u>Document No.</u>	<u>Description</u>	<u>Amount</u>	<u>Cleared Amount</u>	<u>Difference</u>
Outstanding Checks						
02/18/14	Payment	2754	CHERYL K. ASOIAN	184.70	0.00	184.70
02/27/14	Payment	2761	CLASSIC CONSTRUCTION LTD. CO	8,300.00	0.00	8,300.00
02/27/14	Payment	2762	FEDEX	9.08	0.00	9.08
02/27/14	Payment	2763	LANDSCAPE MAINTENANCE	772.00	0.00	772.00
Total Outstanding Checks				9,265.78		

EASTLAKE OAKS
Community Development District

Check Register and Invoices

January 1 - February 28, 2014

Eastlake Oaks

Check Register by Fund

For the Period from 01/01/2014 to 02/28/2014
(Sorted by Check No.)

Fund No.	Check No.	Check Date	Payee	Invoice No.	Invoice Description	G/L Account Name	G/L Account #	Check Amount
GENERAL FUND - 001								
001	2730	01/02/14	FEDEX	2-498-92957	Services Through 12/17/13	Postage and Freight	541006-51301	\$8.27
001	2730	01/02/14	FEDEX	2-506-75601	Services Through 12/24/13	Postage and Freight	541006-51301	\$8.76
001	2731	01/02/14	PIP'S POOL INC	6477	December 2013 Pool Maintenance	Contracts-Pools	534078-53901	\$595.00
001	2732	01/09/14	LANDSCAPE MAINTENANCE PROFESSIONALS	76592	Landscape Maint January 2014	Contracts-Landscape	534050-53901	\$2,775.00
001	2733	01/09/14	PRESTIGE JANITORIAL SERVICE	1212	Cleaning Services January 2014	Contracts-Cleaning Services	534082-53901	\$175.00
001	2734	01/09/14	SEVERN TRENT ENVIRONMENTAL SER	STES 2071184	December 2013 Mgmt Fees/Reimbursements	ProfServ-Mgmt Consulting Serv	531027-51201	\$4,000.67
001	2734	01/09/14	SEVERN TRENT ENVIRONMENTAL SER	STES 2071184	December 2013 Mgmt Fees/Reimbursements	Postage and Freight	541006-51301	\$6.44
001	2734	01/09/14	SEVERN TRENT ENVIRONMENTAL SER	STES 2071184	December 2013 Mgmt Fees/Reimbursements	Printing and Binding	547001-51301	\$4.80
001	2734	01/09/14	SEVERN TRENT ENVIRONMENTAL SER	STES 2071185	Assessment Roll Services	ProfServ-Special Assessment	531038-51301	\$3,881.00
001	2735	01/09/14	TAMPA ELECTRIC CO.	122713	Electric Services 11/22-12/26/13	Electricity - Streetlighting	543013-53901	\$1,505.71
001	2736	01/15/14	BRIGHTHOUSE	010414	Internet Services 1/12-2/11/14	Miscellaneous Services	549001-51301	\$55.75
001	2737	01/15/14	CITY OF OLDSMAR	010614	Services 12/2-1/1/14	Utility - Water	543018-53901	\$200.52
001	2738	01/15/14	FOWLER WHITE BOGGS PA	869972	Legal Services Through 12/31/13	ProfServ-Legal Services	531023-51401	\$168.00
001	2739	01/29/14	AMERICAN ECOSYSTEMS INC	14020124	Water Mgmt/Treatment February 2014	Prepaid Items	155000	\$600.00
001	2740	01/29/14	LANDSCAPE MAINTENANCE	77558	Landscape Maint February 2014	Prepaid Items	155000	\$2,775.00
001	2742	02/05/14	BETTERVIEW WINDOW	285	4 Bahaman Shutters At Pool Area	Misc-Contingency	549900-53901	\$1,500.00
001	2743	02/05/14	LANDSCAPE MAINTENANCE	77730	Replace Leaking Valve	Contracts-Landscape	534050-53901	\$311.13
001	2743	02/05/14	LANDSCAPE MAINTENANCE	77743	Repairs from inspection	Contracts-Landscape	534050-53901	\$22.70
001	2743	02/05/14	LANDSCAPE MAINTENANCE	77784	90 4" Poinsettias	Misc-Contingency	549900-53901	\$360.00
001	2744	02/05/14	PIP'S POOL INC	6557	Pool Maintenance January 2014	Contracts-Pools	534078-53901	\$595.00
001	2745	02/05/14	PRESTIGE JANITORIAL SERVICE	1252	Cleaning Services February 2014	Contracts-Cleaning Services	534082-53901	\$175.00
001	2746	02/05/14	SEVERN TRENT ENVIRONMENTAL SER	STES 2071535	January 2014 Management Fees/Reimbursements	ProfServ-Mgmt Consulting Serv	531027-51201	\$4,000.67
001	2746	02/05/14	SEVERN TRENT ENVIRONMENTAL SER	STES 2071535	January 2014 Management Fees/Reimbursements	Postage and Freight	541006-51301	\$57.86
001	2746	02/05/14	SEVERN TRENT ENVIRONMENTAL SER	STES 2071535	January 2014 Management Fees/Reimbursements	Printing and Binding	547001-51301	\$276.00
001	2747	02/05/14	TAMPA ELECTRIC CO.	012814	Service 12/26/13-1/24/14	Electricity - Streetlighting	543013-53901	\$1,047.75
001	2748	02/11/14	BRIGHTHOUSE	020414-0170145	Internet Service 2/12-3/11/14	Miscellaneous Services	549001-51301	\$55.75
001	2749	02/11/14	CITY OF OLDSMAR	020314	Services 1/2-2/1/14	Utility - Water	543018-53901	\$275.21
001	2750	02/11/14	FOWLER WHITE BOGGS PA	870925	Legal Services Through 1/31/14	ProfServ-Legal Services	531023-51401	\$504.00
001	2751	02/11/14	STAR ELECTRIC SERVICES	131210	Common Area Lights	Misc-Contingency	549900-53901	\$200.00
001	2752	02/11/14	TAMPA ELECTRIC CO.	013114	Electric Services 12/30/13-1/28/14	Electricity - Streetlighting	543013-53901	\$479.56
001	2757	02/19/14	AMERICAN ECOSYSTEMS INC	1403124	Water Mgmt/Treatment March 2014	Prepaid Items	155000	\$600.00
001	2758	02/19/14	BERGER, TOOMBS, ELAM	0291561	Audit FY 2013	Auditing Services	532002-51301	\$4,350.00
001	2759	02/19/14	CASTLE VENTURES	0050599	Security Service March, April, May 2014	Prepaid Items	155000	\$105.00
001	2760	02/19/14	EASTLAKE OAKS CDD	021014	Tsfr Funds To Florida Shores SW MMA	Due From Other Funds	131000	\$50,000.00
001	2761	02/27/14	CLASSIC CONSTRUCTION LTD. CO	010214	1/3 Downpayment Sign and Wall Repairs	Misc-Contingency	549900-53901	\$8,300.00
001	2762	02/27/14	FEDEX	2-562-94661	Services through 2/18/14	Postage and Freight	541006-51301	\$9.08
001	2763	02/27/14	LANDSCAPE MAINTENANCE	78354	Repair Mainline Leak	R&M-Irrigation	546041-53901	\$205.00
001	2763	02/27/14	LANDSCAPE MAINTENANCE	78335	Repair Stuck Valve Repair Line Break	R&M-Irrigation	546041-53901	\$133.16
001	2763	02/27/14	LANDSCAPE MAINTENANCE	78381	Repairs from 2/13/14 inspection	R&M-Irrigation	546041-53901	\$260.68

Eastlake Oaks

Check Register by Fund
For the Period from 01/01/2014 to 02/28/2014
(Sorted by Check No.)

Fund No.	Check No.	Check Date	Payee	Invoice No.	Invoice Description	G/L Account Name	G/L Account #	Check Amount
001	2763	02/27/14	LANDSCAPE MAINTENANCE	78406	Repair Zone line break and stuck valve	R&M-Irrigation	546041-53901	\$173.16
001	2753	02/18/14	JOSEPH DINELLI	PAYROLL	February 18, 2014 Payroll Posting			\$184.70
001	2754	02/18/14	CHERYL K. ASOIAN	PAYROLL	February 18, 2014 Payroll Posting			\$184.70
001	2755	02/18/14	BOGDAN M. NOWACKI	PAYROLL	February 18, 2014 Payroll Posting			\$183.45
001	2756	02/18/14	JYOTINDRA J. YAGNIK	PAYROLL	February 18, 2014 Payroll Posting			\$184.70
Fund Total								<u>\$91,494.18</u>

SERIES 2008 DEBT SERVICE FUND - 202

202	2741	01/29/14	US BANK NATIONAL ASSOC.	012014	Tax Collections FY 2014	Due From Other Funds	131000	\$108,533.84
Fund Total								<u>\$108,533.84</u>

Total Checks Paid	\$200,028.02
-------------------	--------------