

4. MISCELLANEOUS ITEMS TO BE RECEIVED FOR FILING:

- a. City of Dunedin Notice of Public Hearing regarding proposed Ordinance No. 14-15 to be held September 25, 2014, annexing certain property.
- b. City of Largo Notice of Public Hearing held August 12, 2014, re proposed Ordinances Nos. 2014-74 through 2014-123 and 2014-125 through 2014-144 annexing certain property.
- c. City of Oldsmar Ordinance No. 2014-07 adopted July 15, 2014, annexing certain property.
- d. City of Seminole Notice of Ordinance Enactment and Public Hearings held August 12, 2014, re proposed Ordinances Nos. 12-2014 through 14-2014 voluntarily annexing certain property.
- e. City of Pinellas Park Notice of Public Hearing held August 14, 2014, regarding proposed Ordinance No. 3891 voluntarily annexing certain property.
- f. City of Pinellas Park Notices of Public Hearings to be held August 28, 2014, regarding proposed Ordinances Nos. 3892 and 3893 voluntarily annexing certain property.

If a copy of a report or CD is desired, please check the web page of the organization/municipality or contact Board Records at 464-3465.

POST OFFICE BOX 296
LARGO, FLORIDA
33779-0296

CITY of LARGO



LARGO, FLORIDA EST. 1905

Community Development Department
Carol Stricklin, AICP
Director

Administration (727) 586-7490
Planning & Development Services (727) 587-6749
Economic Development (727) 586-7360
Engineering Services (727) 587-6713
Housing Programs (727) 586-7489
Licenses/Permits (727) 586-7488

VIA CERTIFIED MAIL, RETURN RECEIPT REQUESTED

July 9, 2014

RECEIVED
JUL 16 2014

Attn: Board of County Commissioners
315 Court Street
Clearwater, FL 33756

BOARD OF COUNTY COMMISSIONERS

RE: ADVERTISEMENT(S) - ANNEXATION(S) BY THE CITY OF LARGO

Dear Board of County Commissioners:

The City of Largo is initiating proceedings to annex the properties hereinafter described into its corporate boundaries. You are being notified of this action because Pinellas County and the Pinellas Planning Council are affected parties. These annexations are being initiated in accordance with Chapter 171 of the Florida Statute.

Enclosed is a copy of the *Notice of Public Hearing*, for Ordinance Numbers 2014-74 through 2014-123, and 2014-125 through 2014-144 that will be published in the *Tampa Bay Times*, *Largo Times*, not in the Classified section on Friday, July 25, 2014 and on Friday, August 1, 2014. First reading for the Ordinance(s) is scheduled for July 22, 2014. **The Public Hearing(s) have been scheduled for August 12, 2014.** Meetings are held at the Largo City Hall, 201 Highland Avenue, at 6:00pm.

To obtain further information regarding this case, please contact the Largo Community Development Department at (727) 586-7342.

Sincerely,

Teresa Brydon
Economic Development Manager

Attachments: Copy of Advertisements for Ordinance Numbers as shown above
Exhibit "A" Maps

RECEIVED
BOARD OF
COUNTY COMMISSIONERS
2014 JUL 16 AM 7:23
CLERK OF COUNTY FLORIDA

CITY OF LARGO

NOTICE OF PUBLIC HEARING

NOTICE IS HEREBY GIVEN that the Largo City Commission will hold a public hearing at their regularly scheduled meeting at **6:00 pm on Tuesday, August 12, 2014** in the Commission Chamber at Largo City Hall, 201 Highland Avenue, Largo, Florida to consider the following:

ORDINANCE NO. 2014 - 74

AN ORDINANCE OF THE CITY OF LARGO, FLORIDA, ANNEXING THE WITHIN DESCRIBED TRACT OF LAND LOCATED AT 1634 SOUTH HIGHLAND AVENUE, PINELLAS COUNTY, FLORIDA, AND CONTIGUOUS TO THE EXISTING CITY LIMITS OF THE CITY OF LARGO, FLORIDA; WITH CITY LAND USE DESIGNATION OF RESIDENTIAL LOW; REDEFINING THE CORPORATE BOUNDARY OF THE CITY OF LARGO TO INCLUDE SAID ADDITION, ACCORDING TO THE PROVISIONS OF CHAPTER 171, FLORIDA STATUTES; PROVIDING FOR SEVERABILITY; AND PROVIDING FOR AN EFFECTIVE DATE.

ORDINANCE NO. 2014 - 75

AN ORDINANCE OF THE CITY OF LARGO, FLORIDA, ANNEXING THE WITHIN DESCRIBED TRACT OF LAND LOCATED AT 1499 BLANTON LANE, PINELLAS COUNTY, FLORIDA, AND CONTIGUOUS TO THE EXISTING CITY LIMITS OF THE CITY OF LARGO, FLORIDA; WITH CITY LAND USE DESIGNATION OF RESIDENTIAL URBAN; REDEFINING THE CORPORATE BOUNDARY OF THE CITY OF LARGO TO INCLUDE SAID ADDITION, ACCORDING TO THE PROVISIONS OF CHAPTER 171, FLORIDA STATUTES; PROVIDING FOR SEVERABILITY; AND PROVIDING FOR AN EFFECTIVE DATE.

ORDINANCE NO. 2014 - 76

AN ORDINANCE OF THE CITY OF LARGO, FLORIDA, ANNEXING THE WITHIN DESCRIBED TRACT OF LAND LOCATED AT 1622 SOUTH HIGHLAND AVENUE, PINELLAS COUNTY, FLORIDA, AND CONTIGUOUS TO THE EXISTING CITY LIMITS OF THE CITY OF LARGO, FLORIDA; WITH CITY LAND USE DESIGNATION OF RESIDENTIAL URBAN; REDEFINING THE CORPORATE BOUNDARY OF THE CITY OF LARGO TO INCLUDE SAID ADDITION, ACCORDING TO THE PROVISIONS OF CHAPTER 171, FLORIDA STATUTES; PROVIDING FOR SEVERABILITY; AND PROVIDING FOR AN EFFECTIVE DATE.

ORDINANCE NO. 2014 - 77

AN ORDINANCE OF THE CITY OF LARGO, FLORIDA, ANNEXING THE WITHIN DESCRIBED TRACT OF LAND LOCATED AT 1631 WOODBRIDGE DRIVE, PINELLAS COUNTY, FLORIDA, AND CONTIGUOUS TO THE EXISTING CITY LIMITS OF THE CITY OF LARGO, FLORIDA; WITH CITY LAND USE DESIGNATION OF RESIDENTIAL LOW; REDEFINING THE CORPORATE BOUNDARY OF THE CITY OF LARGO TO INCLUDE SAID ADDITION, ACCORDING TO THE PROVISIONS OF CHAPTER 171, FLORIDA STATUTES; PROVIDING FOR SEVERABILITY; AND PROVIDING FOR AN EFFECTIVE DATE.

ORDINANCE NO. 2014 - 78

AN ORDINANCE OF THE CITY OF LARGO, FLORIDA, ANNEXING THE WITHIN DESCRIBED TRACTS OF LAND LOCATED AT 1661 SOUTH BETTY LANE AND 1669 SOUTH BETTY LANE, PINELLAS COUNTY, FLORIDA, AND CONTIGUOUS TO THE EXISTING CITY LIMITS OF THE CITY OF LARGO, FLORIDA; WITH CITY LAND USE DESIGNATIONS OF RESIDENTIAL LOW; REDEFINING THE CORPORATE BOUNDARY OF THE CITY OF LARGO TO INCLUDE SAID ADDITION, ACCORDING TO THE PROVISIONS OF CHAPTER 171, FLORIDA STATUTES; PROVIDING FOR SEVERABILITY; AND PROVIDING FOR AN EFFECTIVE DATE.

ORDINANCE NO. 2014 - 79

AN ORDINANCE OF THE CITY OF LARGO, FLORIDA, ANNEXING THE WITHIN DESCRIBED TRACT OF LAND LOCATED AT 1360 PONCE DE LEON BOULEVARD, PINELLAS COUNTY, FLORIDA, AND CONTIGUOUS TO THE EXISTING CITY LIMITS OF THE CITY OF LARGO, FLORIDA; WITH CITY LAND USE DESIGNATION OF RESIDENTIAL LOW; REDEFINING THE CORPORATE BOUNDARY OF THE CITY OF LARGO TO INCLUDE SAID ADDITION, ACCORDING TO THE PROVISIONS OF CHAPTER 171, FLORIDA STATUTES; PROVIDING FOR SEVERABILITY; AND PROVIDING FOR AN EFFECTIVE DATE.

ORDINANCE NO. 2014 - 80

AN ORDINANCE OF THE CITY OF LARGO, FLORIDA, ANNEXING THE WITHIN DESCRIBED TRACT OF LAND LOCATED AT 1678 SOUTH DR. MARTIN LUTHER KING JR. AVENUE, PINELLAS COUNTY, FLORIDA, AND CONTIGUOUS TO THE EXISTING CITY LIMITS OF THE CITY OF LARGO, FLORIDA; WITH CITY LAND USE DESIGNATION OF RESIDENTIAL URBAN; REDEFINING THE CORPORATE BOUNDARY OF THE CITY OF LARGO TO INCLUDE SAID ADDITION, ACCORDING TO THE PROVISIONS OF CHAPTER 171, FLORIDA STATUTES; PROVIDING FOR SEVERABILITY; AND PROVIDING FOR AN EFFECTIVE DATE.

ORDINANCE NO. 2014 - 81

AN ORDINANCE OF THE CITY OF LARGO, FLORIDA, ANNEXING THE WITHIN DESCRIBED TRACTS OF LAND LOCATED AT 1112 JASPER STREET AND 1772 FARRELL AVENUE, PINELLAS COUNTY, FLORIDA, AND CONTIGUOUS TO THE EXISTING CITY LIMITS OF THE CITY OF LARGO, FLORIDA; WITH CITY LAND USE DESIGNATION OF RESIDENTIAL URBAN; REDEFINING THE CORPORATE BOUNDARY OF THE CITY OF LARGO TO INCLUDE SAID ADDITION, ACCORDING TO THE PROVISIONS OF CHAPTER 171, FLORIDA STATUTES; PROVIDING FOR SEVERABILITY; AND PROVIDING FOR AN EFFECTIVE DATE.

ORDINANCE NO. 2014 - 82

AN ORDINANCE OF THE CITY OF LARGO, FLORIDA, ANNEXING THE WITHIN DESCRIBED TRACTS OF LAND LOCATED AT 643 MEHLENBACHER ROAD AND 645 MEHLENBACHER ROAD, PINELLAS COUNTY, FLORIDA, AND CONTIGUOUS TO THE EXISTING CITY LIMITS OF THE CITY OF LARGO, FLORIDA; WITH CITY LAND USE DESIGNATION OF RESIDENTIAL LOW; REDEFINING THE CORPORATE BOUNDARY OF THE CITY OF LARGO TO INCLUDE SAID ADDITION, ACCORDING TO THE PROVISIONS OF CHAPTER 171, FLORIDA STATUTES; PROVIDING FOR SEVERABILITY; AND PROVIDING FOR AN EFFECTIVE DATE.

ORDINANCE NO. 2014 - 83

AN ORDINANCE OF THE CITY OF LARGO, FLORIDA, ANNEXING THE WITHIN DESCRIBED TRACT OF LAND LOCATED AT 1837 EZELLE AVENUE, PINELLAS COUNTY, FLORIDA, AND CONTIGUOUS TO THE EXISTING CITY LIMITS OF THE CITY OF LARGO, FLORIDA; WITH CITY LAND USE DESIGNATION OF RESIDENTIAL LOW; REDEFINING THE CORPORATE BOUNDARY OF THE CITY OF LARGO TO INCLUDE SAID ADDITION, ACCORDING TO THE PROVISIONS OF CHAPTER 171, FLORIDA STATUTES; PROVIDING FOR SEVERABILITY; AND PROVIDING FOR AN EFFECTIVE DATE.

ORDINANCE NO. 2014 - 84

AN ORDINANCE OF THE CITY OF LARGO, FLORIDA, ANNEXING THE WITHIN DESCRIBED TRACT OF LAND LOCATED AT 1917 EZELLE AVENUE, PINELLAS COUNTY, FLORIDA, AND CONTIGUOUS TO THE EXISTING CITY LIMITS OF THE CITY OF LARGO, FLORIDA; WITH CITY LAND USE DESIGNATION OF RESIDENTIAL LOW; REDEFINING THE CORPORATE BOUNDARY OF THE CITY OF LARGO TO INCLUDE SAID ADDITION, ACCORDING TO THE PROVISIONS OF CHAPTER 171, FLORIDA STATUTES; PROVIDING FOR SEVERABILITY; AND PROVIDING FOR AN EFFECTIVE DATE.

ORDINANCE NO. 2014 - 85

AN ORDINANCE OF THE CITY OF LARGO, FLORIDA, ANNEXING THE WITHIN DESCRIBED TRACT OF LAND LOCATED AT 15789 ALMA AVENUE, PINELLAS COUNTY, FLORIDA, AND CONTIGUOUS TO THE EXISTING CITY LIMITS OF THE CITY OF LARGO, FLORIDA; WITH CITY LAND USE DESIGNATION OF RESIDENTIAL URBAN; REDEFINING THE CORPORATE BOUNDARY OF THE CITY OF LARGO TO INCLUDE SAID ADDITION, ACCORDING TO THE PROVISIONS OF CHAPTER 171, FLORIDA STATUTES; PROVIDING FOR SEVERABILITY; AND PROVIDING FOR AN EFFECTIVE DATE.

ORDINANCE NO. 2014 - 86

AN ORDINANCE OF THE CITY OF LARGO, FLORIDA, ANNEXING THE WITHIN DESCRIBED TRACT OF LAND LOCATED AT 2913 FOUNTAINHEAD DRIVE, PINELLAS COUNTY, FLORIDA, AND CONTIGUOUS TO THE EXISTING CITY LIMITS OF THE CITY OF LARGO, FLORIDA; WITH CITY LAND USE DESIGNATION OF RESIDENTIAL LOW; REDEFINING THE CORPORATE BOUNDARY OF THE CITY OF LARGO TO INCLUDE SAID ADDITION, ACCORDING TO THE PROVISIONS OF CHAPTER 171, FLORIDA STATUTES; PROVIDING FOR SEVERABILITY; AND PROVIDING FOR AN EFFECTIVE DATE.

ORDINANCE NO. 2014 - 87

AN ORDINANCE OF THE CITY OF LARGO, FLORIDA, ANNEXING THE WITHIN DESCRIBED TRACT OF LAND LOCATED AT 1133 HICKORY DRIVE, PINELLAS COUNTY, FLORIDA, AND CONTIGUOUS TO THE EXISTING CITY LIMITS OF THE CITY OF LARGO, FLORIDA; WITH CITY LAND USE DESIGNATION OF RESIDENTIAL LOW; REDEFINING THE CORPORATE BOUNDARY OF THE CITY OF LARGO TO INCLUDE SAID ADDITION, ACCORDING TO THE PROVISIONS OF CHAPTER 171, FLORIDA STATUTES; PROVIDING FOR SEVERABILITY; AND PROVIDING FOR AN EFFECTIVE DATE.

ORDINANCE NO. 2014 - 88

AN ORDINANCE OF THE CITY OF LARGO, FLORIDA, ANNEXING THE WITHIN DESCRIBED TRACT OF LAND LOCATED AT 328 14TH AVENUE SOUTHWEST, PINELLAS COUNTY, FLORIDA, AND CONTIGUOUS TO THE EXISTING CITY LIMITS OF THE CITY OF LARGO, FLORIDA; WITH CITY LAND USE DESIGNATION OF RESIDENTIAL LOW; REDEFINING THE CORPORATE BOUNDARY OF THE CITY OF LARGO TO INCLUDE SAID ADDITION, ACCORDING TO THE PROVISIONS OF CHAPTER 171, FLORIDA STATUTES; PROVIDING FOR SEVERABILITY; AND PROVIDING FOR AN EFFECTIVE DATE.

ORDINANCE NO. 2014 - 89

AN ORDINANCE OF THE CITY OF LARGO, FLORIDA, ANNEXING THE WITHIN DESCRIBED TRACTS OF LAND LOCATED AT 210 14TH AVENUE SOUTHWEST AND 216 14TH AVENUE SOUTHWEST, PINELLAS COUNTY, FLORIDA, AND CONTIGUOUS TO THE EXISTING CITY LIMITS OF THE CITY OF LARGO, FLORIDA; WITH CITY LAND USE DESIGNATION OF RESIDENTIAL LOW; REDEFINING THE CORPORATE BOUNDARY OF THE CITY OF LARGO TO INCLUDE SAID ADDITION, ACCORDING TO THE PROVISIONS OF CHAPTER 171, FLORIDA STATUTES; PROVIDING FOR SEVERABILITY; AND PROVIDING FOR AN EFFECTIVE DATE.

ORDINANCE NO. 2014 - 90

AN ORDINANCE OF THE CITY OF LARGO, FLORIDA, ANNEXING THE WITHIN DESCRIBED TRACT OF LAND LOCATED AT 223 14TH AVENUE SOUTHWEST, PINELLAS COUNTY, FLORIDA, AND CONTIGUOUS TO THE EXISTING CITY LIMITS OF THE CITY OF LARGO, FLORIDA; WITH CITY LAND USE DESIGNATION OF RESIDENTIAL LOW; REDEFINING THE CORPORATE BOUNDARY OF THE CITY OF LARGO TO INCLUDE SAID ADDITION, ACCORDING TO THE PROVISIONS OF CHAPTER 171, FLORIDA STATUTES; PROVIDING FOR SEVERABILITY; AND PROVIDING FOR AN EFFECTIVE DATE.

ORDINANCE NO. 2014 - 91

AN ORDINANCE OF THE CITY OF LARGO, FLORIDA, ANNEXING THE WITHIN DESCRIBED TRACT OF LAND LOCATED AT 1444 1ST STREET SOUTHWEST, PINELLAS COUNTY, FLORIDA, AND CONTIGUOUS TO THE EXISTING CITY LIMITS OF THE CITY OF LARGO, FLORIDA; WITH CITY LAND USE DESIGNATION OF RESIDENTIAL LOW; REDEFINING THE CORPORATE BOUNDARY OF THE CITY OF LARGO TO INCLUDE SAID ADDITION, ACCORDING TO THE PROVISIONS OF CHAPTER 171, FLORIDA STATUTES; PROVIDING FOR SEVERABILITY; AND PROVIDING FOR AN EFFECTIVE DATE.

ORDINANCE NO. 2014 - 92

AN ORDINANCE OF THE CITY OF LARGO, FLORIDA, ANNEXING THE WITHIN DESCRIBED TRACTS OF LAND LOCATED AT 1413 4TH STREET SOUTHWEST AND 334 15TH AVENUE SOUTHWEST, PINELLAS COUNTY, FLORIDA, AND CONTIGUOUS TO THE EXISTING CITY LIMITS OF THE CITY OF LARGO, FLORIDA; WITH CITY LAND USE DESIGNATION OF RESIDENTIAL LOW; REDEFINING THE CORPORATE BOUNDARY OF THE CITY OF LARGO TO INCLUDE SAID ADDITION, ACCORDING TO THE PROVISIONS OF CHAPTER 171, FLORIDA STATUTES; PROVIDING FOR SEVERABILITY; AND PROVIDING FOR AN EFFECTIVE DATE.

ORDINANCE NO. 2014 - 93

AN ORDINANCE OF THE CITY OF LARGO, FLORIDA, ANNEXING THE WITHIN DESCRIBED TRACT OF LAND LOCATED AT 216 16TH AVENUE SOUTHWEST, PINELLAS COUNTY, FLORIDA, AND CONTIGUOUS TO THE EXISTING CITY LIMITS OF THE CITY OF LARGO, FLORIDA; WITH CITY LAND USE DESIGNATION OF RESIDENTIAL LOW; REDEFINING THE CORPORATE BOUNDARY OF THE CITY OF LARGO TO INCLUDE SAID ADDITION, ACCORDING TO THE PROVISIONS OF CHAPTER 171, FLORIDA STATUTES; PROVIDING FOR SEVERABILITY; AND PROVIDING FOR AN EFFECTIVE DATE.

ORDINANCE NO. 2014 - 94

AN ORDINANCE OF THE CITY OF LARGO, FLORIDA, ANNEXING THE WITHIN DESCRIBED TRACT OF LAND LOCATED AT 228 16th AVENUE SOUTHWEST, PINELLAS COUNTY, FLORIDA, AND CONTIGUOUS TO THE EXISTING CITY LIMITS OF THE CITY OF LARGO, FLORIDA; WITH CITY LAND USE DESIGNATION OF RESIDENTIAL LOW; REDEFINING THE CORPORATE BOUNDARY OF THE CITY OF LARGO TO INCLUDE SAID ADDITION, ACCORDING TO THE PROVISIONS OF CHAPTER 171, FLORIDA STATUTES; PROVIDING FOR SEVERABILITY; AND PROVIDING FOR AN EFFECTIVE DATE.

ORDINANCE NO. 2014 - 95

AN ORDINANCE OF THE CITY OF LARGO, FLORIDA, ANNEXING THE WITHIN DESCRIBED TRACT OF LAND LOCATED AT 330 16TH AVENUE SOUTHWEST, PINELLAS COUNTY, FLORIDA, AND CONTIGUOUS TO THE EXISTING CITY LIMITS OF THE CITY OF LARGO, FLORIDA; WITH CITY LAND USE DESIGNATION OF RESIDENTIAL LOW; REDEFINING THE CORPORATE BOUNDARY OF THE CITY OF LARGO TO INCLUDE SAID ADDITION, ACCORDING TO THE PROVISIONS OF CHAPTER 171, FLORIDA STATUTES; PROVIDING FOR SEVERABILITY; AND PROVIDING FOR AN EFFECTIVE DATE.

ORDINANCE NO. 2014 - 96

AN ORDINANCE OF THE CITY OF LARGO, FLORIDA, ANNEXING THE WITHIN DESCRIBED TRACTS OF LAND LOCATED AT 14501 117TH AVENUE AND 14498 117TH AVENUE, PINELLAS COUNTY, FLORIDA, AND CONTIGUOUS TO THE EXISTING CITY LIMITS OF THE CITY OF LARGO, FLORIDA; WITH CITY LAND USE DESIGNATION OF RESIDENTIAL LOW; REDEFINING THE CORPORATE BOUNDARY OF THE CITY OF LARGO TO INCLUDE SAID ADDITION, ACCORDING TO THE PROVISIONS OF CHAPTER 171, FLORIDA STATUTES; PROVIDING FOR SEVERABILITY; AND PROVIDING FOR AN EFFECTIVE DATE.

ORDINANCE NO. 2014 - 97

AN ORDINANCE OF THE CITY OF LARGO, FLORIDA, ANNEXING THE WITHIN DESCRIBED TRACT OF LAND LOCATED AT 11540 OAKHURST ROAD, PINELLAS COUNTY, FLORIDA, AND CONTIGUOUS TO THE EXISTING CITY LIMITS OF THE CITY OF LARGO, FLORIDA; WITH CITY LAND USE DESIGNATION OF COMMERCIAL GENERAL; REDEFINING THE CORPORATE BOUNDARY OF THE CITY OF LARGO TO INCLUDE SAID ADDITION, ACCORDING TO THE PROVISIONS OF CHAPTER 171, FLORIDA STATUTES; PROVIDING FOR SEVERABILITY; AND PROVIDING FOR AN EFFECTIVE DATE.

ORDINANCE NO. 2014 - 98

AN ORDINANCE OF THE CITY OF LARGO, FLORIDA, ANNEXING THE WITHIN DESCRIBED TRACT OF LAND LOCATED AT 12706 OAK STREET, PINELLAS COUNTY, FLORIDA, AND CONTIGUOUS TO THE EXISTING CITY LIMITS OF THE CITY OF LARGO, FLORIDA; WITH CITY LAND USE DESIGNATION OF RESIDENTIAL LOW; REDEFINING THE CORPORATE BOUNDARY OF THE CITY OF LARGO TO INCLUDE SAID ADDITION, ACCORDING TO THE PROVISIONS OF CHAPTER 171, FLORIDA STATUTES; PROVIDING FOR SEVERABILITY; AND PROVIDING FOR AN EFFECTIVE DATE.

ORDINANCE NO. 2014 - 99

AN ORDINANCE OF THE CITY OF LARGO, FLORIDA, ANNEXING THE WITHIN DESCRIBED TRACT OF LAND LOCATED AT 1139 18TH AVENUE SOUTHWEST, PINELLAS COUNTY, FLORIDA, AND CONTIGUOUS TO THE EXISTING CITY LIMITS OF THE CITY OF LARGO, FLORIDA; WITH CITY LAND USE DESIGNATION OF RESIDENTIAL LOW; REDEFINING THE CORPORATE BOUNDARY OF THE CITY OF LARGO TO INCLUDE SAID ADDITION, ACCORDING TO THE PROVISIONS OF CHAPTER 171, FLORIDA STATUTES; PROVIDING FOR SEVERABILITY; AND PROVIDING FOR AN EFFECTIVE DATE.

ORDINANCE NO. 2014 - 100

AN ORDINANCE OF THE CITY OF LARGO, FLORIDA, ANNEXING THE WITHIN DESCRIBED TRACT OF LAND LOCATED AT 1656 10TH STREET SOUTHWEST, PINELLAS COUNTY, FLORIDA, AND CONTIGUOUS TO THE EXISTING CITY LIMITS OF THE CITY OF LARGO, FLORIDA; WITH CITY LAND USE DESIGNATION OF RESIDENTIAL LOW; REDEFINING THE CORPORATE BOUNDARY OF THE CITY OF LARGO TO INCLUDE SAID ADDITION, ACCORDING TO THE PROVISIONS OF CHAPTER 171, FLORIDA STATUTES; PROVIDING FOR SEVERABILITY; AND PROVIDING FOR AN EFFECTIVE DATE.

ORDINANCE NO. 2014 - 101

AN ORDINANCE OF THE CITY OF LARGO, FLORIDA, ANNEXING THE WITHIN DESCRIBED TRACT OF LAND LOCATED AT 1745 10TH STREET SOUTHWEST, PINELLAS COUNTY, FLORIDA, AND CONTIGUOUS TO THE EXISTING CITY LIMITS OF THE CITY OF LARGO, FLORIDA; WITH CITY LAND USE DESIGNATION OF RESIDENTIAL LOW; REDEFINING THE CORPORATE BOUNDARY OF THE CITY OF LARGO TO INCLUDE SAID ADDITION, ACCORDING TO THE PROVISIONS OF CHAPTER 171, FLORIDA STATUTES; PROVIDING FOR SEVERABILITY; AND PROVIDING FOR AN EFFECTIVE DATE.

ORDINANCE NO. 2014 - 102

AN ORDINANCE OF THE CITY OF LARGO, FLORIDA, ANNEXING THE WITHIN DESCRIBED TRACTS OF LAND LOCATED SOUTH OF DRYER AVENUE, WEST OF THE PINELLAS TRAIL, NORTH OF GOODING CROSSING AND EAST OF 119TH STREET, PINELLAS COUNTY, FLORIDA, AND CONTIGUOUS TO THE EXISTING CITY LIMITS OF THE CITY OF LARGO, FLORIDA; WITH CITY LAND USE DESIGNATION OF RESIDENTIAL LOW; REDEFINING THE CORPORATE BOUNDARY OF THE CITY OF LARGO TO INCLUDE SAID ADDITION, ACCORDING TO THE PROVISIONS OF CHAPTER 171, FLORIDA STATUTES; PROVIDING FOR SEVERABILITY; AND PROVIDING FOR AN EFFECTIVE DATE.

ORDINANCE NO. 2014 - 103

AN ORDINANCE OF THE CITY OF LARGO, FLORIDA, ANNEXING THE WITHIN DESCRIBED TRACTS OF LAND LOCATED AT 1742 12TH STREET SOUTHWEST, AND 1764 12TH STREET SOUTHWEST, PINELLAS COUNTY, FLORIDA, AND CONTIGUOUS TO THE EXISTING CITY LIMITS OF THE CITY OF LARGO, FLORIDA; WITH CITY LAND USE DESIGNATION OF RESIDENTIAL LOW; REDEFINING THE CORPORATE BOUNDARY OF THE CITY OF LARGO TO INCLUDE SAID ADDITION, ACCORDING TO THE PROVISIONS OF CHAPTER 171, FLORIDA STATUTES; PROVIDING FOR SEVERABILITY; AND PROVIDING FOR AN EFFECTIVE DATE.

ORDINANCE NO. 2014 - 104

AN ORDINANCE OF THE CITY OF LARGO, FLORIDA, ANNEXING THE WITHIN DESCRIBED TRACTS OF LAND LOCATED AT 1650 12TH STREET SOUTHWEST, 1649 12TH STREET SOUTHWEST, 1296 JACKS LANE, AND 1671 12TH STREET SOUTHWEST, PINELLAS COUNTY, FLORIDA, AND CONTIGUOUS TO THE EXISTING CITY LIMITS OF THE CITY OF LARGO, FLORIDA; WITH CITY LAND USE DESIGNATION OF RESIDENTIAL LOW; REDEFINING THE CORPORATE BOUNDARY OF THE CITY OF LARGO TO INCLUDE SAID ADDITION, ACCORDING TO THE PROVISIONS OF CHAPTER 171, FLORIDA STATUTES; PROVIDING FOR SEVERABILITY; AND PROVIDING FOR AN EFFECTIVE DATE.

ORDINANCE NO. 2014 - 105

AN ORDINANCE OF THE CITY OF LARGO, FLORIDA, ANNEXING THE WITHIN DESCRIBED TRACT OF LAND LOCATED AT 11450 124TH TERRACE, PINELLAS COUNTY, FLORIDA, AND CONTIGUOUS TO THE EXISTING CITY LIMITS OF THE CITY OF LARGO, FLORIDA; WITH CITY LAND USE DESIGNATION OF RESIDENTIAL LOW; REDEFINING THE CORPORATE BOUNDARY OF THE CITY OF LARGO TO INCLUDE SAID ADDITION, ACCORDING TO THE PROVISIONS OF CHAPTER 171, FLORIDA STATUTES; PROVIDING FOR SEVERABILITY; AND PROVIDING FOR AN EFFECTIVE DATE.

ORDINANCE NO. 2014 - 106

AN ORDINANCE OF THE CITY OF LARGO, FLORIDA, ANNEXING THE WITHIN DESCRIBED TRACT OF LAND LOCATED AT 11396 124TH TERRACE, PINELLAS COUNTY, FLORIDA, AND CONTIGUOUS TO THE EXISTING CITY LIMITS OF THE CITY OF LARGO, FLORIDA; WITH CITY LAND USE DESIGNATION OF RESIDENTIAL LOW; REDEFINING THE CORPORATE BOUNDARY OF THE CITY OF LARGO TO INCLUDE SAID ADDITION, ACCORDING TO THE PROVISIONS OF CHAPTER 171, FLORIDA STATUTES; PROVIDING FOR SEVERABILITY; AND PROVIDING FOR AN EFFECTIVE DATE.

ORDINANCE NO. 2014 - 107

AN ORDINANCE OF THE CITY OF LARGO, FLORIDA, ANNEXING THE WITHIN DESCRIBED TRACTS OF LAND LOCATED AT 12372 113TH STREET, 11301 123RD TERRACE AND 11316 123RD TERRACE, PINELLAS COUNTY, FLORIDA, AND CONTIGUOUS TO THE EXISTING CITY LIMITS OF THE CITY OF LARGO, FLORIDA; WITH CITY LAND USE DESIGNATION OF RESIDENTIAL LOW; REDEFINING THE CORPORATE BOUNDARY OF THE CITY OF LARGO TO INCLUDE SAID ADDITION, ACCORDING TO THE PROVISIONS OF CHAPTER 171, FLORIDA STATUTES; PROVIDING FOR SEVERABILITY; AND PROVIDING FOR AN EFFECTIVE DATE.

ORDINANCE NO. 2014 -108

AN ORDINANCE OF THE CITY OF LARGO, FLORIDA, ANNEXING THE WITHIN DESCRIBED TRACTS OF LAND LOCATED AT 2096 18TH AVENUE SOUTHWEST AND TWO VACANT PARCELS TO THE SOUTH ON 19TH AVENUE SOUTHWEST, AND 2138 19TH AVENUE SOUTHWEST, PINELLAS COUNTY, FLORIDA, AND CONTIGUOUS TO THE EXISTING CITY LIMITS OF THE CITY OF LARGO, FLORIDA; WITH CITY LAND USE DESIGNATION OF RESIDENTIAL URBAN; REDEFINING THE CORPORATE BOUNDARY OF THE CITY OF LARGO TO INCLUDE SAID ADDITION, ACCORDING TO THE PROVISIONS OF CHAPTER 171, FLORIDA STATUTES; PROVIDING FOR SEVERABILITY; AND PROVIDING FOR AN EFFECTIVE DATE.

ORDINANCE NO. 2014 - 109

AN ORDINANCE OF THE CITY OF LARGO, FLORIDA, ANNEXING THE WITHIN DESCRIBED TRACT OF LAND LOCATED AT 13215 WASHINGTON AVENUE, PINELLAS COUNTY, FLORIDA, AND CONTIGUOUS TO THE EXISTING CITY LIMITS OF THE CITY OF LARGO, FLORIDA; WITH CITY LAND USE DESIGNATION OF RESIDENTIAL LOW; REDEFINING THE CORPORATE BOUNDARY OF THE CITY OF LARGO TO INCLUDE SAID ADDITION, ACCORDING TO THE PROVISIONS OF CHAPTER 171, FLORIDA STATUTES; PROVIDING FOR SEVERABILITY; AND PROVIDING FOR AN EFFECTIVE DATE.

ORDINANCE NO. 2014 - 110

AN ORDINANCE OF THE CITY OF LARGO, FLORIDA, ANNEXING THE WITHIN DESCRIBED TRACT OF LAND LOCATED AT 12217 104TH LANE, PINELLAS COUNTY, FLORIDA, AND CONTIGUOUS TO THE EXISTING CITY LIMITS OF THE CITY OF LARGO, FLORIDA; WITH CITY LAND USE DESIGNATION OF RESIDENTIAL LOW; REDEFINING THE CORPORATE BOUNDARY OF THE CITY OF LARGO TO INCLUDE SAID ADDITION, ACCORDING TO THE PROVISIONS OF CHAPTER 171, FLORIDA STATUTES; PROVIDING FOR SEVERABILITY; AND PROVIDING FOR AN EFFECTIVE DATE.

ORDINANCE NO. 2014 - 111

AN ORDINANCE OF THE CITY OF LARGO, FLORIDA, ANNEXING THE WITHIN DESCRIBED TRACTS OF LAND LOCATED EAST OF LAKE AVENUE SOUTHEAST, NORTH OF DONEGAN ROAD AND 16TH AVENUE SOUTHEAST AND SOUTH OF 16TH AVENUE SOUTHEAST, PINELLAS COUNTY, FLORIDA, AND CONTIGUOUS TO THE EXISTING CITY LIMITS OF THE CITY OF LARGO, FLORIDA; WITH CITY LAND USE DESIGNATION OF TRANSPORTATION/UTILITIES; REDEFINING THE CORPORATE BOUNDARY OF THE CITY OF LARGO TO INCLUDE SAID ADDITION, ACCORDING TO THE PROVISIONS OF CHAPTER 171, FLORIDA STATUTES; PROVIDING FOR SEVERABILITY; AND PROVIDING FOR AN EFFECTIVE DATE.

ORDINANCE NO. 2014 - 112

AN ORDINANCE OF THE CITY OF LARGO, FLORIDA, ANNEXING THE WITHIN DESCRIBED TRACT OF LAND LOCATED AT 14901 NEWPORT ROAD, PINELLAS COUNTY, FLORIDA, AND CONTIGUOUS TO THE EXISTING CITY LIMITS OF THE CITY OF LARGO, FLORIDA; WITH CITY LAND USE DESIGNATION OF RESIDENTIAL LOW; REDEFINING THE CORPORATE BOUNDARY OF THE CITY OF LARGO TO INCLUDE SAID ADDITION, ACCORDING TO THE PROVISIONS OF CHAPTER 171, FLORIDA STATUTES; PROVIDING FOR SEVERABILITY; AND PROVIDING FOR AN EFFECTIVE DATE.

ORDINANCE NO. 2014 - 113

AN ORDINANCE OF THE CITY OF LARGO, FLORIDA, ANNEXING THE WITHIN DESCRIBED TRACT OF LAND LOCATED AT 13654 AUDREY LANE, PINELLAS COUNTY, FLORIDA, AND CONTIGUOUS TO THE EXISTING CITY LIMITS OF THE CITY OF LARGO, FLORIDA; WITH CITY LAND USE DESIGNATION OF RESIDENTIAL URBAN; REDEFINING THE CORPORATE BOUNDARY OF THE CITY OF LARGO TO INCLUDE SAID ADDITION, ACCORDING TO THE PROVISIONS OF CHAPTER 171, FLORIDA STATUTES; PROVIDING FOR SEVERABILITY; AND PROVIDING FOR AN EFFECTIVE DATE.

ORDINANCE NO. 2014 - 114

AN ORDINANCE OF THE CITY OF LARGO, FLORIDA, ANNEXING THE WITHIN DESCRIBED TRACT OF LAND LOCATED AT 14977 NEWPORT ROAD, PINELLAS COUNTY, FLORIDA, AND CONTIGUOUS TO THE EXISTING CITY LIMITS OF THE CITY OF LARGO, FLORIDA; WITH CITY LAND USE DESIGNATION OF RESIDENTIAL LOW; REDEFINING THE CORPORATE BOUNDARY OF THE CITY OF LARGO TO INCLUDE SAID ADDITION, ACCORDING TO THE PROVISIONS OF CHAPTER 171, FLORIDA STATUTES; PROVIDING FOR SEVERABILITY; AND PROVIDING FOR AN EFFECTIVE DATE.

ORDINANCE NO. 2014 - 115

AN ORDINANCE OF THE CITY OF LARGO, FLORIDA, ANNEXING THE WITHIN DESCRIBED TRACT OF LAND LOCATED AT 14973 NEWPORT ROAD PINELLAS COUNTY, FLORIDA, AND CONTIGUOUS TO THE EXISTING CITY LIMITS OF THE CITY OF LARGO, FLORIDA; WITH CITY LAND USE DESIGNATION OF RESIDENTIAL LOW; REDEFINING THE CORPORATE BOUNDARY OF THE CITY OF LARGO TO INCLUDE SAID ADDITION, ACCORDING TO THE PROVISIONS OF CHAPTER 171, FLORIDA STATUTES; PROVIDING FOR SEVERABILITY; AND PROVIDING FOR AN EFFECTIVE DATE.

ORDINANCE NO. 2014 - 116

AN ORDINANCE OF THE CITY OF LARGO, FLORIDA, ANNEXING THE WITHIN DESCRIBED TRACT OF LAND LOCATED AT 7355 DANBURY WAY, PINELLAS COUNTY, FLORIDA, AND CONTIGUOUS TO THE EXISTING CITY LIMITS OF THE CITY OF LARGO, FLORIDA; WITH CITY LAND USE DESIGNATION OF RESIDENTIAL LOW; REDEFINING THE CORPORATE BOUNDARY OF THE CITY OF LARGO TO INCLUDE SAID ADDITION, ACCORDING TO THE PROVISIONS OF CHAPTER 171, FLORIDA STATUTES; PROVIDING FOR SEVERABILITY; AND PROVIDING FOR AN EFFECTIVE DATE.

ORDINANCE NO. 2014 - 117

AN ORDINANCE OF THE CITY OF LARGO, FLORIDA, ANNEXING THE WITHIN DESCRIBED TRACT OF LAND LOCATED AT 2282 BARBARA DRIVE, PINELLAS COUNTY, FLORIDA, AND CONTIGUOUS TO THE EXISTING CITY LIMITS OF THE CITY OF LARGO, FLORIDA; WITH CITY LAND USE DESIGNATION OF RESIDENTIAL LOW; REDEFINING THE CORPORATE BOUNDARY OF THE CITY OF LARGO TO INCLUDE SAID ADDITION, ACCORDING TO THE PROVISIONS OF CHAPTER 171, FLORIDA STATUTES; PROVIDING FOR SEVERABILITY; AND PROVIDING FOR AN EFFECTIVE DATE.

ORDINANCE NO. 2014 - 118

AN ORDINANCE OF THE CITY OF LARGO, FLORIDA, ANNEXING THE WITHIN DESCRIBED TRACT OF LAND LOCATED AT 2269 BEVERLY LANE, PINELLAS COUNTY, FLORIDA, AND CONTIGUOUS TO THE EXISTING CITY LIMITS OF THE CITY OF LARGO, FLORIDA; WITH CITY LAND USE DESIGNATION OF RESIDENTIAL LOW; REDEFINING THE CORPORATE BOUNDARY OF THE CITY OF LARGO TO INCLUDE SAID ADDITION, ACCORDING TO THE PROVISIONS OF CHAPTER 171, FLORIDA STATUTES; PROVIDING FOR SEVERABILITY; AND PROVIDING FOR AN EFFECTIVE DATE.

ORDINANCE NO. 2014 - 119

AN ORDINANCE OF THE CITY OF LARGO, FLORIDA, ANNEXING THE WITHIN DESCRIBED TRACTS OF LAND LOCATED AT 1767 DONCASTER ROAD, AND 1761 DONCASTER ROAD, PINELLAS COUNTY, FLORIDA, AND CONTIGUOUS TO THE EXISTING CITY LIMITS OF THE CITY OF LARGO, FLORIDA; WITH CITY LAND USE DESIGNATION OF RESIDENTIAL LOW; REDEFINING THE CORPORATE BOUNDARY OF THE CITY OF LARGO TO INCLUDE SAID ADDITION, ACCORDING TO THE PROVISIONS OF CHAPTER 171, FLORIDA STATUTES; PROVIDING FOR SEVERABILITY; AND PROVIDING FOR AN EFFECTIVE DATE.

ORDINANCE NO. 2014 - 120

AN ORDINANCE OF THE CITY OF LARGO, FLORIDA, ANNEXING THE WITHIN DESCRIBED TRACT OF LAND LOCATED AT 1786 DORCHESTER ROAD, PINELLAS COUNTY, FLORIDA, AND CONTIGUOUS TO THE EXISTING CITY LIMITS OF THE CITY OF LARGO, FLORIDA; WITH CITY LAND USE DESIGNATION OF RESIDENTIAL LOW; REDEFINING THE CORPORATE BOUNDARY OF THE CITY OF LARGO TO INCLUDE SAID ADDITION, ACCORDING TO THE PROVISIONS OF CHAPTER 171, FLORIDA STATUTES; PROVIDING FOR SEVERABILITY; AND PROVIDING FOR AN EFFECTIVE DATE.

ORDINANCE NO. 2014 - 121

AN ORDINANCE OF THE CITY OF LARGO, FLORIDA, ANNEXING THE WITHIN DESCRIBED TRACT OF LAND LOCATED AT 2131 EUCLID CIRCLE EAST, PINELLAS COUNTY, FLORIDA, AND CONTIGUOUS TO THE EXISTING CITY LIMITS OF THE CITY OF LARGO, FLORIDA; WITH CITY LAND USE DESIGNATION OF RESIDENTIAL LOW; REDEFINING THE CORPORATE BOUNDARY OF THE CITY OF LARGO TO INCLUDE SAID ADDITION, ACCORDING TO THE PROVISIONS OF CHAPTER 171, FLORIDA STATUTES; PROVIDING FOR SEVERABILITY; AND PROVIDING FOR AN EFFECTIVE DATE.

ORDINANCE NO. 2014 - 122

AN ORDINANCE OF THE CITY OF LARGO, FLORIDA, ANNEXING THE WITHIN DESCRIBED TRACT OF LAND LOCATED AT 1194 SOUSA DRIVE, PINELLAS COUNTY, FLORIDA, AND CONTIGUOUS TO THE EXISTING CITY LIMITS OF THE CITY OF LARGO, FLORIDA; WITH CITY LAND USE DESIGNATION OF RESIDENTIAL LOW; REDEFINING THE CORPORATE BOUNDARY OF THE CITY OF LARGO TO INCLUDE SAID ADDITION, ACCORDING TO THE PROVISIONS OF CHAPTER 171, FLORIDA STATUTES; PROVIDING FOR SEVERABILITY; AND PROVIDING FOR AN EFFECTIVE DATE.

ORDINANCE NO. 2014 - 123

AN ORDINANCE OF THE CITY OF LARGO, FLORIDA, ANNEXING THE WITHIN DESCRIBED TRACT OF LAND LOCATED AT 1125 PORTER DRIVE, PINELLAS COUNTY, FLORIDA, AND CONTIGUOUS TO THE EXISTING CITY LIMITS OF THE CITY OF LARGO, FLORIDA; WITH CITY LAND USE DESIGNATION OF RESIDENTIAL LOW; REDEFINING THE CORPORATE BOUNDARY OF THE CITY OF LARGO TO INCLUDE SAID ADDITION, ACCORDING TO THE PROVISIONS OF CHAPTER 171, FLORIDA STATUTES; PROVIDING FOR SEVERABILITY; AND PROVIDING FOR AN EFFECTIVE DATE.

ORDINANCE NO. 2014 - 125

AN ORDINANCE OF THE CITY OF LARGO, FLORIDA, ANNEXING THE WITHIN DESCRIBED TRACT OF LAND LOCATED AT 886 PORTER DRIVE, PINELLAS COUNTY, FLORIDA, AND CONTIGUOUS TO THE EXISTING CITY LIMITS OF THE CITY OF LARGO, FLORIDA; WITH CITY LAND USE DESIGNATION OF RESIDENTIAL LOW; REDEFINING THE CORPORATE BOUNDARY OF THE CITY OF LARGO TO INCLUDE SAID ADDITION, ACCORDING TO THE PROVISIONS OF CHAPTER 171, FLORIDA STATUTES; PROVIDING FOR SEVERABILITY; AND PROVIDING FOR AN EFFECTIVE DATE.

ORDINANCE NO. 2014 - 126

AN ORDINANCE OF THE CITY OF LARGO, FLORIDA, ANNEXING THE WITHIN DESCRIBED TRACT OF LAND LOCATED AT 964 PORTER DRIVE, PINELLAS COUNTY, FLORIDA, AND CONTIGUOUS TO THE EXISTING CITY LIMITS OF THE CITY OF LARGO, FLORIDA; WITH CITY LAND USE DESIGNATION OF RESIDENTIAL LOW; REDEFINING THE CORPORATE BOUNDARY OF THE CITY OF LARGO TO INCLUDE SAID ADDITION, ACCORDING TO THE PROVISIONS OF CHAPTER 171, FLORIDA STATUTES; PROVIDING FOR SEVERABILITY; AND PROVIDING FOR AN EFFECTIVE DATE.

ORDINANCE NO. 2014 - 127

AN ORDINANCE OF THE CITY OF LARGO, FLORIDA, ANNEXING THE WITHIN DESCRIBED TRACT OF LAND LOCATED AT 1016 PORTER DRIVE, PINELLAS COUNTY, FLORIDA, AND CONTIGUOUS TO THE EXISTING CITY LIMITS OF THE CITY OF LARGO, FLORIDA; WITH CITY LAND USE DESIGNATION OF RESIDENTIAL LOW; REDEFINING THE CORPORATE BOUNDARY OF THE CITY OF LARGO TO INCLUDE SAID ADDITION, ACCORDING TO THE PROVISIONS OF CHAPTER 171, FLORIDA STATUTES; PROVIDING FOR SEVERABILITY; AND PROVIDING FOR AN EFFECTIVE DATE.

ORDINANCE NO. 2014 - 128

AN ORDINANCE OF THE CITY OF LARGO, FLORIDA, ANNEXING THE WITHIN DESCRIBED TRACT OF LAND LOCATED AT 202 MELODY LANE, PINELLAS COUNTY, FLORIDA, AND CONTIGUOUS TO THE EXISTING CITY LIMITS OF THE CITY OF LARGO, FLORIDA; WITH CITY LAND USE DESIGNATION OF RESIDENTIAL LOW; REDEFINING THE CORPORATE BOUNDARY OF THE CITY OF LARGO TO INCLUDE SAID ADDITION, ACCORDING TO THE PROVISIONS OF CHAPTER 171, FLORIDA STATUTES; PROVIDING FOR SEVERABILITY; AND PROVIDING FOR AN EFFECTIVE DATE.

ORDINANCE NO. 2014 - 129

AN ORDINANCE OF THE CITY OF LARGO, FLORIDA, ANNEXING THE WITHIN DESCRIBED TRACT OF LAND LOCATED AT 210 MELODY LANE, PINELLAS COUNTY, FLORIDA, AND CONTIGUOUS TO THE EXISTING CITY LIMITS OF THE CITY OF LARGO, FLORIDA; WITH CITY LAND USE DESIGNATION OF RESIDENTIAL LOW; REDEFINING THE CORPORATE BOUNDARY OF THE CITY OF LARGO TO INCLUDE SAID ADDITION, ACCORDING TO THE PROVISIONS OF CHAPTER 171, FLORIDA STATUTES; PROVIDING FOR SEVERABILITY; AND PROVIDING FOR AN EFFECTIVE DATE.

ORDINANCE NO. 2014 - 130

AN ORDINANCE OF THE CITY OF LARGO, FLORIDA, ANNEXING THE WITHIN DESCRIBED TRACT OF LAND LOCATED AT 3596 FLORAL DRIVE, PINELLAS COUNTY, FLORIDA, AND CONTIGUOUS TO THE EXISTING CITY LIMITS OF THE CITY OF LARGO, FLORIDA; WITH CITY LAND USE DESIGNATION OF RESIDENTIAL LOW; REDEFINING THE CORPORATE BOUNDARY OF THE CITY OF LARGO TO INCLUDE SAID ADDITION, ACCORDING TO THE PROVISIONS OF CHAPTER 171, FLORIDA STATUTES; PROVIDING FOR SEVERABILITY; AND PROVIDING FOR AN EFFECTIVE DATE.

ORDINANCE NO. 2014 - 131

AN ORDINANCE OF THE CITY OF LARGO, FLORIDA, ANNEXING THE WITHIN DESCRIBED TRACT OF LAND LOCATED AT 238 MELODY LANE, PINELLAS COUNTY, FLORIDA, AND CONTIGUOUS TO THE EXISTING CITY LIMITS OF THE CITY OF LARGO, FLORIDA; WITH CITY LAND USE DESIGNATION OF RESIDENTIAL LOW; REDEFINING THE CORPORATE BOUNDARY OF THE CITY OF LARGO TO INCLUDE SAID ADDITION, ACCORDING TO THE PROVISIONS OF CHAPTER 171, FLORIDA STATUTES; PROVIDING FOR SEVERABILITY; AND PROVIDING FOR AN EFFECTIVE DATE.

ORDINANCE NO. 2014 - 132

AN ORDINANCE OF THE CITY OF LARGO, FLORIDA, ANNEXING THE WITHIN DESCRIBED TRACT OF LAND LOCATED AT 2096 VALENCIA WAY, PINELLAS COUNTY, FLORIDA, AND CONTIGUOUS TO THE EXISTING CITY LIMITS OF THE CITY OF LARGO, FLORIDA; WITH CITY LAND USE DESIGNATION OF RESIDENTIAL LOW; REDEFINING THE CORPORATE BOUNDARY OF THE CITY OF LARGO TO INCLUDE SAID ADDITION, ACCORDING TO THE PROVISIONS OF CHAPTER 171, FLORIDA STATUTES; PROVIDING FOR SEVERABILITY; AND PROVIDING FOR AN EFFECTIVE DATE.

ORDINANCE NO. 2014 - 133

AN ORDINANCE OF THE CITY OF LARGO, FLORIDA, ANNEXING THE WITHIN DESCRIBED TRACTS OF LAND LOCATED NORTH OF 138TH AVENUE, SOUTH OF 141ST AVENUE, WEST OF CORAL WAY AND WEST OF PALM WAY, PINELLAS COUNTY, FLORIDA, AND CONTIGUOUS TO THE EXISTING CITY LIMITS OF THE CITY OF LARGO, FLORIDA; WITH CITY LAND USE DESIGNATION OF TRANSPORTATION/UTILITIES; REDEFINING THE CORPORATE BOUNDARY OF THE CITY OF LARGO TO INCLUDE SAID ADDITION, ACCORDING TO THE PROVISIONS OF CHAPTER 171, FLORIDA STATUTES; PROVIDING FOR SEVERABILITY; AND PROVIDING FOR AN EFFECTIVE DATE.

ORDINANCE NO. 2014 - 134

AN ORDINANCE OF THE CITY OF LARGO, FLORIDA, ANNEXING THE WITHIN DESCRIBED TRACTS OF LAND LOCATED AT 8033 ULMERTON ROAD AND 8051 ULMERTON ROAD, PINELLAS COUNTY, FLORIDA, AND CONTIGUOUS TO THE EXISTING CITY LIMITS OF THE CITY OF LARGO, FLORIDA; WITH CITY LAND USE DESIGNATION OF COMMERCIAL GENERAL; REDEFINING THE CORPORATE BOUNDARY OF THE CITY OF LARGO TO INCLUDE SAID ADDITION, ACCORDING TO THE PROVISIONS OF CHAPTER 171, FLORIDA STATUTES; PROVIDING FOR SEVERABILITY; AND PROVIDING FOR AN EFFECTIVE DATE.

ORDINANCE NO. 2014 - 135

AN ORDINANCE OF THE CITY OF LARGO, FLORIDA, ANNEXING THE WITHIN DESCRIBED TRACTS OF LAND LOCATED AT 1601 PALM WAY AND 1615 PALM WAY, PINELLAS COUNTY, FLORIDA, AND CONTIGUOUS TO THE EXISTING CITY LIMITS OF THE CITY OF LARGO, FLORIDA; WITH CITY LAND USE DESIGNATION OF RESIDENTIAL LOW MEDIUM; REDEFINING THE CORPORATE BOUNDARY OF THE CITY OF LARGO TO INCLUDE SAID ADDITION, ACCORDING TO THE PROVISIONS OF CHAPTER 171, FLORIDA STATUTES; PROVIDING FOR SEVERABILITY; AND PROVIDING FOR AN EFFECTIVE DATE.

ORDINANCE NO. 2014 - 136

AN ORDINANCE OF THE CITY OF LARGO, FLORIDA, ANNEXING THE WITHIN DESCRIBED TRACTS OF LAND LOCATED AT 1657 PALM WAY AND 1660 CORAL WAY, PINELLAS COUNTY, FLORIDA, AND CONTIGUOUS TO THE EXISTING CITY LIMITS OF THE CITY OF LARGO, FLORIDA; WITH CITY LAND USE DESIGNATION OF RESIDENTIAL LOW MEDIUM; REDEFINING THE CORPORATE BOUNDARY OF THE CITY OF LARGO TO INCLUDE SAID ADDITION, ACCORDING TO THE PROVISIONS OF CHAPTER 171, FLORIDA STATUTES; PROVIDING FOR SEVERABILITY; AND PROVIDING FOR AN EFFECTIVE DATE.

ORDINANCE NO. 2014 - 137

AN ORDINANCE OF THE CITY OF LARGO, FLORIDA, ANNEXING THE WITHIN DESCRIBED TRACT OF LAND LOCATED AT 3766 139TH AVENUE NORTH, PINELLAS COUNTY, FLORIDA, AND CONTIGUOUS TO THE EXISTING CITY LIMITS OF THE CITY OF LARGO, FLORIDA; WITH CITY LAND USE DESIGNATION OF RESIDENTIAL LOW MEDIUM; REDEFINING THE CORPORATE BOUNDARY OF THE CITY OF LARGO TO INCLUDE SAID ADDITION, ACCORDING TO THE PROVISIONS OF CHAPTER 171, FLORIDA STATUTES; PROVIDING FOR SEVERABILITY; AND PROVIDING FOR AN EFFECTIVE DATE.

ORDINANCE NO. 2014 - 138

AN ORDINANCE OF THE CITY OF LARGO, FLORIDA, ANNEXING THE WITHIN DESCRIBED TRACT OF LAND LOCATED AT 1925 PALM WAY AND 1840 CORAL WAY AND 1798 CORAL WAY, PINELLAS COUNTY, FLORIDA, AND CONTIGUOUS TO THE EXISTING CITY LIMITS OF THE CITY OF LARGO, FLORIDA; WITH CITY LAND USE DESIGNATION OF RESIDENTIAL LOW MEDIUM; REDEFINING THE CORPORATE BOUNDARY OF THE CITY OF LARGO TO INCLUDE SAID ADDITION, ACCORDING TO THE PROVISIONS OF CHAPTER 171, FLORIDA STATUTES; PROVIDING FOR SEVERABILITY; AND PROVIDING FOR AN EFFECTIVE DATE.

ORDINANCE NO. 2014 - 139

AN ORDINANCE OF THE CITY OF LARGO, FLORIDA, ANNEXING THE WITHIN DESCRIBED TRACT OF LAND LOCATED AT 3793 135TH AVENUE NORTH, PINELLAS COUNTY, FLORIDA, AND CONTIGUOUS TO THE EXISTING CITY LIMITS OF THE CITY OF LARGO, FLORIDA; WITH CITY LAND USE DESIGNATION OF RESIDENTIAL LOW MEDIUM; REDEFINING THE CORPORATE BOUNDARY OF THE CITY OF LARGO TO INCLUDE SAID ADDITION, ACCORDING TO THE PROVISIONS OF CHAPTER 171, FLORIDA STATUTES; PROVIDING FOR SEVERABILITY; AND PROVIDING FOR AN EFFECTIVE DATE.

ORDINANCE NO. 2014 - 140

AN ORDINANCE OF THE CITY OF LARGO, FLORIDA, ANNEXING THE WITHIN DESCRIBED TRACT OF LAND LOCATED AT 13166 CUMBERLAND DRIVE, PINELLAS COUNTY, FLORIDA, AND CONTIGUOUS TO THE EXISTING CITY LIMITS OF THE CITY OF LARGO, FLORIDA; WITH CITY LAND USE DESIGNATION OF RESIDENTIAL LOW; REDEFINING THE CORPORATE BOUNDARY OF THE CITY OF LARGO TO INCLUDE SAID ADDITION, ACCORDING TO THE PROVISIONS OF CHAPTER 171, FLORIDA STATUTES; PROVIDING FOR SEVERABILITY; AND PROVIDING FOR AN EFFECTIVE DATE.

ORDINANCE NO. 2014 - 141

AN ORDINANCE OF THE CITY OF LARGO, FLORIDA, ANNEXING THE WITHIN DESCRIBED TRACT OF LAND LOCATED AT 8033 ABERDEEN CIRCLE, PINELLAS COUNTY, FLORIDA, AND CONTIGUOUS TO THE EXISTING CITY LIMITS OF THE CITY OF LARGO, FLORIDA; WITH CITY LAND USE DESIGNATION OF RESIDENTIAL LOW; REDEFINING THE CORPORATE BOUNDARY OF THE CITY OF LARGO TO INCLUDE SAID ADDITION, ACCORDING TO THE PROVISIONS OF CHAPTER 171, FLORIDA STATUTES; PROVIDING FOR SEVERABILITY; AND PROVIDING FOR AN EFFECTIVE DATE.

ORDINANCE NO. 2014 - 142

AN ORDINANCE OF THE CITY OF LARGO, FLORIDA, ANNEXING THE WITHIN DESCRIBED TRACT OF LAND LOCATED AT 12785 CUMBERLAND DRIVE, PINELLAS COUNTY, FLORIDA, AND CONTIGUOUS TO THE EXISTING CITY LIMITS OF THE CITY OF LARGO, FLORIDA; WITH CITY LAND USE DESIGNATION OF RESIDENTIAL LOW; REDEFINING THE CORPORATE BOUNDARY OF THE CITY OF LARGO TO INCLUDE SAID ADDITION, ACCORDING TO THE PROVISIONS OF CHAPTER 171, FLORIDA STATUTES; PROVIDING FOR SEVERABILITY; AND PROVIDING FOR AN EFFECTIVE DATE.

ORDINANCE NO. 2014 - 144

AN ORDINANCE OF THE CITY OF LARGO, FLORIDA, ANNEXING THE WITHIN DESCRIBED TRACT OF LAND LOCATED AT 12809 WILD ACRES ROAD, PINELLAS COUNTY, FLORIDA, AND CONTIGUOUS TO THE EXISTING CITY LIMITS OF THE CITY OF LARGO, FLORIDA; WITH CITY LAND USE DESIGNATION OF RESIDENTIAL LOW; REDEFINING THE CORPORATE BOUNDARY OF THE CITY OF LARGO TO INCLUDE SAID ADDITION, ACCORDING TO THE PROVISIONS OF CHAPTER 171, FLORIDA STATUTES; PROVIDING FOR SEVERABILITY; AND PROVIDING FOR AN EFFECTIVE DATE.

ORDINANCE NO. 2014 - 144

AN ORDINANCE OF THE CITY OF LARGO, FLORIDA, ANNEXING THE WITHIN DESCRIBED TRACT OF LAND LOCATED AT 14782 MOCKINGBIRD LANE WEST, PINELLAS COUNTY, FLORIDA, AND CONTIGUOUS TO THE EXISTING CITY LIMITS OF THE CITY OF LARGO, FLORIDA; WITH CITY LAND USE DESIGNATION OF RESIDENTIAL LOW; REDEFINING THE CORPORATE BOUNDARY OF THE CITY OF LARGO TO INCLUDE SAID ADDITION, ACCORDING TO THE PROVISIONS OF CHAPTER 171, FLORIDA STATUTES; PROVIDING FOR SEVERABILITY; AND PROVIDING FOR AN EFFECTIVE DATE.

The City Commission may, with respect to any matter considered at this meeting, make a determination on the matter that evening or may continue the meeting wholly or in part to another date. If the public hearing is continued by the City Commission, no further notice of continuance will be sent or published. Interested parties may appear at the meeting and be heard with respect to the proposed ordinances. Copies of the ordinances, complete metes and bounds legal descriptions, and related materials are available for public inspection at either the Community Development Department or the City Clerk's Office, City Hall, 201 Highland Avenue, Largo, Florida, during regular business hours (8:00 am - 5:00 pm), at the Largo Public Library, 120 Central Park Drive or on the City's website at www.largo.com. For further information, call 727-587-6749. Any person who decides to appeal any decision of the City Commission with respect to any matter considered at this meeting will need a record of the proceedings and for such purpose may need to ensure that a verbatim record of the proceedings is made, which record shall include the testimony and evidence upon which the appeal is to be based. The City of Largo is committed to providing reasonable accommodation for access for the disabled. Anyone needing assistance with regard to this meeting should contact the City Clerk's office at 587-6710 or the Library T.D.D. Line 587-6778 at least two days prior to the meeting.

Diane L. Bruner, CMC
City Clerk

To be published in the *Tampa Bay Times*, *Neighborhood Times* Section, **NOT IN THE CLASSIFIED SECTION**, on **Friday July 25, 2014 and on Friday, August 1, 2014.**

Dated: July 9, 2014

- DO NOT REDUCE HEADING

THE ADVERTISEMENT MUST INCLUDE ATTACHED MAPS

Please provide one affidavit with the invoice to the City Clerk.

1. Ordinance No. 2014-74
2. Ordinance No. 2014-75
3. Ordinance No. 2014-76
4. Ordinance No. 2014-77
5. Ordinance No. 2014-78
6. Ordinance No. 2014-79
7. Ordinance No. 2014-80
8. Ordinance No. 2014-81
9. Ordinance No. 2014-82
10. Ordinance No. 2014-83
11. Ordinance No. 2014-84

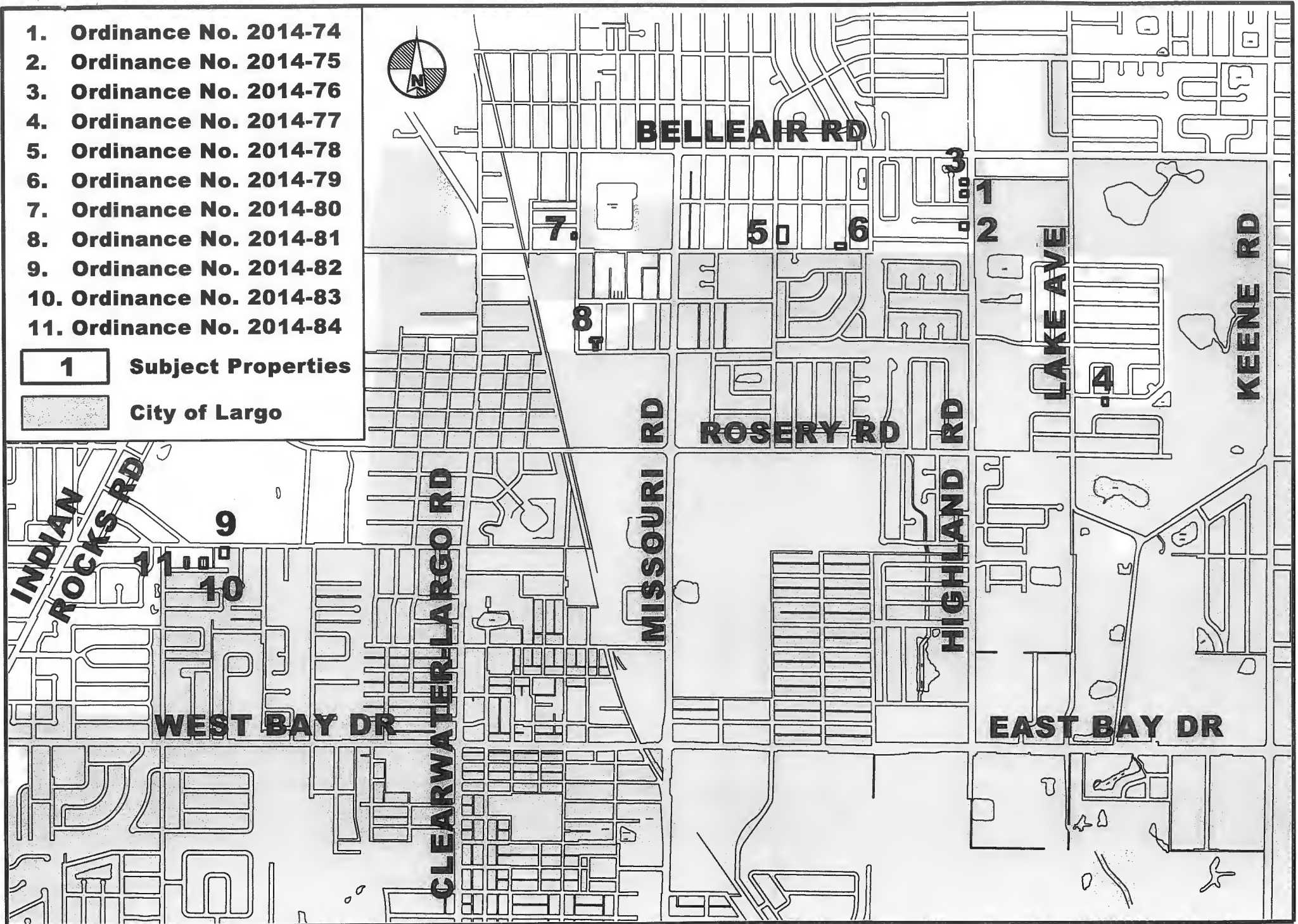
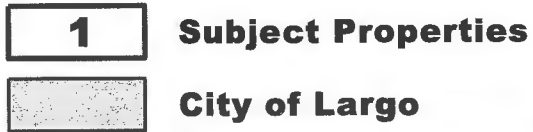

1. Ordinance No. 2014-86
2. Ordinance No. 2014-87
3. Ordinance No. 2014-88
4. Ordinance No. 2014-89
5. Ordinance No. 2014-90
6. Ordinance No. 2014-91
7. Ordinance No. 2014-92
8. Ordinance No. 2014-93
9. Ordinance No. 2014-94
10. Ordinance No. 2014-95
11. Ordinance No. 2014-96
12. Ordinance No. 2014-97
13. Ordinance No. 2014-98
14. Ordinance No. 2014-99
15. Ordinance No. 2014-100
16. Ordinance No. 2014-101
17. Ordinance No. 2014-102
18. Ordinance No. 2014-103
19. Ordinance No. 2014-104
20. Ordinance No. 2014-105
21. Ordinance No. 2014-106
22. Ordinance No. 2014-107
23. Ordinance No. 2014-108
24. Ordinance No. 2014-110

1 Subject Properties

 City of Largo

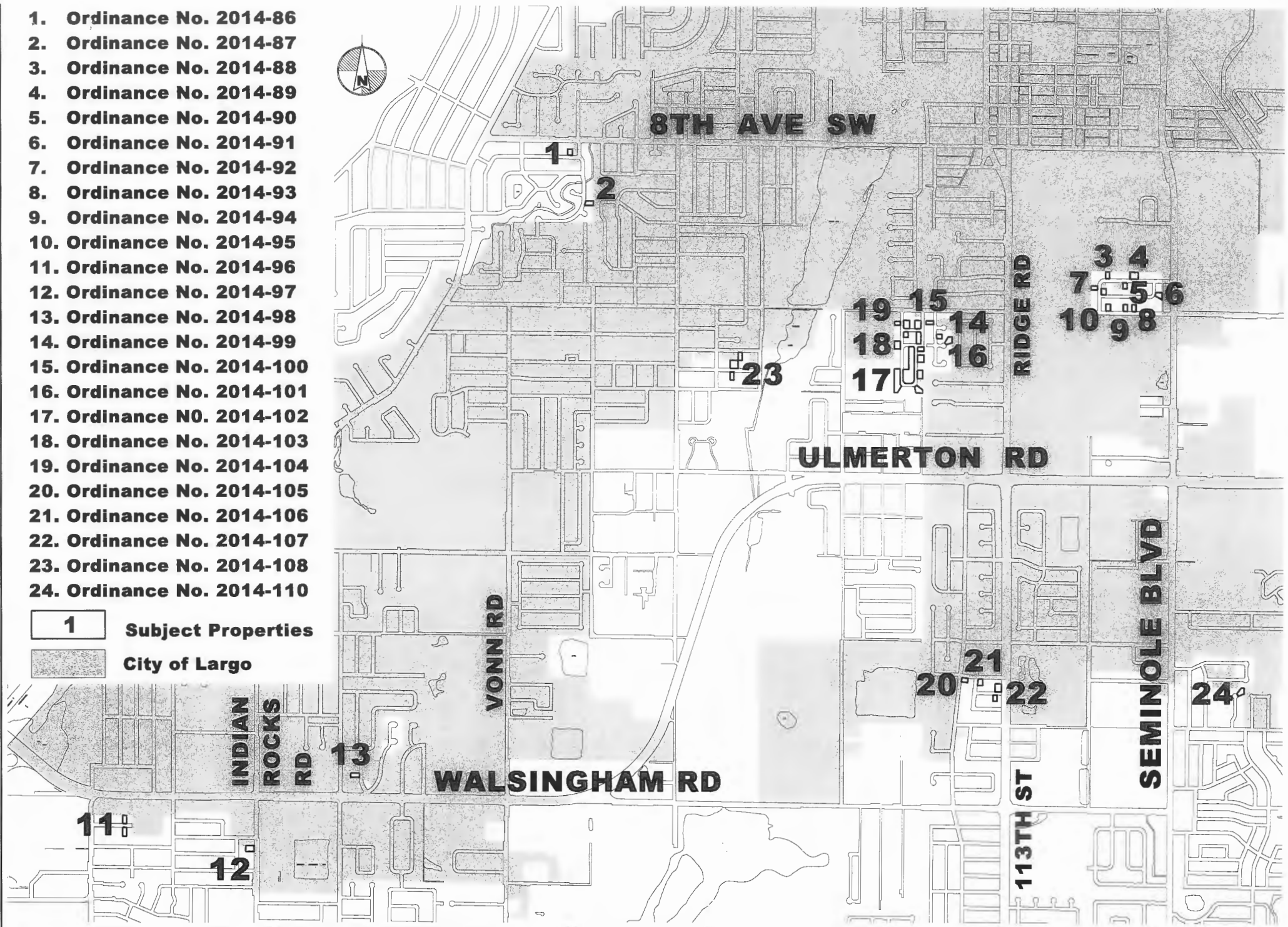

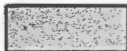
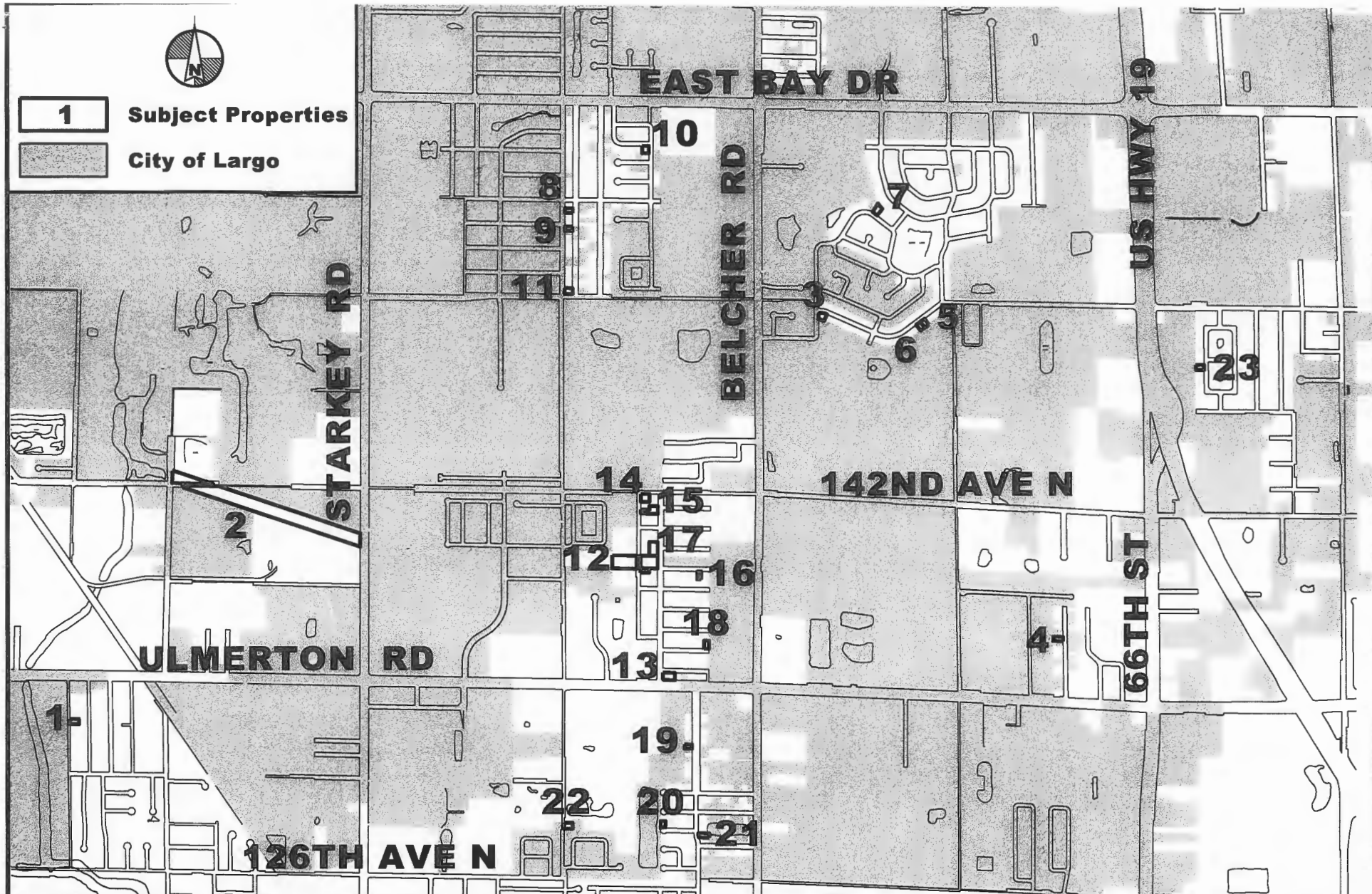
**1****Subject Properties****City of Largo**

- | | | | |
|---------------------------|----------------------------|----------------------------|----------------------------|
| 1. Ordinance No. 2014-109 | 7. Ordinance No. 2014-116 | 13. Ordinance No. 2014-134 | 19. Ordinance No. 2014-140 |
| 2. Ordinance No. 2014-111 | 8. Ordinance No. 2014-128 | 14. Ordinance No. 2014-135 | 20. Ordinance No. 2014-141 |
| 3. Ordinance No. 2014-112 | 9. Ordinance No. 2014-129 | 15. Ordinance No. 2014-136 | 21. Ordinance No. 2014-142 |
| 4. Ordinance No. 2014-113 | 10. Ordinance No. 2014-130 | 16. Ordinance No. 2014-137 | 22. Ordinance No. 2014-143 |
| 5. Ordinance No. 2014-114 | 11. Ordinance No. 2014-131 | 17. Ordinance No. 2014-138 | 23. Ordinance No. 2014-144 |
| 6. Ordinance No. 2014-115 | 12. Ordinance No. 2014-133 | 18. Ordinance No. 2014-139 | |