

4. MISCELLANEOUS ITEMS TO BE RECEIVED FOR FILING:

- a. City of Clearwater Public Hearing Notices of Corrected Meeting Dates for Annexation, Land Use Plan, and Zoning Atlas amendments regarding proposed Ordinances Nos. 8558-14 through 8560-14 and 8564-14 through 8566-14, together with Notices of Intent to Consider a Development Agreement regarding proposed Resolutions Nos. 14-14 and 14-19; public hearings held June 4, 2014.
- b. City of Clearwater Ordinances Nos. 8541-14 and 8544-14 adopted April 3, 2014, annexing certain properties.
- c. City of Oldsmar Ordinance No 2014-05 adopted May 20, 2014, annexing certain property.
- d. City of Pinellas Park Notice of Public Hearing to be held June 26, 2014, regarding proposed Ordinance No. 3886 voluntarily annexing certain property.
- e. Tierra Verde Community Association, Inc. Resolution No. 2014-03 adopted May 12, 2014, regarding the County providing extra manpower for the Tierra Verde Fire Station.
- f. Eastlake Oaks Community Development District minutes of the meetings held December 12, 2013 and February 13, 2014.

If a copy of a report or CD is desired, please check the web page of the organization/municipality or contact Board Records at 464-3465.



City of Oldsmar

To provide leadership, innovation, environmental stewardship and excellent services in partnership with the community

100 State Street West ~ Oldsmar, FL 34677-3655 ~ (813) 749-1100 ~ Fax (813) 891-9152

May 22, 2014

Mr. Mark Woodard
Pinellas County Administrator
315 Court Street
Clearwater, FL 33756

RECEIVED
BOARD OF
2014 MAY 27 AM 8:48
BOARD OF COUNTY
COMMISSIONERS
PINELLAS COUNTY FLORIDA

Dear Mr. Woodard:

Pursuant to the provisions of Section 171.044 Florida Statutes, enclosed you will find a certified copy of the ordinance the City of Oldsmar passed to annex certain real property into the corporate limits of the city.

If you have any questions regarding the enclosure, I can be reached at (813) 749-1115 or astephan@myoldsmar.com.

Sincerely,

Ann E. Stephan, CMC
City Clerk
City of Oldsmar, FL

Enclosure: Ordinance 2014-05 – Parcel 22-28-16-96660-001-0030, Oldsmar, FL 34677
Parcel 22-28-16-96660-009-0180, Oldsmar, FL 34677

ORDINANCE 2014-05

AN ORDINANCE DECLARING THE INTENTION OF THE CITY OF OLDSMAR, FLORIDA TO ANNEX CERTAIN REAL PROPERTIES LOCATED IN SECTION 22, TOWNSHIP 28 SOUTH, RANGE 16 EAST, FURTHER DESCRIBED AS 0 SHORE BOULEVARD (PARCEL NUMBER 22-28-16-96660-001-0030) AND 0 PHOENIX AVENUE (PARCEL NUMBER 22-28-16-96660-009-0180) INTO THE CORPORATE LIMITS OF THE CITY OF OLDSMAR AND PROVIDING FOR THE EFFECTIVE DATE OF THIS ORDINANCE.

WHEREAS, pursuant to the provisions of the Florida Statutes, the City of Oldsmar may lawfully annex land lying contiguous to the boundaries of the City upon written petition of the property owner thereof; and

WHEREAS, the City of Oldsmar has received a written petition of the property owner of the following described properties and has received proper proof of title setting forth the names of all persons, firms or corporations owning any interest in said properties; and

WHEREAS, said properties are reasonably compact and are contiguous to the City of Oldsmar, lying in an unincorporated area; now, therefore,

BE IT ORDAINED BY THE CITY COUNCIL OF THE CITY OF OLDSMAR, FLORIDA, IN SESSION DULY AND REGULARLY ASSEMBLED:

Section 1: The City of Oldsmar, acting by and through its City Council hereby declares its intention to annex into the corporate limits of the City Oldsmar the following properties lying contiguous to the territorial limits of said City:

SEE ATTACHED EXHIBITS "A" and "B"

Maps clearly showing the annexed areas are attached hereto as Exhibits "C" and "D" and incorporated herein by reference.

Section 2: Upon final passage and adoption, a certified copy of this Ordinance shall be duly recorded in the Office of the Circuit Court of Pinellas County and filed with the Department of State, State of Florida and the County Administrator of Pinellas County, Florida.

Section 3: When this Ordinance has been duly recorded and filed as aforesaid, the territories hereinabove described shall be thereupon annexed to

the City of Oldsmar and the inhabitants thereof shall enjoy all the privileges and be subject to all liabilities as are applicable to the other lands and inhabitants within the corporate limits and subject to all laws and ordinances of the City of Oldsmar.

Section 4: This Ordinance shall become effective immediately upon its final passage and adoption.

PASSED ON FIRST READING: May 6, 2014

PASSED ON SECOND READING AND ADOPTED: May 20, 2014

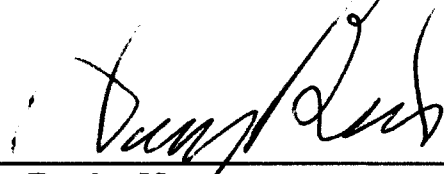

Doug Bevis, Mayor
City of Oldsmar

ATTEST:

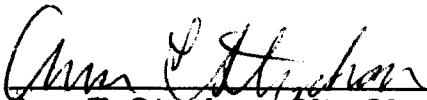

Ann E. Stephan, City Clerk
City of Oldsmar

APPROVED AS TO FORM:

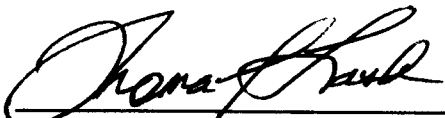

Thomas J. Trask, Esquire
City Attorney
City of Oldsmar

RECEIVED
BOARD OF
2014 MAY 27 AM 8:48
BOARD OF COUNTY
COMMISSIONERS
PINELLAS COUNTY FLORIDA

EXHIBIT "A"

Lot 3, Block 1, SECTION NO. 1 WEST OLDSMAR, according to the map or plat thereof as recorded in Plat Book 9, Page 79, Public Records of Pinellas County, Florida.

EXHIBIT B

Part "A"

That portion of Lots 19 and 20, Block 9, Map of Section No. 1, West Oldsmar, in Section 22, Township 28 South, Range 16 East, as per plat thereof recorded in Plat Book 9, Page 79 of the Public Records of Pinellas County, Florida, being described as follows: Commence at a 4"x4" concrete monument at the Southernmost corner of said Lot 20, said corner being on the Easterly right of way line of Phoenix Avenue; thence along said Easterly right of way line North 44 degrees 17'55" West, 113.12 feet for a Point of Beginning; thence continue North 44 degrees 17'55" West, 14.60 feet to a point on the Southerly right of way line of State Road 580; thence North 44 degrees 46'46" East, along said Southerly right of way line, 73.99 feet; thence North 51 degrees 54'48" East, 120.83 feet along said Southerly right of way line to a point on the Southerly Mean High Water line of Moccasin Creek; thence along said Mean High Water line the following two courses; South 32 degrees 10'36" West, 21.41 feet; South 30 degrees 30'37" East, 1.83 feet; thence 129.63 feet along a non-tangent curve to the left having a delta angle of 02 degrees 38'57", a radius of 2803.79 feet and a chord length of 129.62 feet bearing South 49 degrees 28'17" West; thence South 39 degrees 50'44" West, 43.74 feet to the Point of Beginning.

TOGETHER WITH: Commence at a ½" iron rod at the Westernmost corner of Lot 23, Block 11, Map of Section No. 1, West Oldsmar, in Section 22, Township 28 South, Range 16 East, as per plat thereof recorded in Plat Book 9, Page 79 of the Public Records of Pinellas County, Florida; thence South 45 degrees 09'06" East, 482.72 feet along the Easterly right of way line of Duane Avenue to a point on the Centerline Survey of State Road 580; thence along said Centerline Survey the following three courses: (1) North 44 degrees 46'46" East, 258.36 feet to the beginning of a curve to the right having a delta angle of 07 degrees 07'49", a radius of 2864.79 feet, and a chord length of 356.28 feet bearing North 48 degrees 20'42" East; (2) thence along the arc of said curve 356.51 feet; (3) thence North 51 degrees 54'37" East, 60.07 feet to a point on the Westerly Mean High Water line of Moccasin Creek; thence South 41 degrees 15'08" East, along said Westerly Mean High Water line, 22.79 feet; thence South 11 degrees 51'24" West, along said Westerly Mean High Water line, 14.34 feet to the Southerly existing right of way line of State Road No. 580 for a Point of Beginning; thence continue along said Westerly Mean High Water line the following four (4) courses; (1) South 11 degrees 51'24" West 4.16 feet; (2) South 49 degrees 44'15" West, 38.53 feet; (3) South 54 degrees 19'08" West, 51.09 feet; (4) South 60 degrees 50'39" West, 22.52 feet to the said Southerly existing right of way line; thence along said right of way line the following three (3) courses; (1) North 51 degrees 54'40" East, 14.24 feet; (2) North 53 degrees 37'36" East, 50.41 feet; (3) North 51 degrees 54'37" East, 50.35 feet to the Point of Beginning.

Part "B"

All of Lots 18, 19 and 20, Block 9, Map of Section No. 1, West Oldsmar, in Section 22, Township 28 South, Range 16 East, as per plat thereof recorded in Plat Book 9, Page 79 of the Public Records of Pinellas County, Florida. Lying Southerly and Easterly of the right of way of State Road No. 580.

LESS:

Commence at a 4"x4" concrete monument at the Southernmost corner of said Lot 20, said corner being on the Easterly right of way line of Phoenix Avenue; thence along said Easterly right of way line North 44 degrees 17'55" West, 113.12 feet for a Point of Beginning; thence continue North 44 degrees 17'55" West, 14.60 feet to a point on the Southerly right of way line of State Road 580; thence North 44 degrees 46'46" East, along said Southerly right of way line, 73.99 feet; thence North 51 degrees 54'48" East, 120.83 feet along said Southerly right of way line to a point on the Southerly Mean High Water line of Moccasin Creek; thence along said Mean High Water line the following two courses; South 32 degrees 10'36" West, 21.41 feet; South 30 degrees 30'37" East, 1.83 feet; thence 129.63 feet along a non-tangent curve to the left having a delta angle of 02 degrees 38'57", a radius of 2803.79 feet and a chord length of 129.62 feet bearing South 49 degrees 28'17" West; thence South 39 degrees 50'44" West, 43.74 feet to the Point of Beginning.

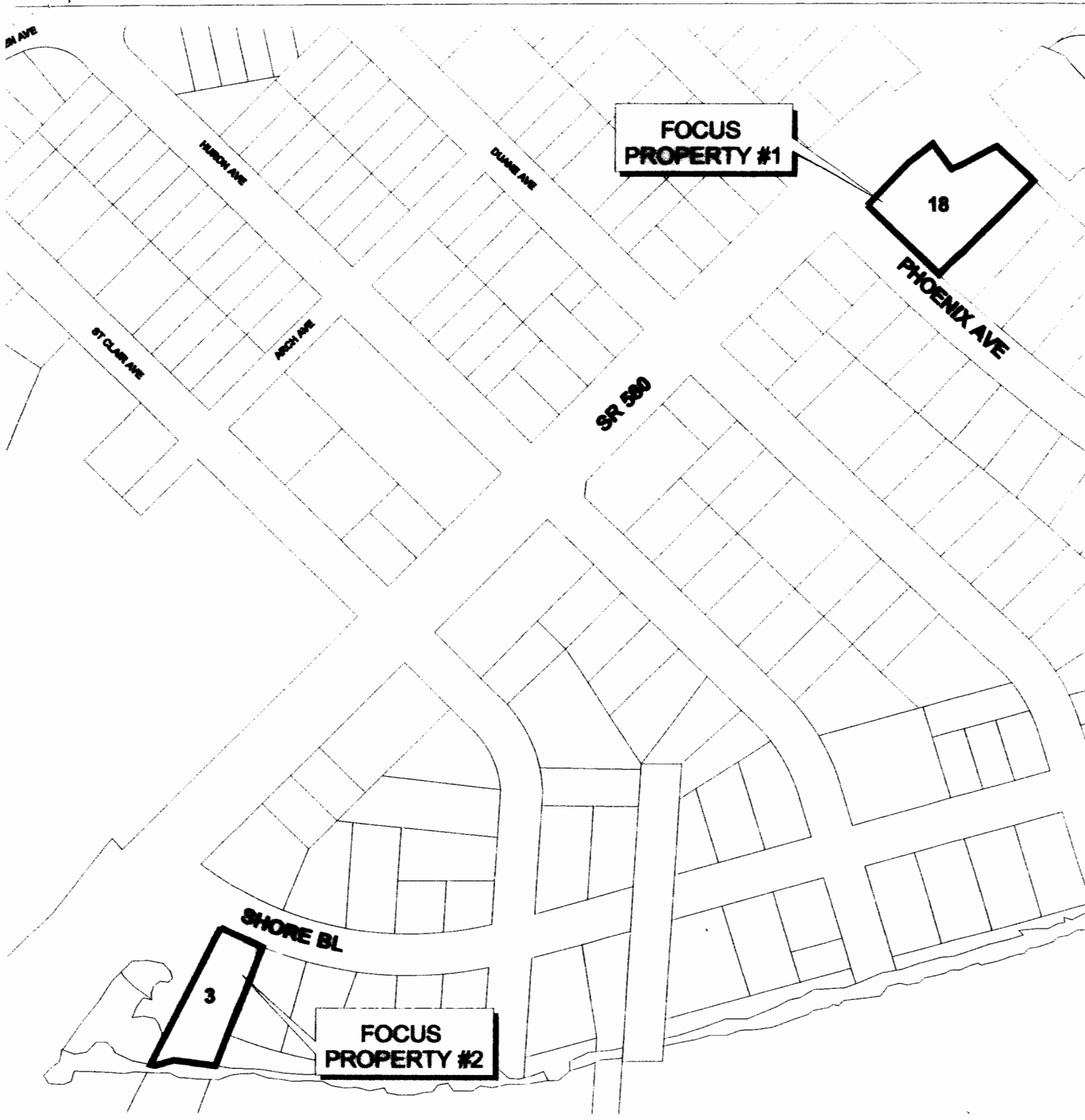

LOCATOR MAP

FOCUS PROPERTY #1
22/28/16/96660/009/0180-0190-0200
OLDSMAR, FL 34677
FOCUS PROPERTY #2
22/28/16/96660/001/0030
OLDSMAR, FL 34677



MARCH 2014