

11. MISCELLANEOUS ITEMS TO BE RECEIVED FOR FILING

- a. City of Largo Notice of Public Hearings re proposed Ordinances Nos. 2013-18 through 2013-24 held December 18, 2012, annexing certain property.
- b. City of Safety Harbor Ordinance No. 2012-17 adopted November 19, 2012, annexing certain property.
- c. City of Pinellas Park Notice of Public Hearing re proposed Ordinance No. 3833 held January 10, 2013, voluntarily annexing certain property.
- d. City of Seminole Notice of Public Hearings re proposed Ordinances Nos. 10-2012 through 12-2012 held January 8, 2013, voluntarily annexing certain property.
- e. Proposed Library Interlocal Agreement re Library Cooperative adopted by the Cities of Pinellas Park, St. Petersburg, Largo, Tarpon Springs, Seminole, Oldsmar, Safety Harbor, and Gulfport and approved in concept by the Cities of St. Pete Beach, Clearwater, and Dunedin.
- f. Correspondence from the Town of Redington Beach re Gulf Boulevard Beautification project allocations.
- g. Public Risk Management of Florida Contract and Bylaws Intergovernmental Cooperative Agreement, as amended and restated through December 12, 2012, for the Towns of Belleair and Kenneth City and the Cities of Gulfport, Safety Harbor, South Pasadena, Indian Rocks Beach, St. Pete Beach, and Treasure Island, together with an Affidavit of Authenticity.
- h. Public Official Bonds, Oaths, and Powers of Attorney for Pinellas Suncoast Fire & Rescue District Commissioners Lawrence G. Schear, Laura T. Martin, and James C. Terry.

If a copy of a report or CD is desired, please check the web page of the organization/municipality or contact Board Records at 464-3465.

110

CITY OF PINELLAS PARK
NOTICE OF PUBLIC HEARING UPON ORDINANCE

Notice is hereby given that the City Council of Pinellas Park, Florida, will hold a **PUBLIC HEARING** upon **ORDINANCE NO 3833** at City Hall, 5141 78th Avenue, Pinellas Park, Florida on the **10th** day of **JANUARY 2013**, at 7:30 P.M., the title of said Ordinance being as follows:

ORDINANCE NO. 3833

AN ORDINANCE ANNEXING INTO THE CITY OF PINELLAS PARK, FLORIDA, A CERTAIN PARCEL OF LAND GENERALLY LOCATED AT 7100 PARK BOULEVARD, LEGALLY DESCRIBED AS ATTACHED HERETO IN EXHIBIT "A" AND MADE A PART HEREOF, LYING WITHIN SECTION 30, TOWNSHIP 30 SOUTH, RANGE 16 EAST, PINELLAS COUNTY, FLORIDA; PROVIDING FOR AMENDMENT OF THE LEGAL DESCRIPTION OF THE CORPORATE BOUNDARIES OF THE CITY OF PINELLAS PARK, FLORIDA; PROVIDING FOR THE ASSIGNMENT OF CITY ZONING CLASSIFICATION; PROVIDING FOR REPEAL OF ORDINANCES OR PARTS OF ORDINANCES CONFLICTING HERewith; PROVIDING FOR AN EFFECTIVE DATE.

(PARK & BELCHER, LLC AX12-23)

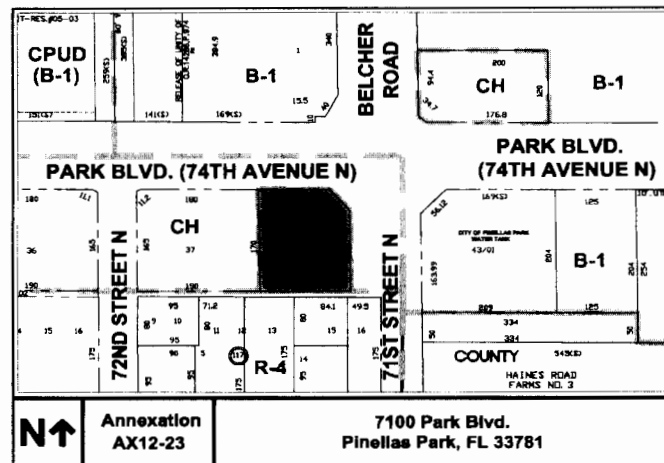

These documents are available for review in the City Clerk's Office. Interested parties are invited to attend this meeting and be heard. If a person decides to appeal any decision made by the board, agency or commission with respect to any matter considered at such meeting or hearing, he or she will need a record of the proceedings and that, for such purpose, he or she may need to ensure that a verbatim record of the proceedings is made, which record includes the testimony and evidence upon which the appeal is to be based. Physically handicapped person who require special assistance or accommodations to attend the hearing should contact the City in writing at least 48 hours in advance to ensure that such accommodations are made available.

DIANE M. CORNA, MMC
CITY CLERK
CITY OF PINELLAS PARK

To be published in the St. Petersburg Times - Neighborhood Times

on the following date(s) Sunday, December 30, 2012 and Sunday January 6, 2012

Date: Tuesday, December 4, 2012

City of
PINELLAS PARK

5141 78TH AVE. • P.O. BOX 1100
PINELLAS PARK, FL 33780-1100



FLORIDA

PHONE • (727) 541-0700
FAX • (727) 544-7448
SUNCOM • 969-1011

November 15, 2012

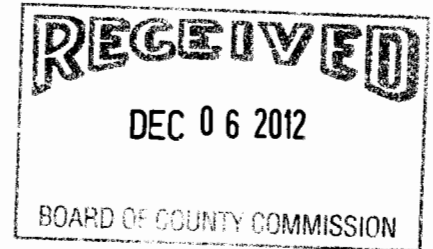

Board of County Commissioners
Pinellas County
315 Court Street
Clearwater, FL 33756

RE: SUBMITTAL OF VOLUNTARY ANNEXATION PETITION TO PINELLAS COUNTY

Please be advised that the City of Pinellas Park is proceeding with the voluntarily annexation of the following property. The first reading of the annexation ordinance will be at the 12/13/2012, City Council Meeting:

Owner:	Park & Belcher, LLC
Address:	7100 Park Blvd.
Parcel:	30/30/16/03816/000/0380
Land Use Map Designation:	County = CG City = CG
Ordinance No. (to be assigned):	First Reading — 12/13/12 Public Hearing — 1/10/13

Copies of the petition, annexation ordinance, legal description, and map are enclosed. Please feel free to contact me personally if further information is required.

Sincerely,

Shannon Coughlin
Economic Development Specialist
City of Pinellas Park, FL
(727) 541-0702

RECEIVED
BOARD OF
2012 DEC -6 AM 11:59
BOARD OF COUNTY
COMMISSIONERS
PINELLAS COUNTY FLORIDA



PRINTED ON RECYCLED PAPER

PETITION FOR ANNEXATION TO THE CITY OF PINELLAS PARK, FLORIDA

The undersigned, being the sole OWNER (*"OWNER" is used herein for singular or plural, the singular shall include the plural, and any gender shall include all genders, as context requires*) of the following described real property located within Pinellas County, Florida, hereby consents and agrees to annexation of such property by the City of Pinellas Park, Florida, and further requests the City of Pinellas Park to forthwith undertake annexation proceedings to annex the said real property:

PARCEL: 30/30/16/03816/000/0380
(Located at 7100 Park Boulevard)

BAYOU FARMS, LOT 38, LESS ROAD RIGHT-OF-WAY

Containing 0.55 acres MOL

The names and addresses of the undersigned representing all of the legal owners of the above-described property are as follows:

Park & Belcher, LLC
8902 N. Dale Mabry Highway, Suite 200
Tampa, FL 33614-1596

OWNER'S SIGNATURE:

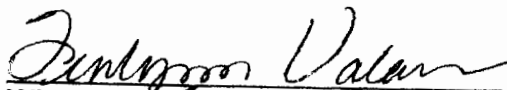
Witness FENLYNN VALDES

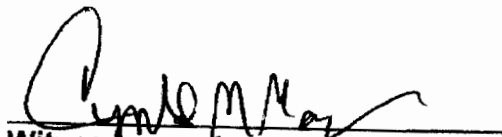

Mark E. Miller, its Vice President
Print name and title

Witness Cynthia M. McGaughan

ORDINANCE NO. _____

AN ORDINANCE ANNEXING INTO THE CITY OF PINELLAS PARK, FLORIDA, A CERTAIN PARCEL OF LAND GENERALLY LOCATED AT 7100 PARK BOULEVARD, LEGALLY DESCRIBED AS ATTACHED HERETO IN EXHIBIT "A" AND MADE A PART HEREOF, LYING WITHIN SECTION 30, TOWNSHIP 30 SOUTH, RANGE 16 EAST, PINELLAS COUNTY, FLORIDA; PROVIDING FOR AMENDMENT OF THE LEGAL DESCRIPTION OF THE CORPORATE BOUNDARIES OF THE CITY OF PINELLAS PARK, FLORIDA; PROVIDING FOR THE ASSIGNMENT OF CITY ZONING CLASSIFICATION; PROVIDING FOR REPEAL OF ORDINANCES OR PARTS OF ORDINANCES CONFLICTING HERewith; PROVIDING FOR AN EFFECTIVE DATE. (PARK & BELCHER, LLC AX12-23)

WHEREAS, the Owner of a certain parcel of land lying in an unincorporated area of Pinellas County, Florida, and contiguous to the City of Pinellas Park have petitioned City Council requesting that said land be annexed into the City of Pinellas Park, Florida; and

WHEREAS, all requirements of Florida Statutes, Chapter 171, pertaining to the voluntary annexation have been complied with.

NOW, THEREFORE, BE IT ORDAINED BY THE MAYOR AND CITY COUNCIL OF THE CITY OF PINELLAS PARK, PINELLAS COUNTY, FLORIDA, AS FOLLOWS:

SECTION ONE: That the land lying in an unincorporated area of Pinellas County, Florida, and contiguous to the City of Pinellas Park, generally located at 7100 Park Boulevard, and legally described as attached hereto in Exhibit "A" and made a part hereof, lying within Section 30, Township 30 South, Range 16 East, Pinellas County, Florida, is hereby annexed into the City of Pinellas Park.

SECTION TWO: That the legal description of the corporate boundaries of the City of Pinellas Park, Florida, is hereby amended to include the land herein annexed. The legal description of the City of Pinellas Park, Florida, contained in the City Charter, and all official City maps and other official documents shall be amended accordingly.

SECTION THREE: That the land herein annexed shall be assigned the City zoning classification of CH which is the closest compatible to the County C-3 zoning on the subject parcel at the time of annexation.

SECTION FOUR: That the City Zoning Map is hereby amended to conform to the provisions of this Ordinance.

SECTION FIVE: That all Ordinances or parts of Ordinances in conflict with the provisions of this Ordinance be, and they are hereby, repealed insofar as the same affects this Ordinance.

SECTION SIX: That this Ordinance shall become effective immediately upon its final passage and adoption.

FIRST READING	_____	DAY OF _____, 2013
PUBLISHED MAP & TITLE	_____	DAY OF _____, 2013
PUBLISHED MAP ONLY	_____	DAY OF _____, 2013
PUBLIC HEARING	_____	DAY OF _____, 2013
PASSED THIS	_____	DAY OF _____, 2013

AYES:
NAYS:
ABSENT:
ABSTAIN:

APPROVED THIS	_____	DAY OF _____, 2013
---------------	-------	--------------------

ATTEST:

SANDRA L. BRADBURY, MAYOR

DIANE M. CORNA, MMC, CITY CLERK

ANNEXATION ORDINANCE LEGAL

Park & Belcher, LLC AX12-23
Parcel: 30/30/16/03816/000/0380
Located at: 7100 Park Boulevard

FROM THE NORTHWEST CORNER OF LOT 38 OF BAYOU FARMS AS RECORDED IN PLAT BOOK 24, PAGE 31, OF THE OFFICIAL PUBLIC RECORDS OF PINELLAS COUNTY, FLORIDA, SAID POINT BEING THE POINT OF BEGINNING, RUN SOUTH 00°33'41" EAST, 170.0 FEET; THENCE SOUTH 89°43'52" EAST, 143.31 FEET TO THE WEST RIGHT-OF-WAY LINE OF 71ST STREET NORTH (ALSO KNOWN AS BELCHER ROAD); THENCE NORTH 00°39'58" WEST ALONG SAID RIGHT-OF-WAY LINE, 129.55 FEET; THENCE NORTH 44°14'18" WEST, 56.72 FEET TO THE SOUTH RIGHT-OF-WAY LINE OF PARK BOULEVARD; THENCE LEAVING THE WEST RIGHT-OF-WAY LINE OF BELCHER ROAD, RUN NORTH 89°43'52" WEST, 103.90 FEET ALONG SAID SOUTH RIGHT-OF-WAY LINE OF PARK BOULEVARD TO THE POINT OF BEGINNING.

A PARCEL CONTAINING 0.54 ACRES M.O.L.



7100 Park Boulevard

AX12-23