

4. MISCELLANEOUS ITEMS TO BE RECEIVED FOR FILING

- a. City of Clearwater Notice of Public Hearings regarding proposed Ordinances Nos. 8365-12 through 8367-12 amending the Annexation, Land Use Plan, and Zoning Atlas; public hearings to be held December 6, 2012.
- b. City of Largo Notice of Public Hearings to be held December 4, 2012, regarding proposed Ordinances Nos. 2013-01 through 2013-11, annexing certain property.
- c. City of Pinellas Park Notice of Public Hearing re proposed Ordinance No. 3830 held November 22, 2012, de-annexing certain property.
- d. City of Safety Harbor Resolution No. 2012-21 adopted October 15, 2012, opposing implementation of Priority Dispatch as proposed by Pinellas County Emergency Medical Services Authority.
- e. Southwest Florida Water Management District Draft Five-Year Water Resource Development Work Program for Fiscal Year 2013.

If a copy of a report or CD is desired, please check the web page of the organization/municipality or contact Board Records at 464-3465.

CITY OF PINELLAS PARK
NOTICE OF PUBLIC HEARING UPON ORDINANCE

Notice is hereby given that the City Council of Pinellas Park, Florida, will hold a **PUBLIC HEARING** upon **ORDINANCE NO 3830** at City Hall, 5141 78th Avenue, Pinellas Park, Florida on the 22nd day of NOVEMBER, 2012, at 7:30 P.M., the title of said Resolution being as follows:

ORDINANCE NO. 3830

AN ORDINANCE DE-ANNEXING OUT OF THE CITY OF PINELLAS PARK, FLORIDA, A CERTAIN PARCELS OF LAND GENERALLY LOCATED AT 126TH AVENUE FROM THE WEST SIDE OF THE CROSS BAYOU CANAL TO THE EAST BOUNDARY OF 5601 126TH AVENUE NORTH, LEGALLY DESCRIBED AS ATTACHED HERETO IN EXHIBIT "A" AND MADE A PART HEREOF, LYING WITHIN SECTIONS 08 AND 09, TOWNSHIP 30 SOUTH, RANGE 16 EAST, PINELLAS COUNTY, FLORIDA, PROVIDING FOR AMENDMENT OF THE LEGAL DESCRIPTION OF THE CORPORATE BOUNDARIES OF THE CITY OF PINELLAS PARK, FLORIDA; PROVIDING FOR THE REASSIGNMENT OF COUNTY ZONING CLASSIFICATION; PROVIDING FOR REPEAL OF ORDINANCES OR PARTS OF ORDINANCES CONFLICTING HERewith; PROVIDING FOR AN EFFECTIVE DATE.
(DAX12-1)

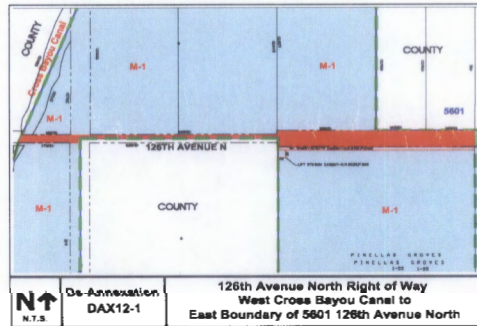

These documents are available for review in the City Clerk's Office. Interested parties are invited to attend this meeting and be heard. If a person decides to appeal any decision made by the board, agency or commission with respect to any matter considered at such meeting or hearing, he or she will need a record of the proceedings and that, for such purpose, he or she may need to ensure that a verbatim record of the proceedings is made, which record includes the testimony and evidence upon which the appeal is to be based. Physically handicapped person who require special assistance or accommodations to attend the hearing should contact the City in writing at least 48 hours in advance to ensure that such accommodations are made available.

DIANE M. CORNA, MMC
CITY CLERK
CITY OF PINELLAS PARK

To be published in the St. Petersburg Times - Neighborhood Times

on the following date(s) Sunday, November 4 & 11, 2012

Date: Tuesday, October 29, 2012

City of

PINELLAS PARK

5141 78TH AVE. • P.O. BOX 1100

PINELLAS PARK, FL 33780-1100

Fire Administration

11350 43rd Street North

Clearwater, FL 33762

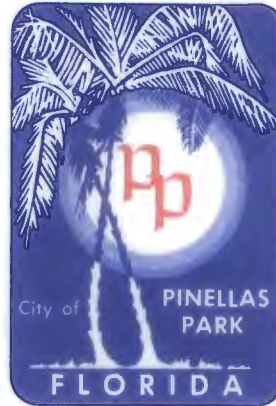

FLORIDA

PHONE • (727) 541-0700

FAX • (727) 544-7448

SUNCOM • 969-1011

October 29, 2012

Board of County Commissioners
Pinellas County
315 Court Street
Clearwater, FL 33756

RE: SUBMITTAL OF DE-ANNEXATION ORDINANCE

Please be advised that the City of Pinellas Park is proceeding with the de-annexation of the following property. The first reading of the de-annexation ordinance will be at the 11/08/2012, City Council Meeting:

Owner: City of Pinellas Park (R-O-W)

Address: 126th Avenue west of the Cross Bayou Canal to the east boundary line of 5601 126th Ave N

Parcel: 08-30-16 & 09-30 16

Land Use Map Designation: County = IL City = IL

Ordinance No. (to be assigned): First Reading — 11/08/12 Public Hearing — 11/08/12

A copy of the de-annexation ordinance, legal description, map, and Public Hearing ad are enclosed. Please feel free to contact me personally if further information is required.

Sincerely,

E. H. Bud Wortendyke
Real Estate Coordinator

RECEIVED
BOARD OF
2012 NOV - 1 PM 4:26
BOARD OF COUNTY
COMMISSIONERS
PINELLAS COUNTY FLORIDA



PRINTED ON RECYCLED PAPER

ORDINANCE NO. _____

AN ORDINANCE DE-ANNEXING OUT OF THE CITY OF PINELLAS PARK, FLORIDA, A CERTAIN PARCELS OF LAND GENERALLY LOCATED AT 126TH AVENUE FROM THE WEST SIDE OF THE CROSS BAYOU CANAL TO THE EAST BOUNDARY OF 5601 126TH AVENUE NORTH, LEGALLY DESCRIBED AS ATTACHED HERETO IN EXHIBIT "A" AND MADE A PART HEREOF, LYING WITHIN SECTIONS 08 AND 09, TOWNSHIP 30 SOUTH, RANGE 16 EAST, PINELLAS COUNTY, FLORIDA; PROVIDING FOR AMENDMENT OF THE LEGAL DESCRIPTION OF THE CORPORATE BOUNDARIES OF THE CITY OF PINELLAS PARK, FLORIDA; PROVIDING FOR THE REASSIGNMENT OF COUNTY ZONING CLASSIFICATION; PROVIDING FOR REPEAL OF ORDINANCES OR PARTS OF ORDINANCES CONFLICTING HERewith; PROVIDING FOR AN EFFECTIVE DATE.

(DAX12-1)

WHEREAS, the Owner of certain parcels of land lying in the unincorporated area of Pinellas County has petitioned City Council requesting that said land be annexed into the City of Pinellas Park, Florida; and

WHEREAS, the annexation of said parcels of land will create enclaves; and

WHEREAS, Pinellas County Ordinance 00-63, Section 6(1)(a) specifically sets forth that a voluntary annexation shall not create an enclave; and

WHEREAS, The City of Pinellas Park, Florida is desirous of complying with the provisions of Pinellas County Ordinance 00-63; and

Whereas certain right-of-way parcels of land lying in an unincorporated area of the City of Pinellas Park, Florida and contiguous to the unincorporated boundaries of Pinellas County may be de-annexed thereby avoiding the creation of any enclave.

NOW, THEREFORE, BE IT ORDAINED BY THE MAYOR AND CITY COUNCIL OF THE CITY OF PINELLAS PARK, PINELLAS COUNTY, FLORIDA, AS FOLLOWS:

SECTION ONE: That the land lying within an incorporated area of the City of Pinellas Park, and contiguous to, the unincorporated boundaries of Pinellas County, and generally located at 126th Avenue from the west side of the Cross Bayou Canal to the east boundary of 5601 126th Avenue North and legally described as attached hereto in Exhibit "A" and made a part hereof, lying within Section 08 and 09, Township 30 South, Range 16 East, Pinellas County, Florida, is hereby de-annexed out of the City of Pinellas Park.

SECTION TWO: That the legal description of the corporate boundaries of the City of Pinellas Park, Florida, is hereby amended to exclude the land herein de-annexed. The legal description of the City of Pinellas Park, Florida, contained in the City Charter, and all official City maps and other official documents shall be amended accordingly.

SECTION THREE: That the land herein de-annexed shall be reassigned the County zoning classification of M-1 which is the closest compatible to the City M-1 zoning on the subject parcel at the time of de-annexation.

SECTION FOUR: That the City Zoning Map is hereby amended to conform to the provisions of this Ordinance.

SECTION FIVE: That all Ordinances or parts of Ordinances in conflict with the provisions of this Ordinance be, and they are hereby, repealed insofar as the same affects this Ordinance.

SECTION SIX: That this Ordinance shall be in full force and effect immediately after its passage and approval in the manner provided by law.

FIRST READING THE	_____	DAY OF _____, 2012
PUBLISHED MAP & TITLE	_____	DAY OF _____, 2012
PUBLISHED MAP ONLY	_____	DAY OF _____, 2012
PUBLIC HEARING THE	_____	DAY OF _____, 2012
PASSED THIS	_____	DAY OF _____, 2011

AYES:
NAYS:
ABSENT:
ABSTAIN:

APPROVED THIS _____ DAY OF _____, 2012

ATTEST:

SANDRA L. BRADBURY, MAYOR

DIANE M. CORNA, MMC, CITY CLERK

DE-ANNEXATION ORDINANCE LEGAL

DAX12-1

126th Avenue Right of Way from the West Bank of Cross Bayou Canal to the East
Boundary Line of 5601 126th Avenue North

THAT PORTION OF 126th AVENUE RIGHT OF WAY LOCATED IN SECTION 9,
TOWNSHIP 30 SOUTH, RANGE 16 EAST, AND SECTION 8, TOWNSHIP 30
SOUTH, RANGE 16 EAST, BEING FURTHER DESCRIBED AS FOLLOWS:

FROM THE SOUTHEAST CORNER OF THE SOUTHWEST $\frac{1}{4}$ OF THE NORTHWEST $\frac{1}{4}$ OF
SECTION 9, TOWNSHIP 30 SOUTH, RANGE 16 EAST, SAID POINT BEING THE POINT OF
BEGINNING, RUN SOUTH 00°02'38" WEST 30.00'; THENCE NORTH 89°57'22" WEST 660.77';
THENCE NORTH 00°00'32" EAST 30.00'; THENCE NORTH 89°57'22" WEST 660.77'; THENCE
SOUTH 00°01'29" WEST 15.00'; THENCE NORTH 89°46'45" WEST 203.85'; THENCE NORTH
17°01'34" EAST 31.34'; THENCE SOUTH 89°46'45" EAST 194.71'; THENCE SOUTH 89°57'22"
EAST 660.77'; THENCE NORTH 00°00'32" EAST 15.00' THENCE SOUTH 89°57'22" EAST
660.77'; THENCE SOUTH 00°02'38" WEST 30.00' TO THE POINT OF BEGINNING.

A PARCEL CONTAINING 1.28 ACRES M.O.L.



08-30-16 & 09-30-16
126TH AVENUE WEST OF THE CROSS BAYOU CANAL
TO THE EAST BOUNDARY OF 5601 126TH AVENUE N

DAX12-1